

PLAN	SURVEYED	DATE
	PLOTTED	BY
	CHECKED	
	RT. OF WAY CHECKED	
	CADD FILE NAME	
	NO.	

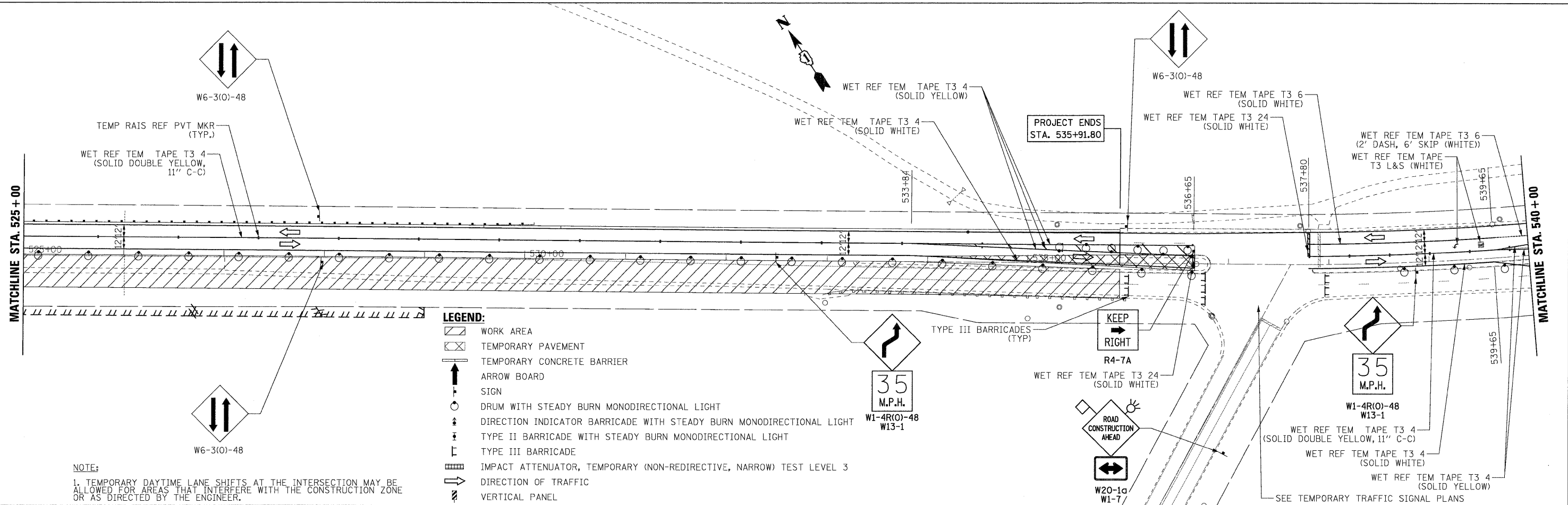

PLAN	SURVEYED	DATE
	PLOTTED	BY
	CHECKED	
	RT. OF WAY CHECKED	
	CADD FILE NAME	
	NO.	

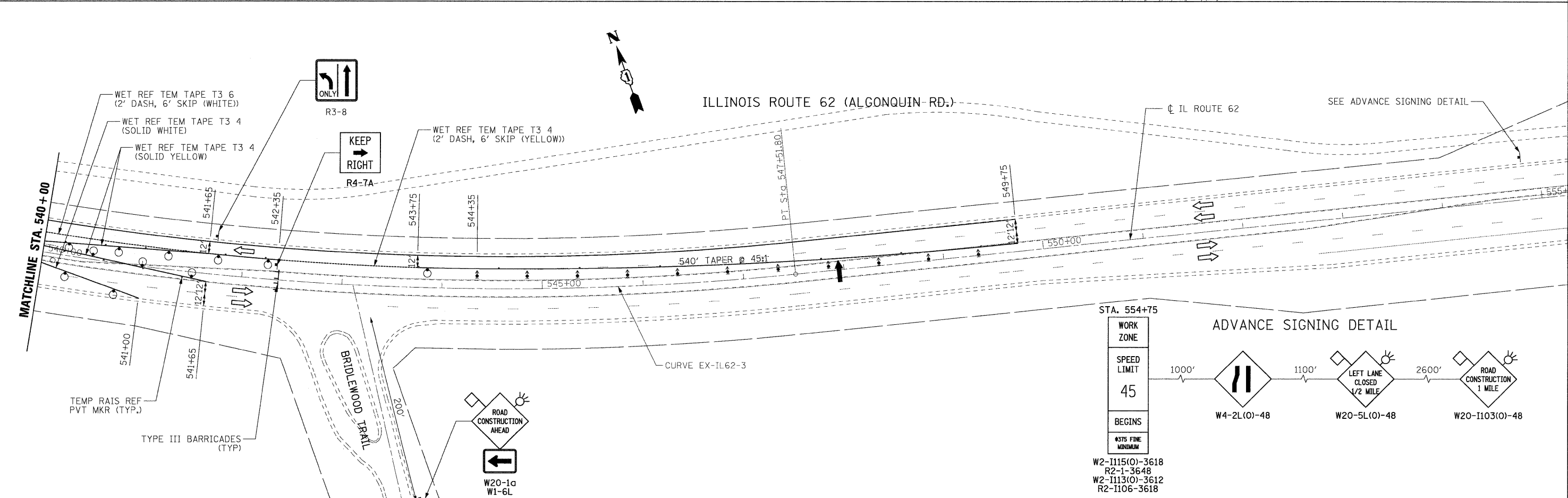

FILE NAME = ...D160135-shr_staging2.B3.dgn



DESIGNED	ADW	REVISED	-
DRAWN	ADW	REVISED	-
CHECKED	RJD	REVISED	-
DATE	JUNE 30, 2011	REVISED	-

STATE OF ILLINOIS
DEPARTMENT OF TRANSPORTATION

IL RTE 62 (ALGONQUIN RD.) FROM EASTING'S WAY TO PENNY RD.
SUGGESTED STAGE OF CONSTRUCTION & TRAFFIC CONTROL - STAGE 2

SCALE: 1"=50' SHEET NO. 6 OF 6 SHEETS STA. 525+00 TO STA. 549+75

F.A.P. RTE.	SECTION	COUNTY	TOTAL SHEETS	SHEET NO.
339	116 Y-1-R-1	COOK	122	24
				CONTRACT NO. 60I35
ILLINOIS FED. AID PROJECT				