

DATE	
BY	
SURVEYED	
ALIGNED	
CHECKED	
NO. _____	
PLAN	
NOTE BOOK	
NO. _____	
FILE NAME	

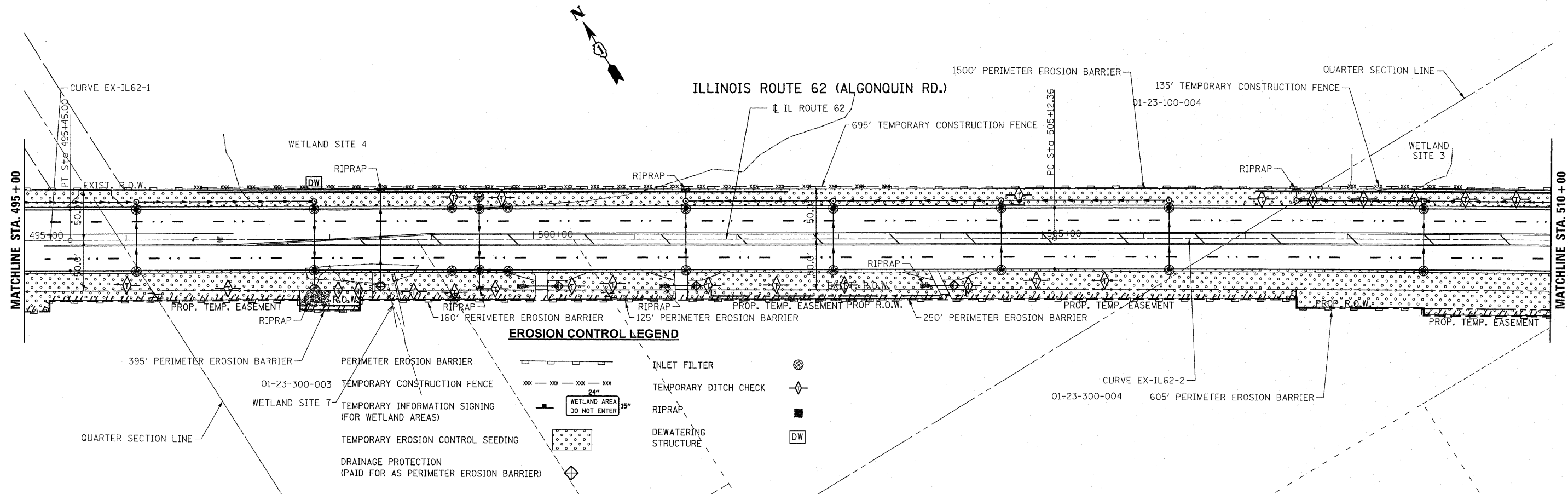

DATE	
BY	
SURVEYED	
ALIGNED	
CHECKED	
NO. _____	
PLAN	
NOTE BOOK	
NO. _____	
FILE NAME	

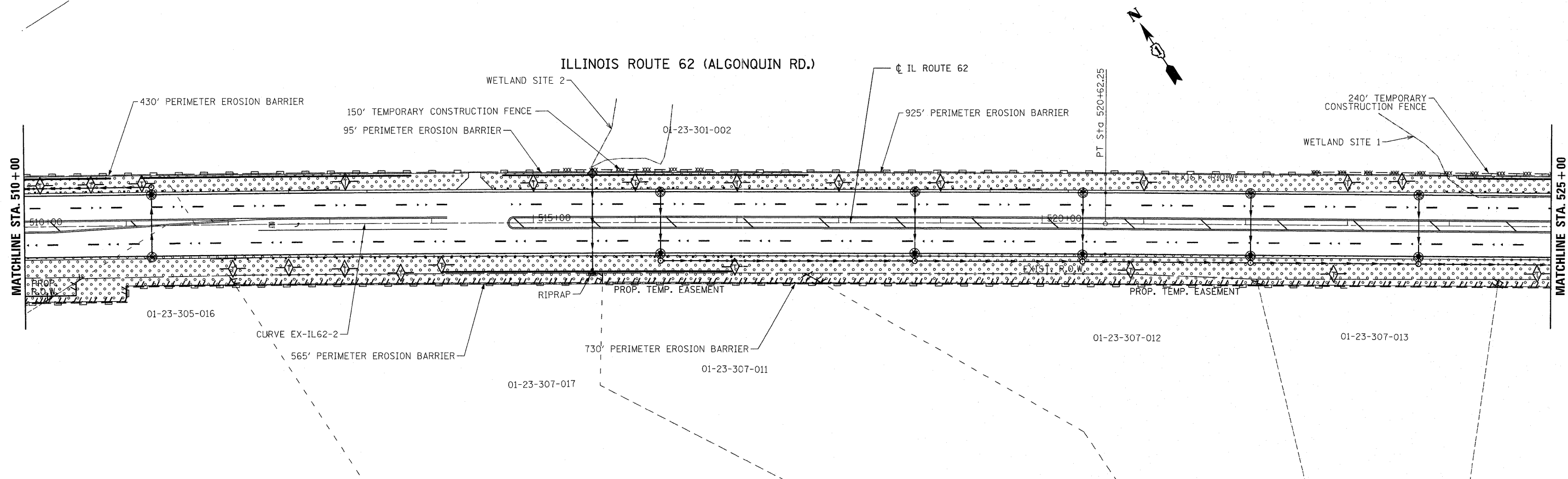

FILE NAME =
...\\D168135-sht-eros_02.dgn



DESIGNED	SEF	REVISED	- 10/21/2011	N.W.S.
DRAWN	SMQ	REVISED	-	
CHECKED	RJD	REVISED	-	
DATE	JUNE 30, 2011	REVISED	-	

STATE OF ILLINOIS
DEPARTMENT OF TRANSPORTATION

IL RTE 62 (ALGONQUIN RD.) FROM EASTING'S WAY TO PENNY RD.
EROSION & SEDIMENT CONTROL PLAN

F.A.P. RTE.	SECTION	COUNTY	TOTAL SHEETS	SHEET NO.
339	116 Y-1-R-1	COOK	122	26
CONTRACT NO. 60135				
ILLINOIS FED. AID PROJECT				

SCALE: 1"=50' SHEET NO. 2 OF 3 SHEETS STA. 495+00 TO STA. 525+00