

FINAL SURVEY	DATE
SURVEYED	BY
NOTE BOOK	
TEMPLATE	
AREAS	
CHECKED	
NO.	

ORIGINAL SURVEY	DATE
SURVEYED	BY
NOTE BOOK	
TEMPLATE	
AREAS	
CHECKED	
NO.	

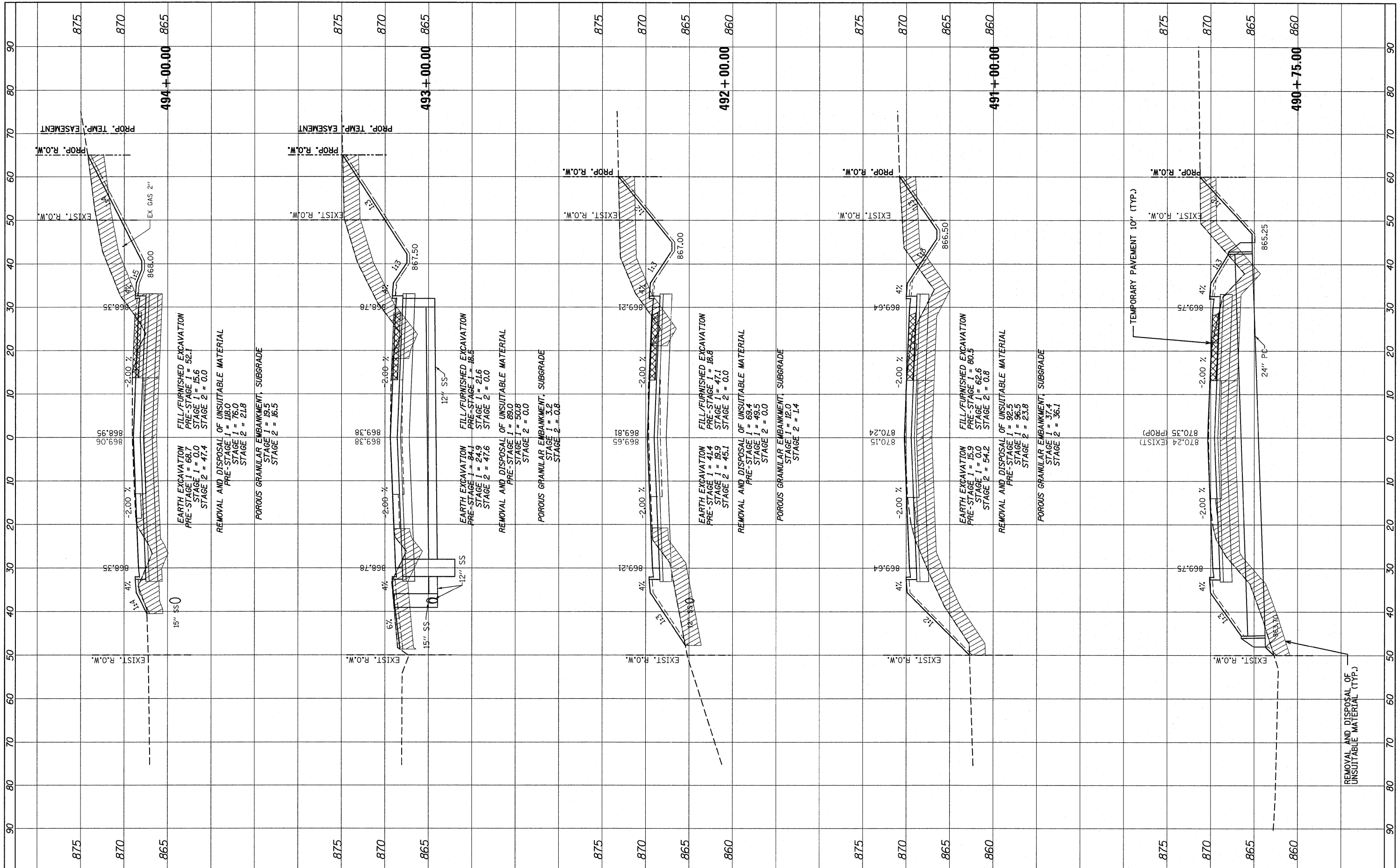

FILE NAME =
 #F:\D:\35-aht-xesht.dgn

USER NAME = #USER#
 PLOT SCALE = #SCALE#
 PLOT DATE = #DATE#

DESIGNED - ADW	REVISED - 10/21/2011 N.W.S.
DRAWN - ADW	REVISED -
CHECKED - RJD	REVISED -
DATE - JUNE 30, 2011	REVISED -

**STATE OF ILLINOIS
 DEPARTMENT OF TRANSPORTATION**

**IL RTE 62 (ALGONQUIN RD.) FROM EASTING'S WAY TO PENNY RD.
 CROSS SECTIONS**

SCALE: E=10(H); 1"=5'(V) SHEET NO. 3 OF 13 SHEETS STA. 490+75.00 TO STA. 494+00.00

F.A.P. RTE. 339	SECTION 116 Y-1-R-1	COUNTY COOK	TOTAL SHEETS 122	SHEET NO. 101
ILLINOIS FED. AID PROJECT			CONTRACT NO. 60135	