

FINAL SURVEY	BY	DATE
NOTE BOOK		
NO.		

ORIGINAL SURVEY	BY	DATE
NOTE BOOK		
NO.		

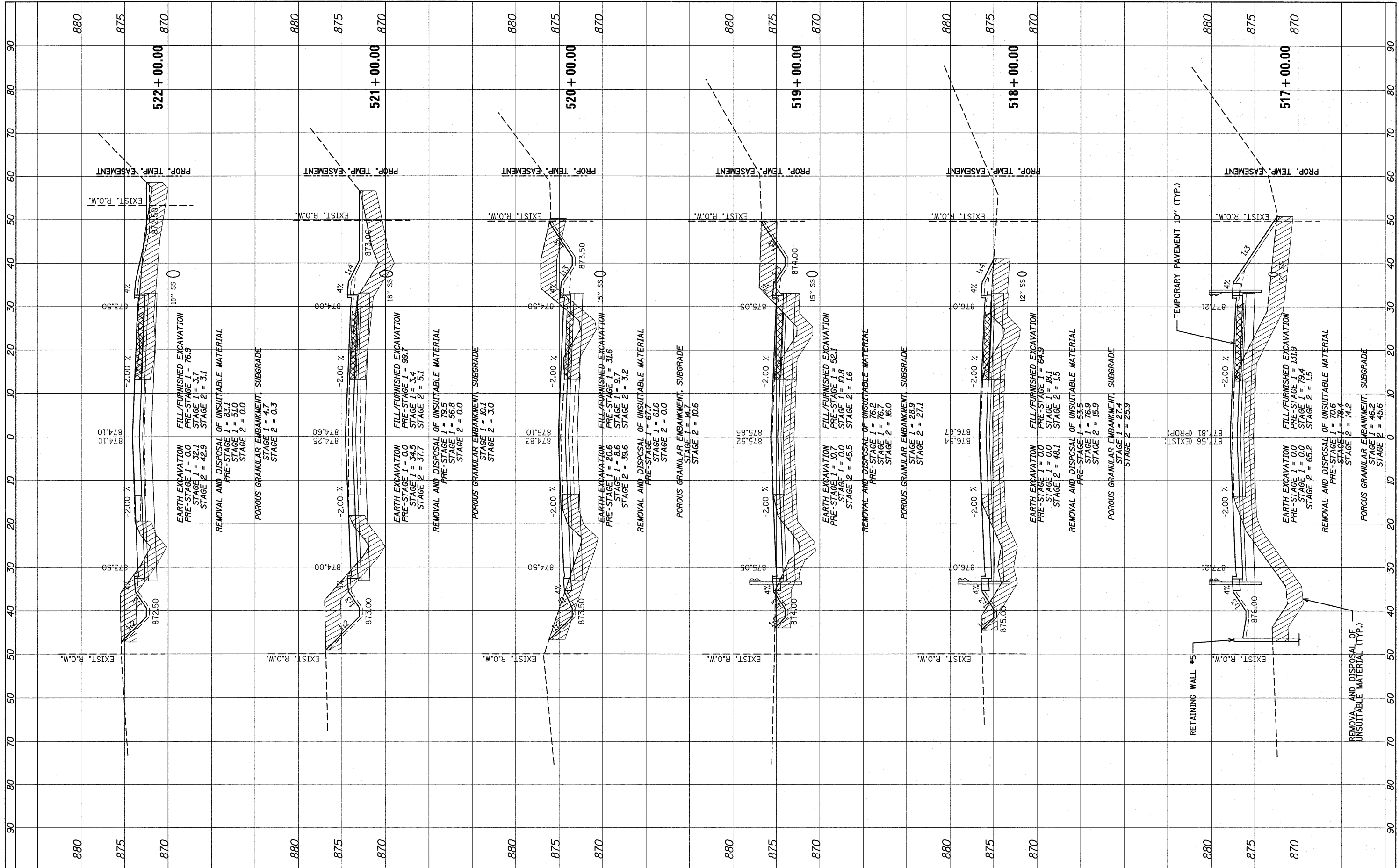

FILE NAME = #PUBID#35-sht-xssht.dgn
 USER NAME = #USER#
 PLOT SCALE = #SCALE#
 PLOT DATE = #DATE#

DESIGNED - ADW	REVISED - 10/21/2011 N.W.S.
DRAWN - ADW	REVISED -
CHECKED - RJD	REVISED -
DATE - JUNE 30, 2011	REVISED -

**STATE OF ILLINOIS
DEPARTMENT OF TRANSPORTATION**

**IL RTE 62 (ALGONQUIN RD.) FROM EASTING'S WAY TO PENNY RD.
CROSS SECTIONS**

SCALE: H=10(H); V=5(V) SHEET NO. 10 OF 13 SHEETS STA. 517+00.00 TO STA. 522+00.00

F.A.P. RTE. 339	SECTION 116 Y-1-R-1	COUNTY COOK	TOTAL SHEETS 122	SHEET NO. 108
ILLINOIS FED. AID PROJECT			CONTRACT NO. 60135	