

FINAL SURVEY	BY	DATE
NOTE BOOK		
AREAS CHECKED		
NO.		

ORIGINAL SURVEY	BY	DATE
NOTE BOOK		
AREAS CHECKED		
NO.		

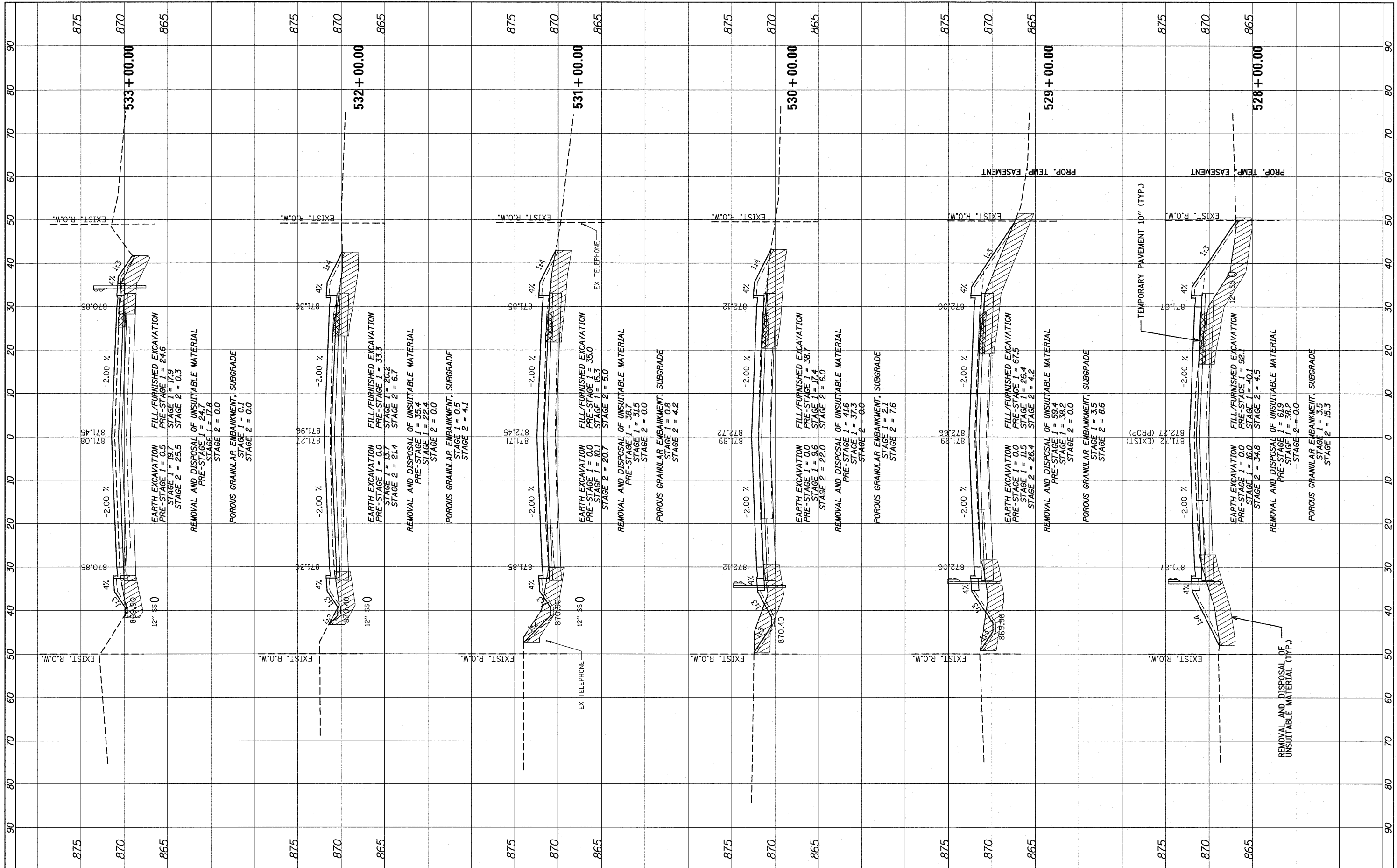

FILE NAME =
 #PLOT#35=ht-xesht.dgn

USER NAME = #USER#	DESIGNED - ADW	REVISED - 10/21/2011 N.W.S.
	DRAWN - ADW	REVISED -
PLOT SCALE = #SCALE#	CHECKED - RJD	REVISED -
PLOT DATE = #DATE#	DATE - JUNE 30, 2011	REVISED -

**STATE OF ILLINOIS
 DEPARTMENT OF TRANSPORTATION**

**IL RTE 62 (ALGONQUIN RD.) FROM EASTING'S WAY TO PENNY RD.
 CROSS SECTIONS**

SCALE: 1"=10'(H); 1"=5'(V) SHEET NO. 12 OF 13 SHEETS STA. 528+00.00 TO STA. 533+00.00

F.A.P. RTE. 339	SECTION 116 Y-1-R-1	COUNTY COOK	TOTAL SHEETS 122	SHEET NO. 110
CONTRACT NO. 60135			ILLINOIS FED. AID PROJECT	