

PROPOSED RAMP C ALIGNMENT
 =====
 POINT A50 N 1,858,733.68 E 961,018.83 STA 100+00.00
 POINT A51 N 1,858,857.92 E 961,043.60 STA 101+26.69

CURVE P_RMPC-1
 P.I. STATION 104+46.87 N 1,859,171.79 E 961,106.83
 DELTA = 50°18'30.85" (RT)
 DEGREE = 17°34'45.94"
 TANGENT = 153.05
 LENGTH = 286.18
 RADIUS = 325.93
 EXTERNAL = 34.15
 LONG CHORD = 277.07
 P.C. STATION 102+93.82 N 1,859,021.80 E 961,076.38
 P.T. STATION 105+79.99 N 1,859,244.16 E 961,241.69
 BACK = N 11°28'22.68" E
 AHEAD = N 61°46'53.53" E

CURVE P_RMPC-3
 P.I. STATION 107+84.24 N 1,859,302.63 E 961,435.68
 DELTA = 14° 25' 08.24" (RT)
 DEGREE = 14° 51' 39.88"
 TANGENT = 48.77
 LENGTH = 97.02
 RADIUS = 385.54
 EXTERNAL = 3.07
 LONG CHORD = 96.77
 MID. ORD. = 3.05
 P.C. STATION 107+35.47 N 1,859,295.58 E 961,387.42
 P.T. STATION 108+32.49 N 1,859,297.43 E 961,484.17
 BACK = N 81°41'57.77" E
 AHEAD = S 83°52'54.00" E

CURVE P_RMPC-2
 P.I. STATION 106+58.68 N 1,859,283.90 E 961,309.61
 DELTA = 21 33/64 47' 20.61" (RT)
 DEGREE = 14 33/64 00' 52.05"
 TANGENT = 78.69
 LENGTH = 155.48
 RADIUS = 408.83
 EXTERNAL = 7.50
 LONG CHORD = 154.54
 P.C. STATION 105+79.99 N 1,859,244.16 E 961,241.69
 P.T. STATION 107+35.47 N 1,859,295.58 E 961,387.42
 BACK = N 59° 40' 11.34" E
 AHEAD = N 81° 27' 31.95" E

POINT A52 N 1,859,288.68 E 961,574.11 STA 109+22.85

ENDING RAMP C ALIGNMENT
 =====

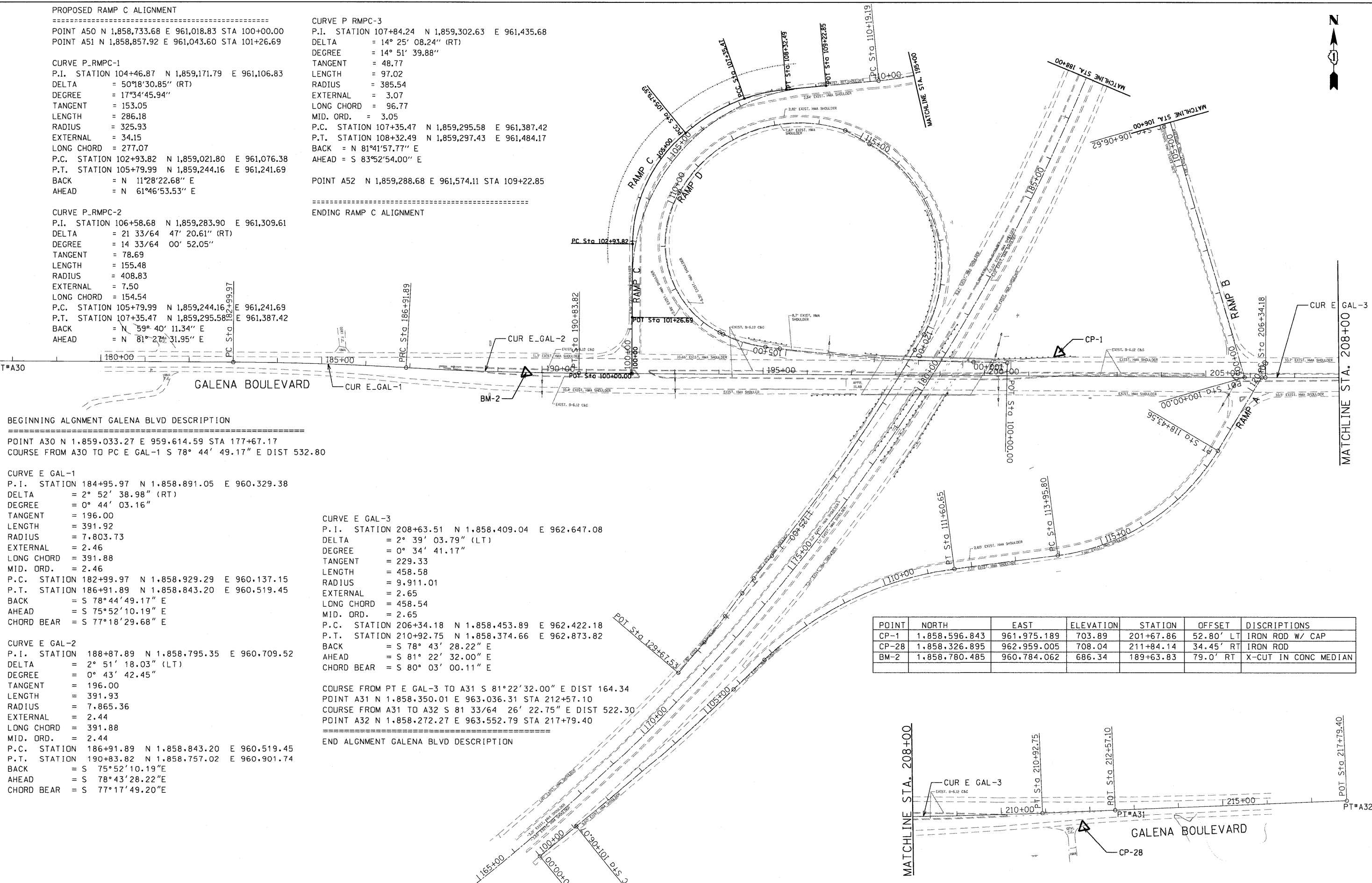

BEGINNING ALIGNMENT GALENA BLVD DESCRIPTION

POINT A30 N 1,859,033.27 E 959,614.59 STA 177+67.17
 COURSE FROM A30 TO PC E_GAL-1 S 78° 44' 49.17" E DIST 532.80

CURVE E_GAL-1
 P.I. STATION 184+95.97 N 1,858,891.05 E 960,329.38
 DELTA = 2° 52' 38.98" (RT)
 DEGREE = 0° 44' 03.16"
 TANGENT = 196.00
 LENGTH = 391.92
 RADIUS = 7,803.73
 EXTERNAL = 2.46
 LONG CHORD = 391.88
 MID. ORD. = 2.46
 P.C. STATION 182+99.97 N 1,858,929.29 E 960,137.15
 P.T. STATION 186+91.89 N 1,858,843.20 E 960,519.45
 BACK = S 78° 44' 49.17" E
 AHEAD = S 75° 52' 10.19" E
 CHORD BEAR = S 77° 18' 29.68" E

CURVE E_GAL-3
 P.I. STATION 208+63.51 N 1,858,409.04 E 962,647.08
 DELTA = 2° 39' 03.79" (LT)
 DEGREE = 0° 34' 41.17"
 TANGENT = 229.33
 LENGTH = 458.58
 RADIUS = 9,911.01
 EXTERNAL = 2.65
 LONG CHORD = 458.54
 MID. ORD. = 2.65
 P.C. STATION 206+34.18 N 1,858,453.89 E 962,422.18
 P.T. STATION 210+92.75 N 1,858,374.66 E 962,873.82
 BACK = S 78° 43' 28.22" E
 AHEAD = S 81° 22' 32.00" E
 CHORD BEAR = S 80° 03' 00.11" E

COURSE FROM PT E_GAL-3 TO A31 S 81°22'32.00" E DIST 164.34
 POINT A31 N 1,858,350.01 E 963,036.31 STA 212+57.10
 COURSE FROM A31 TO A32 S 81 33/64 26' 22.75" E DIST 522.30
 POINT A32 N 1,858,272.27 E 963,552.79 STA 217+79.40

END ALIGNMENT GALENA BLVD DESCRIPTION

POINT	NORTH	EAST	ELEVATION	STATION	OFFSET	DISCRIPTIONS
CP-1	1,858,596.843	961,975.189	703.89	201+67.86	52.80' LT	IRON ROD W/ CAP
CP-28	1,858,326.895	962,959.005	708.04	211+84.14	34.45' RT	IRON ROD
BM-2	1,858,780.485	960,784.062	686.34	189+63.83	79.0' RT	X-CUT IN CONC MEDIAN

FILE NAME = P:\2010\ME\0012_PTB156-16\Galena\CADD\Shets\0160K76-Sht-A1.dgn
 PLOT SCALE = 1/8" = 1'-0"
 USER NAME = Millennia Professional Services

200 22ND Street, Suite 216, Lombard, IL 60148
 630.785.0110 voice, 630.839.3566 fax
 www.mps-ill.com

MILLENNIA PROFESSIONAL SERVICES

DESIGNED - CJD	REVISED -
DRAWN - CJD	REVISED -
CHECKED - TVN	REVISED -
DATE - 8/29/2011	REVISED -

**STATE OF ILLINOIS
 DEPARTMENT OF TRANSPORTATION**

GALENA BOULEVARD

ALIGNMENTS & TIES PLAN

SCALE: 1"=100' SHEET NO. 1 OF 1 SHEETS STA. 178+00 TO STA. 218+00

F.A.P. RTE. 573	SECTION 61HB-1-R	COUNTY KANE	TOTAL SHEETS 110	SHEET NO. 10
CONTRACT NO. 60K76				
FED. ROAD DIST. NO. 1 ILLINOIS FED. AID PROJECT				

P:\2010\ME\0012_PTB156-16\Galena\CADD\Shets\0160K76-Sht-A1.dgn