

CONSTRUCTION NOTES:

TWO CHANGEABLE MESSAGE SIGNS ON GALENA BLVD WILL NEED TO BE IN PLACE ONE WEEK PRIOR AND ONE WEEK AFTER THE TRAFFIC SIGNAL IS TURNED-ON. ONE CHANGEABLE MESSAGE SIGN WILL BE PLACED WEST OF THE IL 56 WEST RAMPS AND THE OTHER CHANGEABLE MESSAGE SIGN WILL BE PLACED EAST OF THE IL 56 EAST RAMPS. THIS IS REQUIRED FOR A NEW STOP CONDITION.

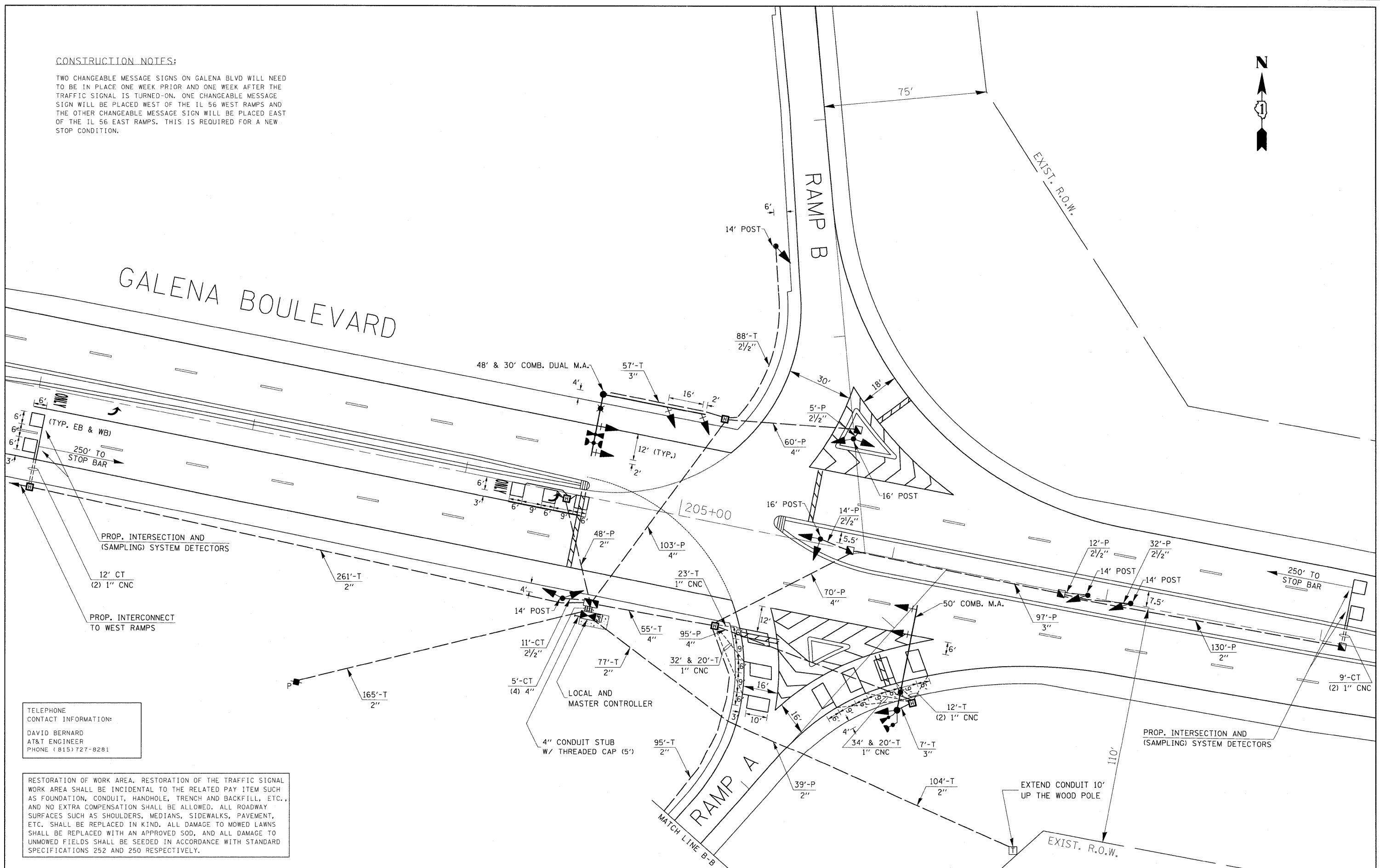

TELEPHONE CONTACT INFORMATION:
 DAVID BERNARD
 AT&T ENGINEER
 PHONE (815) 727-8281

RESTORATION OF WORK AREA. RESTORATION OF THE TRAFFIC SIGNAL WORK AREA SHALL BE INCIDENTAL TO THE RELATED PAY ITEM SUCH AS FOUNDATION, CONDUIT, HANDHOLE, TRENCH AND BACKFILL, ETC., AND NO EXTRA COMPENSATION SHALL BE ALLOWED. ALL ROADWAY SURFACES SUCH AS SHOULDERS, MEDIANS, SIDEWALKS, PAVEMENT, ETC. SHALL BE REPLACED IN KIND. ALL DAMAGE TO MOWED LAWNS SHALL BE REPLACED WITH AN APPROVED SOD, AND ALL DAMAGE TO UNMOWED FIELDS SHALL BE SEEDED IN ACCORDANCE WITH STANDARD SPECIFICATIONS 252 AND 250 RESPECTIVELY.

FILE NAME =	USER NAME = plascencia	DESIGNED - IP	REVISED -
#FILEABBREV#		DRAWN - IP	REVISED -
		CHECKED - DAG	REVISED -
		DATE -	REVISED -

**STATE OF ILLINOIS
 DEPARTMENT OF TRANSPORTATION**

**TRAFFIC SIGNAL INSTALLATION PLAN
 GALENA BLVD AND IL 56 EAST RAMPS (1 OF 2)**

F.A.U. RTE.	SECTION	COUNTY	TOTAL SHEETS	SHEET NO.
573	61HB-1-R	KANE	110	39
CONTRACT NO. 60K76				
FED. ROAD DIST. NO.	ILLINOIS FED. AID PROJECT			

SCALE: 1" = SHEET NO. OF SHEETS STA. TO STA.