

Notes:
 See sheet 20 of 39 for Sections C-C & D-D.
 See sheet 21 of 39 for Views B-B, E-E, and F-F.
 $a_{20}(E)$, $a_{21}(E)$, $a_{24}(E)$, $a_{25}(E)$, $a_{26}(E)$, $a_{27}(E)$, $w(E)$
 and $w_2(E)$ bar spacings measured along ϕ Rdwy.
 See sheet 18 of 39 for Median details.

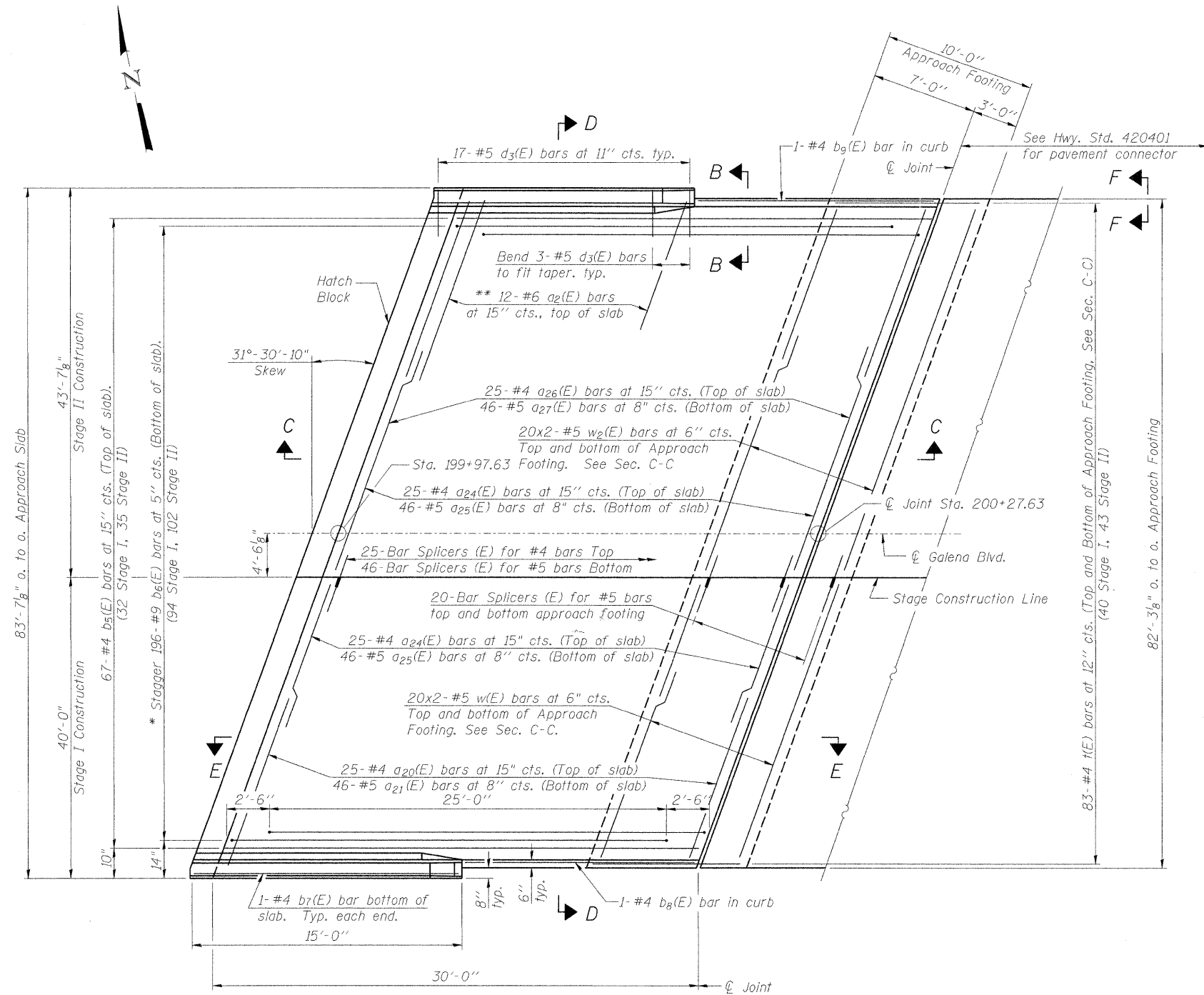

PLAN-EAST APPROACH

(Median not shown for clarity)

- * Tilt #9 $b_6(E)$ bars as required to maintain clearance.
- ** Space between $a_{20}(E)$ or $a_{26}(E)$ bars, typ. each parapet.

MIN. BAR LAP

- #4 Bar = 2'-4"
- #5 Bar = 2'-7"

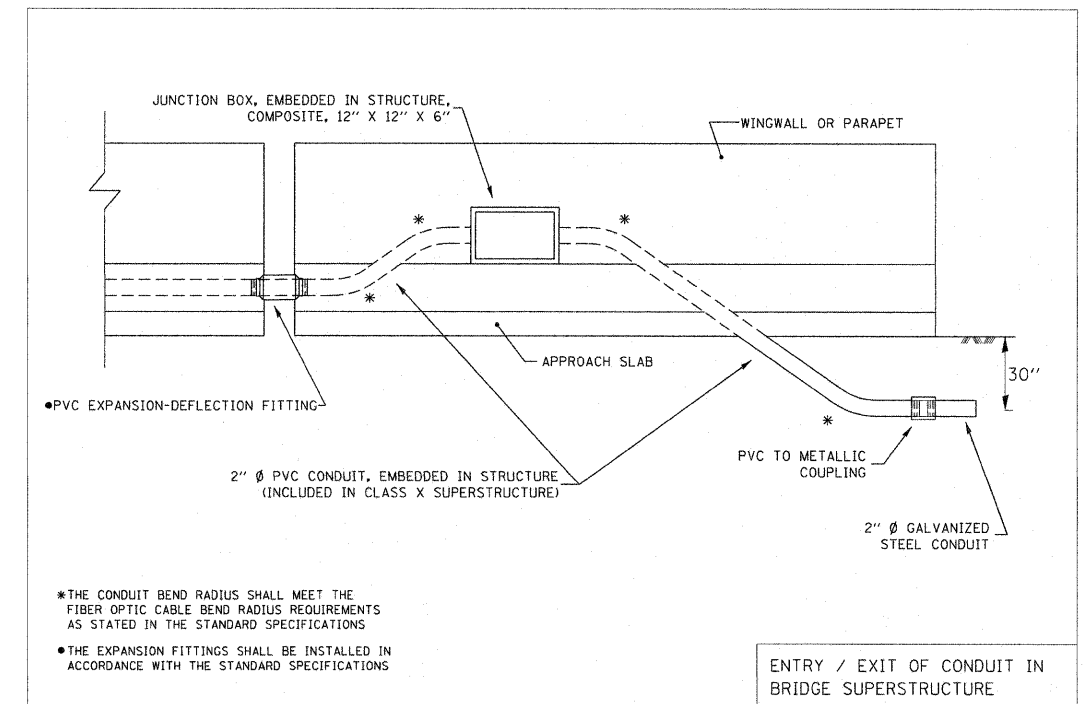

ENTRY/EXIT OF CONDUIT IN BRIDGE SUPERSTRUCTURE

(Located at Each Corner)

(Sheet 2 of 4)

| | | |
|--------------|----------------|-----------|
| USER NAME = | DESIGNED - MTH | REVISED - |
| FILE NAME = | CHECKED - ADB | REVISED - |
| PLOT SCALE = | DRAWN - AJF | REVISED - |
| PLOT DATE = | CHECKED - MTH | REVISED - |

| | | | | |
|--------------------|----------|--------|---------------------------|-----------|
| F.A.P. RTE. | SECTION | COUNTY | TOTAL SHEETS | SHEET NO. |
| 573 | 61HB-1-R | KANE | 110 | 69 |
| CONTRACT NO. 60K76 | | | ILLINOIS FED. AID PROJECT | |