

**IL ROUTE 31**

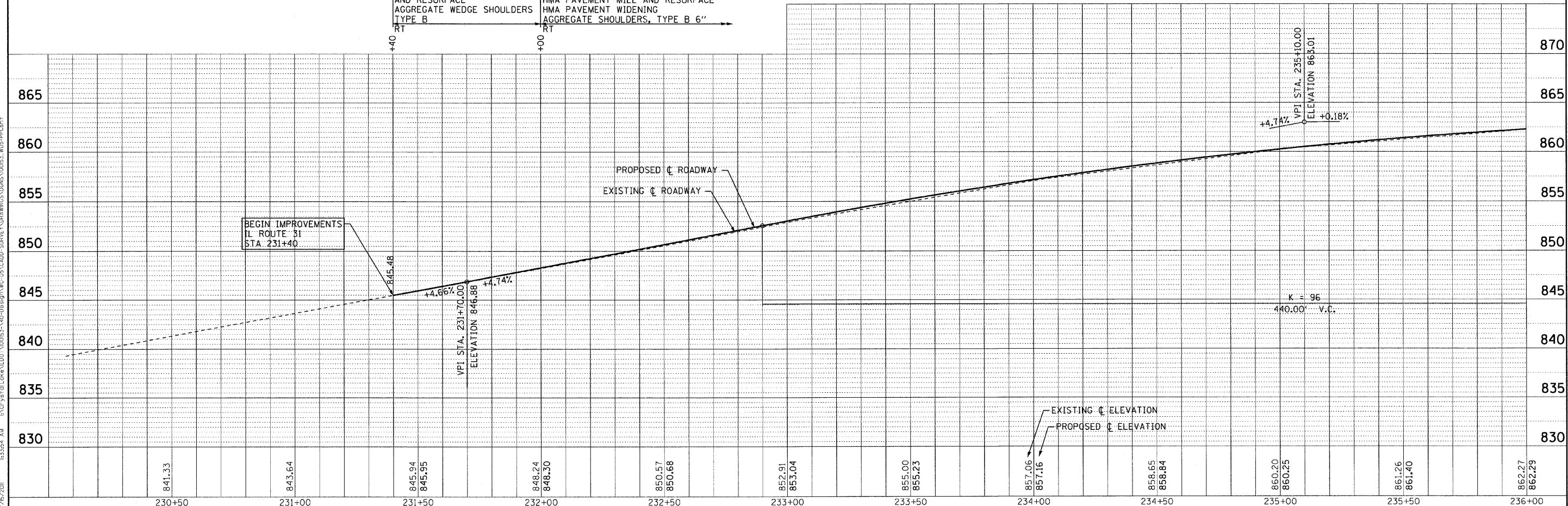

COPYRIGHT © 2010 BY BAXTER & WOODMAN, INC. PROJECT NO. 100153-W05-PPL-RT  
 LICENSE NO. 184-00121 - EXPIRES 4/30/2011  
 7/6/2011 10:35:47 AM



DESIGNED - DJS	REVISED - 1-28-11 PER IDOT REVIEW
DRAWN - CJC	REVISED - 3-14-11 PER IDOT REVIEW
CHECKED - LDH	REVISED -
DATE - 09/10/10	FILE - 100153.W05-PPL.shx

**STATE OF ILLINOIS**  
**DEPARTMENT OF TRANSPORTATION**

**IL ROUTE 31 - AMES ROAD TO EDGEWOOD ROAD**  
**GEOMETRIC PLAN AND PROFILE**

SCALE: H: 1"=20' V: 1"=5'

STA. 230+00 TO STA. 236+00

F.A.P. RTE. 336	SECTION 2010-049-N	COUNTY MCHENRY	TOTAL SHEETS 50	SHEET NO. 12
FED. ROAD DIST. NO. 1 ILLINOIS			CONTRACT NO. 60L25	