

COPYRIGHT © 2002 BY BAXTER & WOODMAN, INC.
 ALL RIGHTS RESERVED. THIS DRAWING IS THE PROPERTY OF BAXTER & WOODMAN, INC. AND IS NOT TO BE REPRODUCED OR TRANSMITTED IN ANY FORM OR BY ANY MEANS, ELECTRONIC OR MECHANICAL, WITHOUT PERMISSION IN WRITING FROM BAXTER & WOODMAN, INC.
 LICENSE NO. 184-00121 - EXPIRES 4/30/2011
 7/5/2010 10:33:59 AM 416C/C

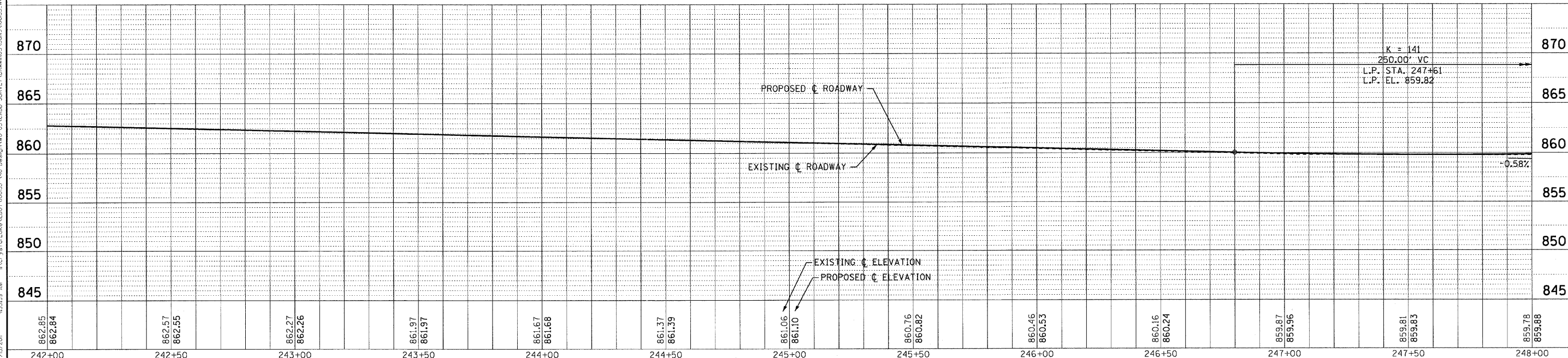

862.85 862.84	862.57 862.55	862.27 862.26	861.97 861.97	861.67 861.68	861.37 861.39	861.06 861.10	860.76 860.82	860.46 860.53	860.16 860.24	859.87 859.96	859.61 859.63	859.78 859.88
242+00	242+50	243+00	243+50	244+00	244+50	245+00	245+50	246+00	246+50	247+00	247+50	248+00



DESIGNED - DJS	REVISED -1-28-11 PER IDOT REVIEW
DRAWN - CJC	REVISED -
CHECKED - LDH	REVISED -
DATE - 09/10/10	FILE - 100153_W05-PP3.shx

STATE OF ILLINOIS
DEPARTMENT OF TRANSPORTATION

IL ROUTE 31 - AMES ROAD TO EDGEWOOD ROAD
GEOMETRIC PLAN AND PROFILE

SCALE: H: 1"=20' V: 1"=5'

STA. 242+00 TO STA. 248+00

F.A.P. RTE. 336	SECTION 2010-049-N	COUNTY MCHENRY	TOTAL SHEETS 50	SHEET NO. 14
FED. ROAD DIST. NO. 1 ILLINOIS			CONTRACT NO. 60L25	