

Notes:
 See sheet S6 of 9 for Sections C-C & D-D.
 $a_4(E)$, $a_5(E)$ and $a_6(E)$ bar spacings measured along \varnothing Rdwy.

** Cost included with Concrete Superstructure.

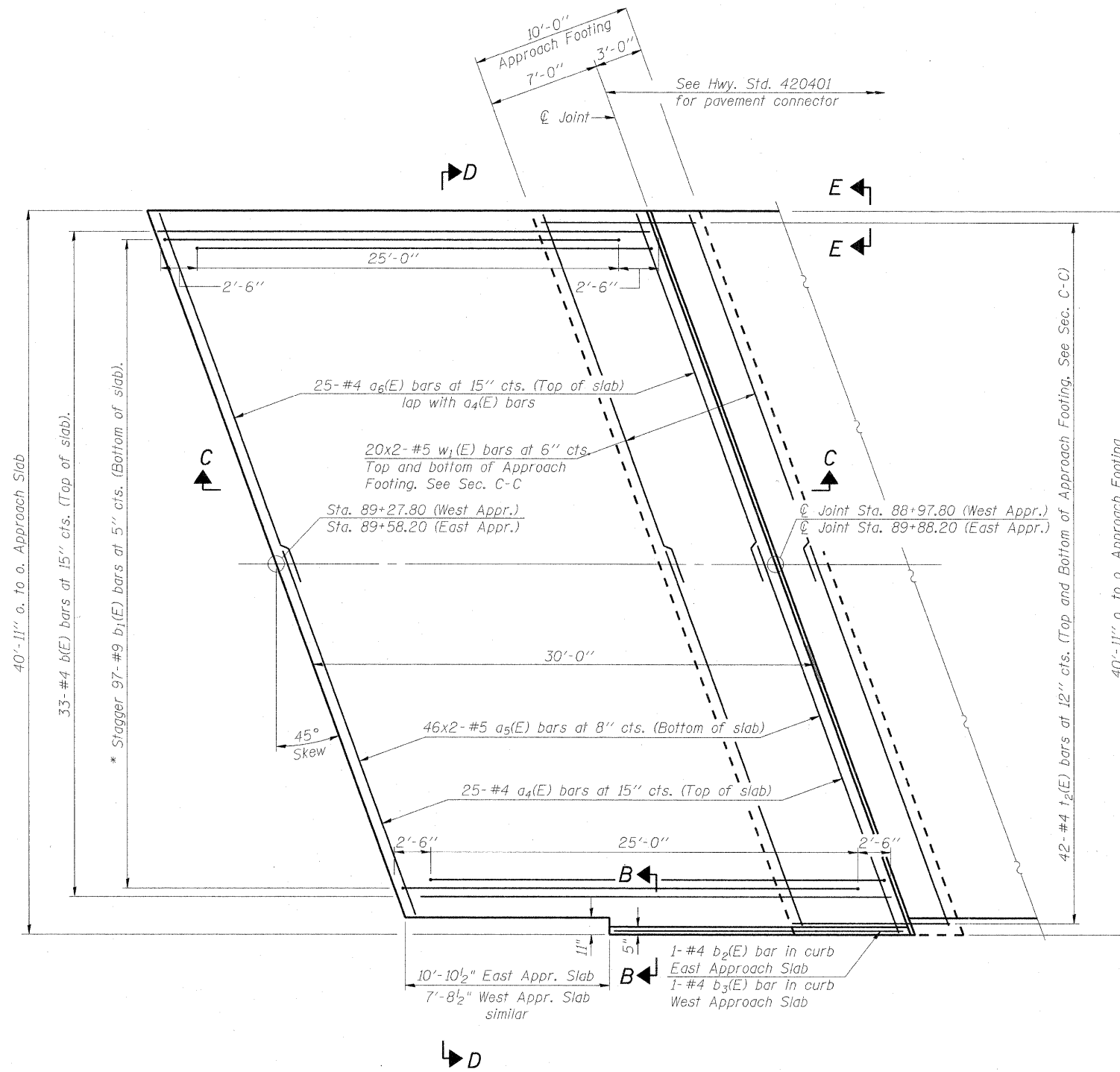

PLAN

* Tilt #9 $b_1(E)$ bars as required to maintain clearance.

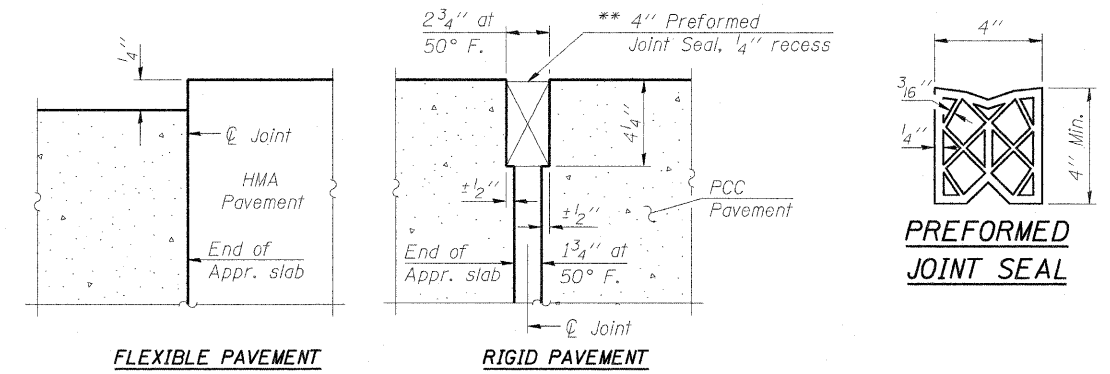

DETAIL A

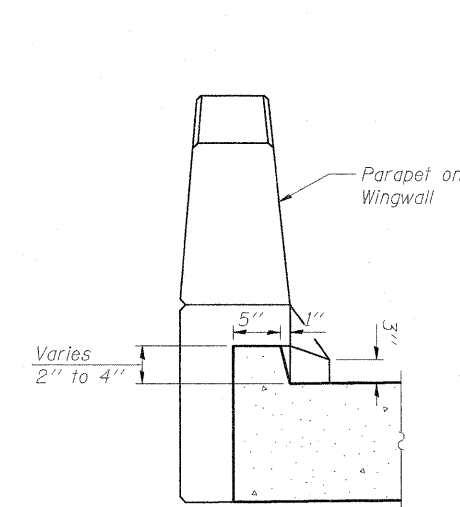

VIEW B-B

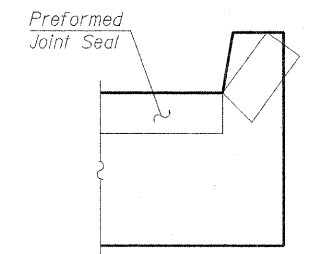

VIEW E-E

Angle Preformed Joint Seal at 45° at curbs when req'd for drainage.

MINIMUM BAR LAPS

- #4 Bar - 2'-1"
- #5 Bar - 2'-7"

FILE NAME = G:\projects\2102195_002\CADD\Structure\Sh\VE6B301-52MB4-005-Approach Slab Details 1 of 2.dgn



USER NAME = zpiend
PLOT SCALE = N/A
PLOT DATE = 9/7/2011

DESIGNED - BPS
CHECKED - BHS
DRAWN - BPS
CHECKED - BHS

REVISED -
REVISED -
REVISED -
REVISED -

**STATE OF ILLINOIS
 DEPARTMENT OF TRANSPORTATION**

**APPROACH SLAB DETAILS (1 OF 2)
 S.N. 056-0301**

SHEET NO. S5 OF 9 SHEETS

F.A.P. RTE. 533	SECTION 119-T-1	COUNTY McHENRY	TOTAL SHEETS 40	SHEET NO. 20
IL ROUTE 176		CONTRACT NO. 60M54		
FED. ROAD DIST. NO.		ILLINOIS FED. AID PROJECT		