

STAGE IIIA DECK PATCHING SCHEDULE

STRUCTURE NO.	LANE NO.	PARTIAL-DEPTH PATCHING SO. YD.	FULL-DEPTH PATCHING SO. YD.	LANE CLOSURE
016-0036	3	282	0	LANE 3 NB
016-1045	---	---	---	
016-1048	---	---	---	
016-1052	1	73	0	LANE 1 SB
016-1055	1	12	0	LANE 1 SB
016-1075	---	---	---	

NOTE:
SOME PARTIAL-DEPTH PATCHES MAY REQUIRE FULL-DEPTH PATCHING BASED ON FIELD CONDITIONS

STAGE IIIA TRAFFIC CONTROL NOTES

- LANE 2 NB (SN 016-0036) AND LANE 1 SB (SN 016-1055) CLOSURES WILL BE ALLOWED AS NOTED IN THE SPECIAL PROVISION "KEEPING EXPRESSWAY OPEN TO TRAFFIC".
- LANE 3 NB (SN 016-0036):
 - PATCHING DURING STAGE IIIA WILL BE DONE IN LANE 3 NB.
 - TRAFFIC CONTROL:
CLOSE LANE 3 NB (SN 016-0036) AFTER THE CERMAK EXIT. USE STANDARDS 701400 & 701401.
FOR SB & NB RYAN EXIT RAMP, USE STANDARD 701411, APPLICATION 2 AND LEAD TRAFFIC TO LANE 2.
CLOSE ENTRANCE RAMP FROM STATE STREET TO NB I-55. SEE ENTRANCE RAMP CLOSURE DETAIL AND DETOUR PLANS.
TO PROVIDE ACCESS TO EXIT RAMP TO DR. MARTIN LUTHER KING, JR. DRIVE, USE STANDARD 701411, APPLICATION 4.
- LANE 1 SB (SN 016-0055):
 - PATCHING DURING STAGE IIIA WILL BE DONE IN LANE 1 SB.
 - TRAFFIC CONTROL:
CLOSE LANE 3 NB (SN 016-1048) USING SINGLE LANE WEAVE DETAIL ON (SN 016-1048). LEAD TRAFFIC TO (SN 016-1052) LANE 2.
CLOSE LANE 2 SB (SN 016-1052) AS SHOWN IN STAGE IB. SEE SHEET NO. 6.

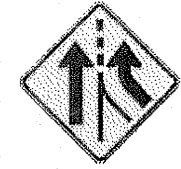
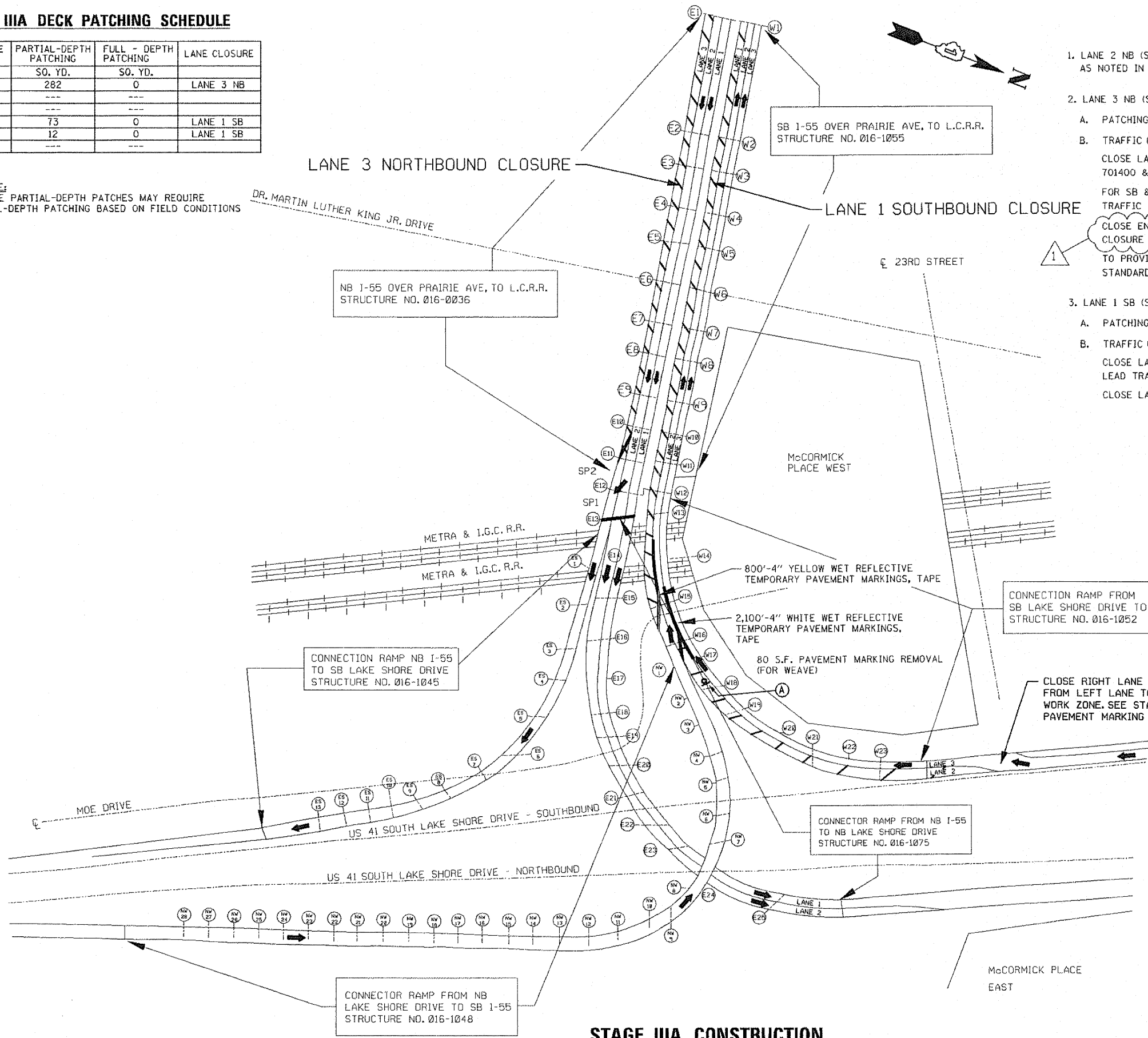

W4-3
(48 x 48)
A

LEGEND:

- WORK ZONE OR LANE CLOSURE
- TRAFFIC DIRECTION

STAGE IIIA CONSTRUCTION

FILE NAME: J:\1102988\1-55\STRUCTURAL\sheet\0160P37-08-stage_IIIAdgn

	USER NAME = 100T	DESIGNED - J.C.N./B.N.S.	REVISED - ADDENDUM I 11-04-2011	STATE OF ILLINOIS DEPARTMENT OF TRANSPORTATION	SUGGESTED STAGE IIIA CONSTRUCTION F.A.I. RTE. I-55 OVER U.S. 41 / LAKE SHORE DRIVE	F.A.I. RTE. 55	SECTION 2011-031-BR	COUNTY COOK	TOTAL SHEETS 41	SHEET NO. 8
	PLOT SCALE = 50.0000' / 1" IN.	DRAWN - F.M.	REVISOR -			CONTRACT NO. 60P37	ILLINOIS FED. AID PROJECT			
	PLOT DATE = 11/3/2011	DATE - OCTOBER 12, 2011	REVISOR -	SHEET NO. 58 OF 541 SHEETS						