

FOR INDEX OF SHEETS, SEE SHEET NO. 2

FUNCTIONAL CLASSIFICATION: INTERSTATE F.A.I.  
ADT: 59,850 (2005), 74,480 (2021)  
DESIGN SPEED LIMIT: 50 MPH  
POSTED SPEED LIMIT: 50 MPH

**SCOPE OF WORK**

WITHIN THE PROJECT LIMITS SIX (6) BRIDGE STRUCTURES WILL HAVE INTERIM REPAIRS TO THE BRIDGE DECKS. TWO (2) BRIDGES WILL HAVE REPAIRS TO THE PIERS.

IMPROVEMENTS LOCATED IN THE CITY OF CHICAGO, COOK COUNTY

**LOCATION OF WORK:**  
F.A.I. 55 AT U.S. 41  
SN 016-0036, SN 016-1045  
SN 016-1048, SN 016-1052  
SN 016-1055, SN 016-1075

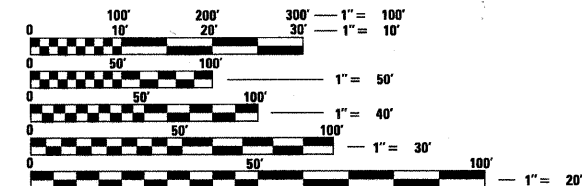

FULL SIZE PLANS HAVE BEEN PREPARED USING STANDARD ENGINEERING SCALES. REDUCED SIZED PLANS WILL NOT CONFORM TO STANDARD SCALES. IN MAKING MEASUREMENTS ON REDUCED PLANS, THE ABOVE SCALES MAY BE USED.

C.U.A.N.  
CHICAGO UTILITY ALERT NETWORK  
1-312-744-7000

PROJECT MANAGER: ISSAM RAYYAN (842) 705-4178  
PROJECT ENGINEER: ROBERT BORO (847) 705-4237

CONTRACT NO. 60P37

STATE OF ILLINOIS  
DEPARTMENT OF TRANSPORTATION  
DIVISION OF HIGHWAYS

**PROPOSED  
HIGHWAY PLANS**

F.A.I. RTE. 55 / I-55 (STEVENSON EXPRESSWAY)

SECTION: 2011-031-BR  
PRAIRIE AVE. TO ICG RR

BRIDGE DECK REPAIRS

COOK COUNTY

C-91-522-11

SOUTH TOWNSHIP  
R. 14 E.

PROJ. ACIM-055-7(263)294

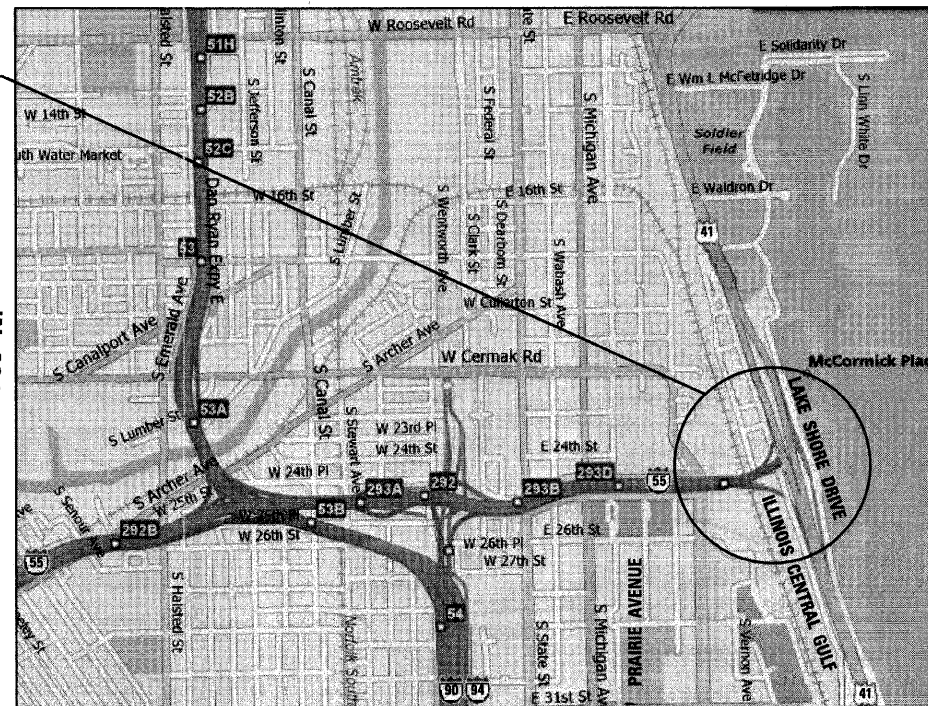

GROSS & NET LENGTH = 7,796 FEET = 1.478 MILES

F.A.I. RTE.	SECTION	COUNTY	TOTAL SHEETS	SHEET NO.
55	2011-031-BR	COOK	41	1
STA.		TO STA.		
FED. ROAD DIST. NO.		ILLINOIS	FED. AID PROJECT	

D-91-522-11 <sup>\*41+2=43</sup>  
<sub>\*43+2=45</sub>

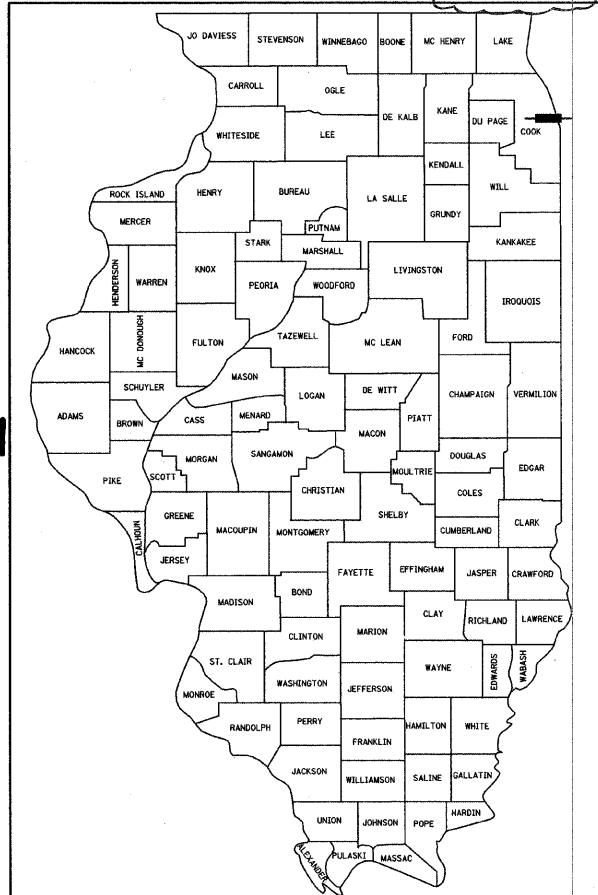

LOCATION OF SECTION INDICATED THIS: - [black rectangle] -

STATE OF ILLINOIS  
DEPARTMENT OF TRANSPORTATION  
DIVISION OF HIGHWAYS

SUBMITTED: [signature]  
DEPUTY DIRECTOR OF HIGHWAYS, REGION ONE ENGINEER  
October 14 2011  
acting ENGINEER OF DESIGN AND ENVIRONMENT  
October 14 2011  
Christine M. Reed  
DIRECTOR OF HIGHWAYS, CHIEF ENGINEER



Bhadresh N. Shah  
BHADRESH N. SHAH  
LICENSED STRUCTURAL ENGINEER  
STATE OF ILLINOIS LIC. No. 081-004476  
EXPIRES: 11-30-12



CHRISTIAN-ROGE & ASSOCIATES, INC.  
ENGINEERS / PLANNERS / SURVEYORS  
211 W. WACKER DRIVE CHICAGO, IL. 60606  
TELEPHONE: 312-372-2023

PRINTED BY THE AUTHORITY  
OF THE STATE OF ILLINOIS

Rev. 11-8-11

**INDEX OF SHEETS**

SHEET NO.	DESCRIPTION
1	COVER SHEET
2	INDEX OF SHEETS, LIST OF STATE STANDARDS AND GENERAL NOTES
3	SUMMARY OF QUANTITIES
4	SITE PLAN
5	SUGGESTED STAGE IA CONSTRUCTION
6	SUGGESTED STAGE IB CONSTRUCTION
7	SUGGESTED STAGE II CONSTRUCTION
8	SUGGESTED STAGE IIIA CONSTRUCTION
9	SUGGESTED STAGE IIIB CONSTRUCTION
10	DETOUR PLAN - STAGE IIIB
11	NIGHT TIME DETOUR PLAN - STAGE II & STAGE IIIB
11A	NIGHTLY DETOUR PLAN - STAGE II
11B	STATE STREET RAMP DETOUR
<b>S.N. 016-0036</b>	
12	GENERAL PLAN & ELEVATION
13	DECK CONCRETE PATCHING
13A	PIER E12 REPAIRS
<b>S.N. 016-1045</b>	
14	GENERAL PLAN & ELEVATION
15	DECK CONCRETE PATCHING
16	PIER ES3 REPAIRS
17	PIER ES6 REPAIRS
18	PIER ES7 REPAIRS
<b>S.N. 016-1048</b>	
19	GENERAL PLAN & ELEVATION
20	DECK CONCRETE PATCHING
<b>S.N. 016-1052</b>	
21	GENERAL PLAN & ELEVATION
22	DECK CONCRETE PATCHING
<b>S.N. 016-1055</b>	
23	GENERAL PLAN & ELEVATION
24	DECK CONCRETE PATCHING
<b>S.N. 016-1075</b>	
25	GENERAL PLAN & ELEVATION
26	DECK CONCRETE PATCHING
27	PIER E15 REPAIRS
28	PIER E16 REPAIRS
29	BAR SPLICER ASSEMBLY AND MECHANICAL SPLICER DETAILS
30	EXISTING PLANS - PIERS ES1, ES2 & ES3
31	EXISTING PLANS - PIER ES6
32	EXISTING PLANS - PIER ES7
33	EXISTING PLANS - PIER E12
34	EXISTING PLANS - PIERS E14 & E15
35	EXISTING PLANS - PIERS E16 & E17
36	FREEWAY ENTRANCE AND EXIT RAMP CLOSURE DETAIL
37	TRAFFIC CONTROL DETAILS FOR FREEWAY SINGLE & MULTI-LANE WEAVE
38	TRAFFIC CONTROL DETAILS FOR FREEWAY SHOULDER CLOSURES AND PARTIAL RAMP CLOSURES
39	TRAFFIC CONTROL DETAILS FOR FREEWAY CENTER LANE CLOSURE SHOULDER LANE
40	MULTI-LANE FREEWAY PAVEMENT MARKING DETAILS
41	MULTI-LANE FREEWAY PAVEMENT MARKING DETAILS

**LIST OF STATE STANDARDS**

STANDARD NO.	DESCRIPTION
701400-05	APPROACH TO LANE CLOSURE, FREEWAY/EXPRESSWAY
701401-06	LANE CLOSURE, FREEWAY/EXPRESSWAY
701411-07	LANE CLOSURE, MULTILANE, AT ENTRANCE OR EXIT RAMP, FOR SPEEDS > 45 MPH
701422-03	LANE CLOSURE, MULTILANE, FOR SPEEDS >= 45 MPH TO 55 MPH
701446-02	TWO LANE CLOSURE FREEWAY/EXPRESSWAY
701901-01	TRAFFIC CONTROL DEVICES
704001-06	TEMPORARY CONCRETE BARRIER
780001-02	TYPICAL PAVEMENT MARKINGS

**GENERAL NOTES:**

- THESE PLANS HAVE BEEN PREPARED FROM NOTES RECEIVED FROM I.D.O.T. FIELD MAINTENANCE ENGINEERS.
- THE CONTRACTOR MUST USE EXTREME CAUTION DURING FULL DEPTH DECK SLAB REPAIR AND MUST NOT NICK, CUT OR DAMAGE, IN ANY WAY, ANY OF THE STEEL BEAMS. THE EXISTING REINFORCEMENT BARS SHALL BE CLEANED. IF ANY OF THESE REINFORCEMENT BARS ARE DAMAGED THEY MUST BE REPLACED WITH AN APPROVED BAR SPLICER OR ANCHORAGE SYSTEM. THE COST OF THIS WORK IS INCLUDED WITH DECK SLAB REPAIR (FULL DEPTH, TYPE II).
- THE CONTRACTOR SHALL CONTACT THE TRAFFIC CONTROL SUPERVISOR AT (847) 705-4151 AT LEAST 72 HOURS PRIOR TO INSTALLATION OF THE TEMPORARY TRAFFIC CONTROL DEVICES.
- THERE ARE ELECTRICAL CONDUITS AND/OR FIBERGLASS DRAIN PIPES ATTACHED TO THE BOTTOM OF THE BRIDGE DECK. THE CONTRACTOR MAY MODIFY THE FORMING AND MUST EXERCISE EXTREME CAUTION DURING FULL DEPTH REPAIR BREAK OUT AND SHALL TEMPORARILY SUPPORT THE CONDUITS AND/OR DRAIN PIPES IF NEED BE, AT NO ADDITIONAL COST TO THE DEPARTMENT.
- WHEN ARTIFICIAL LIGHTING IS UTILIZED IN NIGHT OPERATIONS, THE CONTRACTOR MUST EXERCISE THE UTMOST PRECAUTIONS IN PREVENTING ADVERSE VISIBILITY TO THE MOTORING PUBLIC.
- PLAN DIMENSIONS AND DETAILS RELATIVE TO EXISTING PLANS ARE SUBJECT TO ROUTINE VARIATIONS. THE CONTRACTOR SHALL FIELD VERIFY EXISTING DIMENSIONS AND DETAILS AFFECTING NEW CONSTRUCTION AND MAKE NECESSARY APPROVED ADJUSTMENTS PRIOR TO CONSTRUCTION OR ORDERING OF MATERIALS. SUCH VARIATIONS SHALL NOT BE CAUSE FOR ADDITIONAL COMPENSATION FOR A CHANGE IN THE SCOPE OF THE WORK, HOWEVER, THE CONTRACTOR WILL BE PAID FOR THE QUANTITY ACTUALLY FURNISHED BASED UPON THE UNIT PRICE BID FOR THE WORK.
- BEFORE STARTING ANY EXCAVATION, THE CONTRACTOR SHALL CALL C.U.A.N. AT (312) 744-7000 FOR FIELD LOCATIONS OF BURIED ELECTRIC, TELEPHONE AND GAS UTILITIES (48 HOURS NOTIFICATION IS REQUIRED).
- THE CONTRACTOR WILL NOT BE ALLOWED TO SET UP A YARD OR FIELD OFFICE ON STATE PROPERTY WITHOUT WRITTEN PERMISSION FROM THE DEPARTMENT.
- TO COORDINATE ACCESS TO THE McCORMICK PLACE PARKING LOT CALL DARREN PETER AT (312) 296-5984.
- DURING ANY WORK WITHIN THE McCORMICK PLACE PARKING LOT, THE CONTRACTOR MUST COORDINATE WITH THE McCORMICK PLACE PARKING LOT AUTHORITY AS TO AVOID ANY AND ALL CONFLICTS DURING THIS CONTRACT.
- DO NOT SCALE PLANS FOR CONSTRUCTION DIMENSIONS.
- ANY DAMAGES TO THE CONDUITS OR PIPES CAUSED BY THE CONTRACTOR'S OPERATIONS SHALL BE REPLACED OR REPAIRED BY THE CONTRACTOR AT HIS/HER EXPENSE.
- ALL PROPOSED RAISED REFLECTIVE PAVEMENT MARKERS (BRIDGE) SHALL BE LOW PROFILE.
- THE CONTRACTOR SHALL COORDINATE AND/OR MODIFY THE WORK SCHEDULE AS DIRECTED BY THE DEPARTMENT TO ACCOMMODATE SPECIAL EVENTS.
- THE CONTRACTOR SHALL PLACE TEMPORARY CONCRETE BARRIER ADJACENT TO TEMPORARY SHORING AND CRIBBING TO PROVIDE A BARRIER FROM PARKING LOT TRAFFIC. AN ESTIMATED THREE (3) SECTIONS OF TEMPORARY CONCRETE BARRIER WILL BE NEEDED AT EACH SHORING AND CRIBBING LOCATIONS.
- THE CONTRACTOR SHALL USE PP3 CONCRETE FOR ALL DECK PATCHES.
- AS PART OF THIS PROJECT, ALL BRIDGE DECKS SHALL BE RE-STRIPED AND RAISED REFLECTIVE PAVEMENT MARKERS SHALL BE REMOVED AND REPLACED.
- THE CONTRACTOR WILL BE ALLOWED ADDITIONAL TEMPORARY LANE CLOSURES TO MEASURE AND SAWCUT PATCHING AREAS AND TO LAYOUT WEAVE LOCATIONS.
- TO COORDINATE TRAFFIC CONTROL WITH McCORMICK PLACE CALL EUGENE HARTISON AT (312) 791-6081.

FILE NAME = I:\102-986-1-55-STRUCTURAL\sheet\0160037-02-index of sheets.dgn

	USER NAME = IDOT	DESIGNED - J.C.N./B.N.S.	REVISED -  ADDENDUM 1 11-04-2011	<b>STATE OF ILLINOIS</b> <b>DEPARTMENT OF TRANSPORTATION</b>	<b>INDEX OF SHEETS, LIST OF STATE STANDARDS AND GENERAL NOTES</b> <b>F.A.I. RTE. I-55 OVER U.S. 41 / LAKE SHORE DRIVE</b>	F.A.I. RTE.	SECTION	COUNTY	TOTAL SHEETS	SHEET NO.
	PLOT SCALE = 50.0000' / 1" IN.	CHECKED - B.N.S./J.C.N.	REVISED -			55	2011-031-BR	COOK	41	2
	PLOT DATE = 11/9/2011	DRAWN - F.M.	REVISED -			ILLINOIS FED. AID PROJECT				
		DATE - OCTOBER 12, 2011	REVISED -			CONTRACT NO. 60P37				
						SHEET NO. 52 OF 541 SHEETS				

# SUMMARY OF QUANTITIES

90% FED. / 10% STATE

CODE NO.	DESCRIPTION	UNIT	URBAN TOTAL QUANTITIES	CONSTRUCTION TYPE CODE						
				S.N. 016-0036 FUNDS 0014	S.N. 016-1045 FUNDS 0014	S.N. 016-1048 FUNDS 0014	S.N. 016-1052 FUNDS 0014	S.N. 016-1055 FUNDS 0014	S.N. 016-1075 FUNDS 0014	
44200581	CLASS A PATCHES, TYPE III, 12 INCH	SQ YD	15	15						
44213000	PATCHING REINFORCEMENT	SQ YD	15	15						
44213200	SAW CUTS	FOOT	68	68						
44213202	TIE BARS, 1"	EACH	10	10						
50102400	CONCRETE REMOVAL	CU YD	24		18					6
50300225	CONCRETE STRUCTURES	CU YD	24		18					6
50800205	REINFORCEMENT BARS, EPOXY COATED	POUND	7,230		5,800					1,430
52100520	ANCHOR BOLTS, 1"	EACH	6	2	2					2
52100530	ANCHOR BOLTS, 1 1/4"	EACH	14		8					6
67100100	MOBILIZATION	L SUM	1	0.17	0.17	0.17	0.17	0.16		0.16
70102625	TRAFFIC CONTROL AND PROTECTION, STANDARD 701606	L SUM	1		1					
70106800	CHANGEABLE MESSAGE SIGN	CAL MO	9	2	2	2	1	1		1
<del>70300520</del>	<del>PAVEMENT MARKING TAPE, TYPE III, 4"</del>	<del>FOOT</del>	<del>5,000</del>	<del>1,800</del>		<del>800</del>	<del>2,400</del>			
<del>70300550</del>	<del>PAVEMENT MARKING TAPE, TYPE III, 8"</del>	<del>FOOT</del>	<del>7,000</del>	<del>2,500</del>		<del>2,100</del>	<del>2,400</del>			
<del>70200100</del>	<del>NIGHTTIME WORK ZONE LIGHTING</del>	<del>L SUM</del>	<del>1</del>	<del>0.17</del>	<del>0.17</del>	<del>0.17</del>	<del>0.17</del>	<del>0.16</del>		<del>0.16</del>
70301000	WORK ZONE PAVEMENT MARKING REMOVAL	SQ FT	7,878	3,828		1,650	2,400			
70400100	TEMPORARY CONCRETE BARRIER	FOOT	475	75	250					150
* 78008210	POLYUREA PAVEMENT MARKING, TYPE I - LINE 4"	FOOT	16,400	2,800	3,000	4,500	1,600	2,100		2,400
* 78008220	POLYUREA PAVEMENT MARKING, TYPE I - LINE 5"	FOOT	1,780	720			210	540		310
* 78008240	POLYUREA PAVEMENT MARKING, TYPE I - LINE 8"	FOOT	1,890	1,590	300					
* 78008250	POLYUREA PAVEMENT MARKING, TYPE I - LINE 12"	FOOT	1,812	900	40	440		192		240
* 78008300	POLYUREA PAVEMENT MARKING, TYPE II - LETTERS AND SYMBOLS	FOOT	36	36						
* 78100105	RAISED REFLECTIVE PAVEMENT MARKER (BRIDGE)	EACH	356	144			42	108		62
78300100	PAVEMENT MARKING REMOVAL	SQ FT	200	80		80	40			
78300200	RAISED REFLECTIVE PAVEMENT MARKER REMOVAL	EACH	356	144			42	108		62
X5080600	MECHANICAL SPLICERS	EACH	64		32					32
X7011015	TRAFFIC CONTROL AND PROTECTION (EXPRESSWAYS)	L SUM	1	0.17	0.17	0.17	0.17	0.16		0.16
X7013820	TRAFFIC CONTROL SURVEILLANCE, EXPRESSWAYS	CAL DA	60	10	10	10	10	10		10
Z0001700	APPROACH SLAB REPAIR (FULL DEPTH)	SQ YD	7					7		
Z0001800	APPROACH SLAB REPAIR (PARTIAL DEPTH)	SQ YD	7					7		
Z0012754	STRUCTURAL REPAIR OF CONCRETE (DEPTH EQUAL TO OR LESS THAN 5 INCHES)	SQ FT	54	54						
Z0012755	STRUCTURAL REPAIR OF CONCRETE (DEPTH GREATER THAN 5 INCHES)	SQ FT	11	11						
Z0016002	DECK SLAB REPAIR (FULL DEPTH, TYPE ID)	SQ YD	33	7	2	2	5	4		13
Z0016200	DECK SLAB REPAIR (PARTIAL)	SQ YD	212	50	13	13	35	24		77
Z0030240	IMPACT ATTENUATORS, TEMPORARY (NON- REDIRECTIVE), TEST LEVEL 2	EACH	2	1	1					
Z0048665	RAILROAD PROTECTIVE LIABILITY INSURANCE	L SUM	1	0.25	0.25		0.25	0.25		
<del>Z0073200</del>	<del>TEMPORARY SHORING AND CRIBBING</del>	<del>EACH</del>	<del>15</del>	<del>2</del>	<del>8</del>					<del>5</del>
<del>X7030030</del>	<del>WET REFLECTIVE TEMPORARY TAPE TYPE III, 4 INCH</del>	<del>FOOT</del>	<del>5000</del>	<del>1,800</del>		<del>800</del>	<del>2,400</del>			
<del>X7030045</del>	<del>WET REFLECTIVE TEMPORARY TAPE TYPE III, 8 INCH</del>	<del>FOOT</del>	<del>7000</del>	<del>2,500</del>		<del>2,100</del>	<del>2,400</del>			

\* SPECIALTY ITEM

FILE NAME = J:\102908\_1-55\STRUCTURAL\sheet\160937-02-sum of quantities.dgn



**CHRISTIAN-ROGE & ASSOCIATES, INC.**

USER NAME = IDOT	DESIGNED - J.C.N./B.N.S.	REVISED -
PLOT SCALE = 50.0000' / IN.	CHECKED - B.N.S./J.C.N.	REVISED -
PLOT DATE = 10/12/2011	DRAWN - F.M.	REVISED -
	DATE - OCTOBER 12, 2011	REVISED -

**STATE OF ILLINOIS  
DEPARTMENT OF TRANSPORTATION**

**SUMMARY OF QUANTITIES  
F.A.I. RTE. I-55 OVER U.S. 41 / LAKE SHORE DRIVE**

SHEET NO. 53 OF 541 SHEETS

F.A.I. RTE.	SECTION	COUNTY	TOTAL SHEETS	SHEET NO.
55	2011-031-BR	COOK	41	3
CONTRACT NO. 60P37				
ILLINOIS FED. AID PROJECT				

Rev. 11-7-11

Rev.

**TEMPORARY SHORING & CRIBBING NOTES:**

1. DURING THE JACKING AND LOWERING OF THE BEAMS ALL TRAFFIC SHALL BE STOPPED ON THE AFFECTED SPAN.
2. SEE THE "KEEP EXPRESSWAY OPEN TO TRAFFIC" SPECIAL PROVISION FOR ALLOWABLE CLOSURE HOURS AND TIME LIMITS.
3. ON SN 016-1045, THE CONTRACTOR SHALL REMOVE THE JACKS DURING THE DETOUR OF THE RAMP TRAFFIC.
4. A PCMS SHALL BE IN PLACE 48 HOURS PRIOR TO AND DURING TEMPORARY SHORING AND CRIBBING TO PROVIDE ADVANCE CLOSURE AND DELAY WARNINGS.

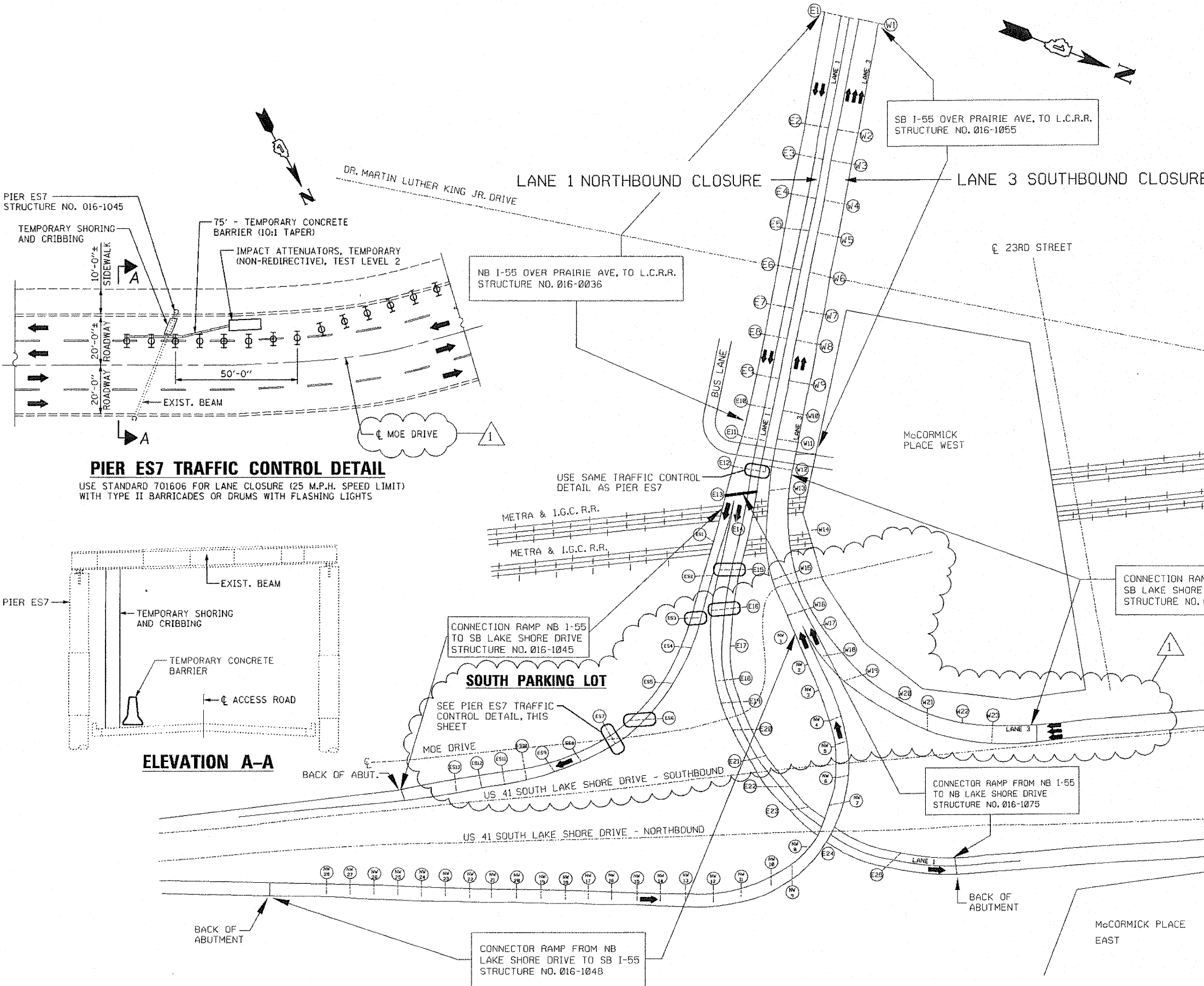

**LEGEND:**

 PIER REPAIR WITH TEMPORARY SHORING & CRIBBING

**PIER ES7 TRAFFIC CONTROL DETAIL**  
 USE STANDARD 701606 FOR LANE CLOSURE (25 M.P.H. SPEED LIMIT) WITH TYPE II BARRICADES OR DRUMS WITH FLASHING LIGHTS

**ELEVATION A-A**

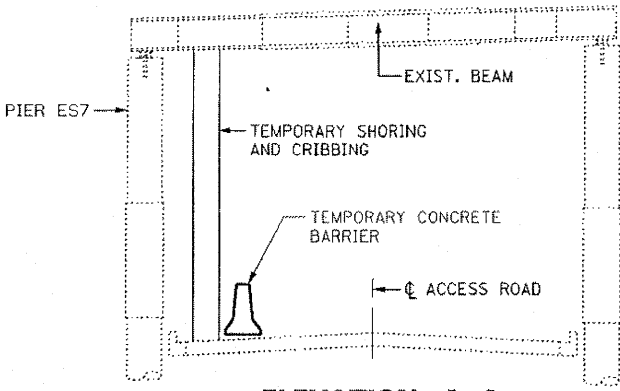

FILE NAME = I:\1022988\_1-55\STRUCTURAL\sheet\1022988-05A-shoring\_cribbing.dgn

	USER NAME = IDDT	DESIGNED - J.C.N./B.N.S.	REVISED - 1-ADDENDUM I 11-04-2011
	PLOT SCALE = 50.0000' / IN.	CHECKED - B.N.S./J.C.N./S.J.P.	REVISED -
	PLOT DATE = 11/4/2011	DRAWN - F.M.	REVISED -
		DATE - OCTOBER 12, 2011	REVISED -

**STATE OF ILLINOIS  
DEPARTMENT OF TRANSPORTATION**

**SUGGESTED STAGING FOR SHORING & CRIBBING  
F.A.I. RTE. I-55 OVER U.S. 41/LAKE SHORE DRIVE**

SHEET NO. 55A OF 541 SHEETS

F.A.I. RTE.	SECTION	COUNTY	TOTAL SHEETS	SHEET NO.
55	2011-031-BR	COOK	41	5A
CONTRACT NO. 60P37				
ILLINOIS FED. AID PROJECT				

**STAGE IB DECK PATCHING SCHEDULE**

STRUCTURE NO.	LANE NO.	PARTIAL-DEPTH PATCHING SQ. YD.	FULL-DEPTH PATCHING SQ. YD.	LANE CLOSURE
016-0036	---	---	---	
016-1045	---	---	---	
016-1048	---	---	---	
* 016-1052	2	113	0	LANE 2 SB
016-1055	---	---	---	
016-1075	2	117	0	LANE 2 NB

\* SPAN SP 1 TO SP 7

NOTE:  
SOME PARTIAL-DEPTH PATCHES MAY REQUIRE FULL-DEPTH PATCHING BASED ON FIELD CONDITIONS

**STAGE IB TRAFFIC CONTROL NOTES**

- LANE 2 NB (SN 016-1075) AND LANE 2 SB (SN 016-1052) CLOSURES WILL BE ALLOWED AS NOTED IN THE SPECIAL PROVISION "KEEPING EXPRESSWAY OPEN TO TRAFFIC".
- LANE 2 NB (SN 016-1075)
  - PATCHING DURING STAGE IB WILL ONLY BE ALLOWED IN THE RIGHT LANE OF (SN 016-1075) WHERE THE LANE IS ADJACENT TO THE PARAPET WALL.
  - TRAFFIC CONTROL:  
LANE 2 NB (SN 016-1075) SHALL BE CLOSED AS SHOWN. LOCATE WEAVE TO ALLOW PATCHING IN THE CORE AREA & LANE 2 ADJACENT TO THE CORE AREA.  
LANE 1 SHALL BE CLOSED AND TRAFFIC APPROACHING THE WORK ZONE SHALL BE REDUCED TO TWO LANES. THE TRAFFIC IN LANE 2 WILL THEN BE WEAVED INTO LANE 1 AS SHOWN ON THE DETAIL FOR "FREEWAY SINGLE LANE" & "MULTI-LANE WEAVE".  
WEAVE PLACEMENT - PLACE 4" YELLOW AND 8" WHITE PAVEMENT MARKING TAPE, TYPE III AND REMOVE CONFLICTING PAVEMENT MARKINGS.
- LANE 2 SB (SN 016-1052)
  - PATCHING DURING STAGE IB WILL ONLY BE ALLOWED IN THE LEFT LANE OF (SN 016-1052), WHERE THE LANE IS ADJACENT TO THE PARAPET WALL.
  - TRAFFIC CONTROL:  
LANE 2 SB (SN 016-1052) SHALL BE CLOSED AS SHOWN.  
THE RIGHT LANE OF THE TWO LANE APPROACH TO RAMP FROM S.B. U.S. 41 TO S.B. I-55 SHALL BE CLOSED.  
THE TRAFFIC WILL THEN WEAVE INTO THE RIGHT LANE (LANE 3) OF THE RAMP BEFORE THE WORK ZONE AS SHOWN ON THE "FREEWAY SINGLE LANE WEAVE" DETAIL.

**LEGEND:**

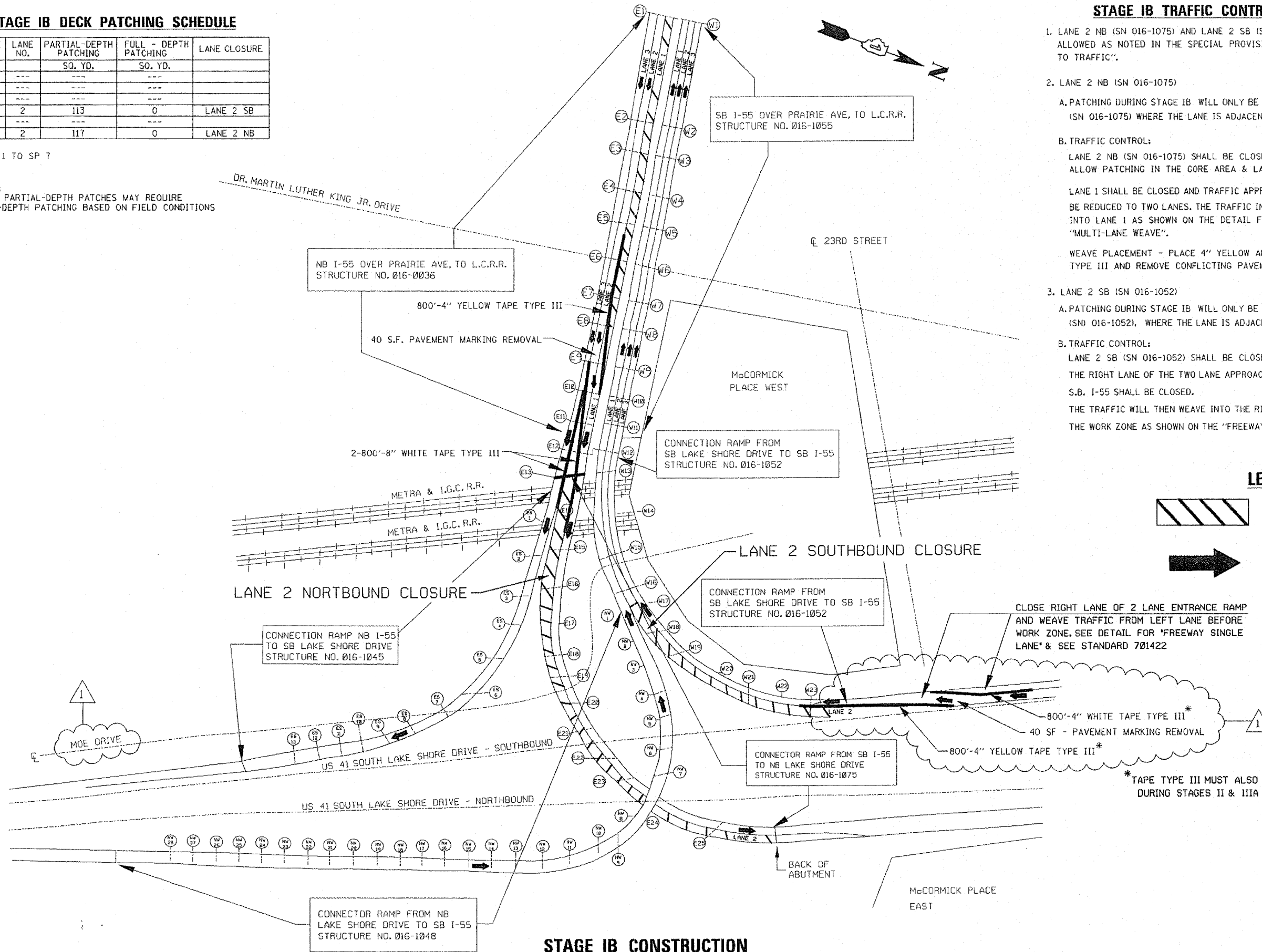
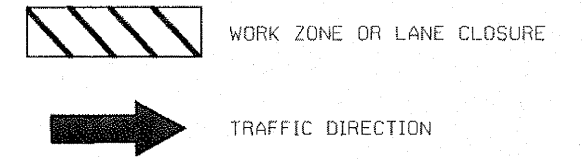

**STAGE IB CONSTRUCTION**

FILE NAME: I:\102508\_I-55\STRUCTURAL\sheet\016SP37-06-stage\_IB.dgn



USER NAME = IDOT	DESIGNED - J.C.N./B.N.S.	REVISED - 1-ADDDENDUM 1 11-04-2011
PLLOT SCALE = 50.0000' / IN.	CHECKED - B.N.S./J.C.N.	REVISED -
PLLOT DATE = 11/3/2011	DRAWN - F.M.	REVISED -
	DATE - OCTOBER 12, 2011	REVISED -

STATE OF ILLINOIS  
DEPARTMENT OF TRANSPORTATION

SUGGESTED STAGE IB CONSTRUCTION  
F.A.I. RTE. I-55 OVER U.S. 41 / LAKE SHORE DRIVE

SHEET NO. 56 OF 541 SHEETS

F.A.I. RTE.	SECTION	COUNTY	TOTAL SHEETS	SHEET NO.
55	2011-031-BR	COOK	41	6
CONTRACT NO. 60P37			ILLINOIS FED. AID PROJECT	



**STAGE II DECK PATCHING SCHEDULE**

STRUCTURE NO.	LANE NO.	PARTIAL-DEPTH PATCHING SQ. YD.	FULL-DEPTH PATCHING SQ. YD.	LANE CLOSURE
016-0036	2	75	0	LANE 2 NB
016-1045	---	---	---	---
016-1048	---	---	---	---
016-1052	2	113	0	LANE 2 SB
016-1055	2	92	0	LANE 2 SB
016-1075	2	---	---	---

NOTE:  
SOME PARTIAL-DEPTH PATCHES MAY REQUIRE FULL-DEPTH PATCHING BASED ON FIELD CONDITIONS

**STAGE II TRAFFIC CONTROL NOTES:**

- LANE 2 NB (SN 016-0036) AND LANE 2 SB (SN 016-1055) CLOSURES WILL BE ALLOWED AS NOTED IN THE SPECIAL PROVISION "KEEPING EXPRESSWAY OPEN TO TRAFFIC".
- LANE 2 NB (SN 016-0036):
  - PATCHING DURING STAGE II WILL ONLY BE ALLOWED DURING THE NIGHTTIME CLOSURE OF LANE 1 NB.
  - TRAFFIC CONTROL:
    - PRIOR TO WORK ZONE SET UP "CENTER LANE CLOSURE" AS SHOWN ON "CENTER LANE CLOSURE" DETAIL.
    - DURING CONSTRUCTION ACTIVITIES LANE 1 SHALL BE CLOSED NIGHTLY AND ONE LANE OF TRAFFIC SHALL BE MAINTAINED IN LANE 3.
    - DURING THE PATCHING ON LANE 2, I-55 NB TO US 41 NB RAMP SHALL BE CLOSED NIGHTLY AND RAMP TRAFFIC SHALL BE DETOURED.
    - DURING PERIODS OF NO CONSTRUCTION ACTIVITIES LANE 1 SHALL BE OPEN AND LANE 2 SHALL BE CLOSED THROUGH THE CORE SEPARATING LANE 2 AND LANE 3.
    - THE TRAFFIC SHALL BE MAINTAINED AS SHOWN ON THE "TRAFFIC CONTROL DETAILS FOR FREEWAY CENTER LANE CLOSURE" DETAIL.
- LANE 2 SB (SN 016-1055):
  - PATCHING DURING STAGE II WILL ONLY BE ALLOWED DURING THE NIGHTTIME CLOSURE OF LANE 1 SB.
  - TRAFFIC CONTROL:
    - DURING CONSTRUCTION ACTIVITIES, ONE LANE OF TRAFFIC SHALL BE MAINTAINED IN LANE 3 SN 016-1055).
    - THE LANE CLOSURES FOR THE APPROACH TO SN 016-1052 SHALL BE THE SAME AS SHOWN IN STAGE 1B. THIS LANE CONFIGURATION SHALL BE MAINTAINED UNTIL LANE 2 IS OPENED TO TRAFFIC.
    - DURING THE CLOSURE OF LANE 1 DETOUR THE RAMP TRAFFIC.
    - DURING PERIODS OF NO CONSTRUCTION ACTIVITIES IN LANE 2, LANE 1 SHALL BE OPENED TO TRAFFIC.

**PORTABLE CHANGEABLE MESSAGE SIGNS AT I-55 NB**

- NB US 41 USE DETOUR
- USE DURING NIGHTLY LANE 1 CLOSURE
- NB US 41 LEFT LANE ONLY
- USE DAILY
- SB US 41 RIGHT LANE ONLY
- USE DAILY

**\*FOR CENTER LANE CLOSURE AND WEAVE:**

- PLACE: 900' - 8" WHITE TAPE TYPE III  
1,000' - 4" YELLOW TAPE TYPE III  
40 SF - PAVEMENT MARKING REMOVAL
- PLACE I-55 NB PCMS PRIOR TO LANE CLOSURES AND WEAVE

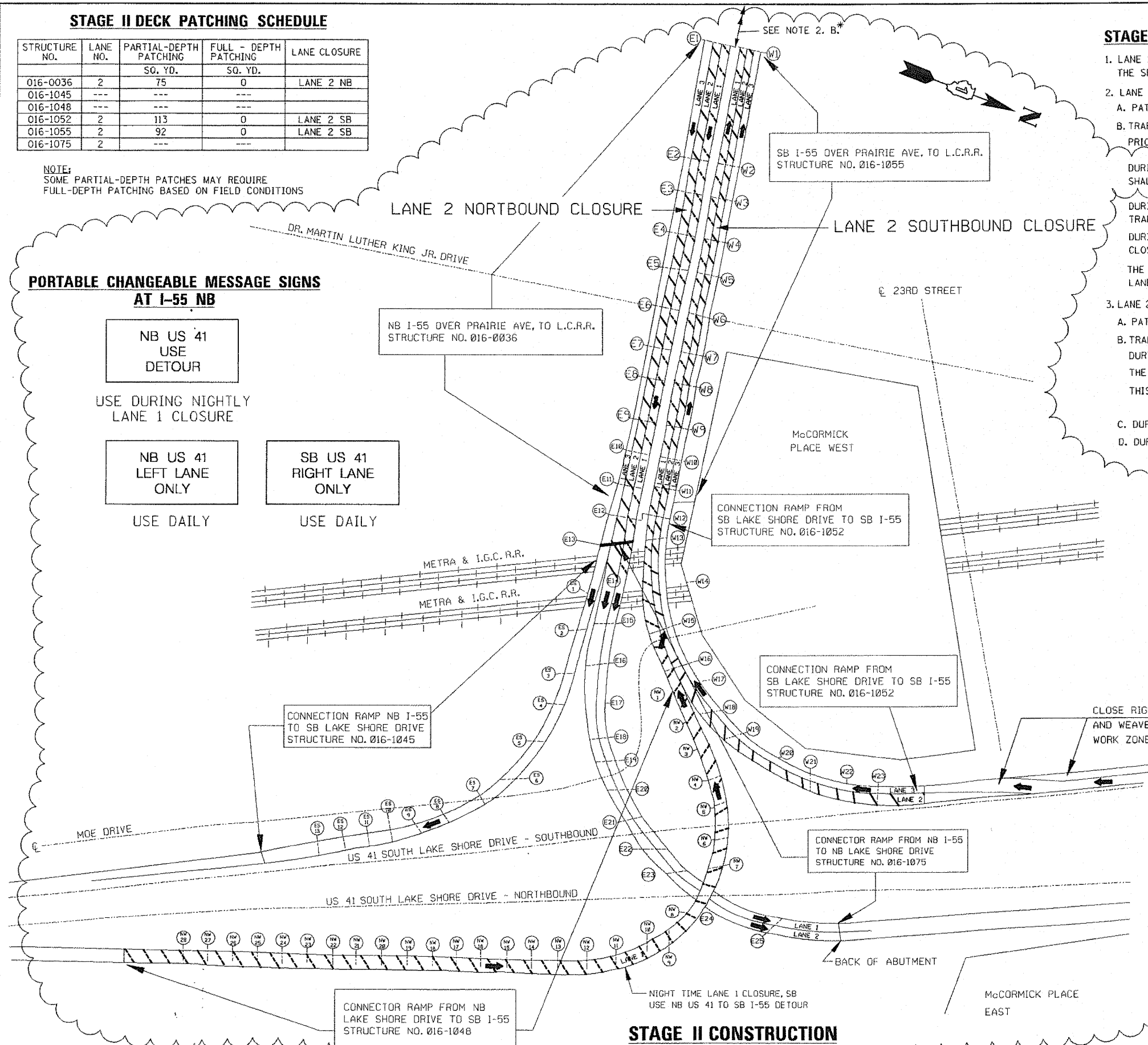

CLOSE RIGHT LANE OF 2 LANE ENTRANCE RAMP AND WEAVE TRAFFIC FROM LEFT LANE BEFORE WORK ZONE. SEE STAGE 1B. SEE SHT. 06.

**LEGEND:**

- WORK ZONE OR LANE CLOSURE
- TEMPORARY NIGHT TIME LANE 1 CLOSURE FOR LANE 2 CONSTRUCTION ACTIVITIES
- TRAFFIC DIRECTION

FILE NAME = R:\102208\I-55 STRUCTURAL\sheet\102208-07-stage-II.dgn

**STAGE IIIA DECK PATCHING SCHEDULE**

STRUCTURE NO.	LANE NO.	PARTIAL-DEPTH PATCHING SO. YD.	FULL-DEPTH PATCHING SO. YD.	LANE CLOSURE
016-0036	3	282	0	LANE 3 NB
016-1045	---	---	---	
016-1048	---	---	---	
016-1052	1	73	0	LANE 1 SB
016-1055	1	12	0	LANE 1 SB
016-1075	---	---	---	

NOTE:  
SOME PARTIAL-DEPTH PATCHES MAY REQUIRE FULL-DEPTH PATCHING BASED ON FIELD CONDITIONS

**STAGE IIIA TRAFFIC CONTROL NOTES**

- LANE 2 NB (SN 016-0036) AND LANE 1 SB (SN 016-1055) CLOSURES WILL BE ALLOWED AS NOTED IN THE SPECIAL PROVISION "KEEPING EXPRESSWAY OPEN TO TRAFFIC".
- LANE 3 NB (SN 016-0036):
  - PATCHING DURING STAGE IIIA WILL BE DONE IN LANE 3 NB.
  - TRAFFIC CONTROL:  
CLOSE LANE 3 NB (SN 016-0036) AFTER THE CERMAK EXIT. USE STANDARDS 701400 & 701401.  
FOR SB & NB RYAN EXIT RAMP, USE STANDARD 701411, APPLICATION 2 AND LEAD TRAFFIC TO LANE 2.  
CLOSE ENTRANCE RAMP FROM STATE STREET TO NB I-55. SEE ENTRANCE RAMP CLOSURE DETAIL AND DETOUR PLANS.  
TO PROVIDE ACCESS TO EXIT RAMP TO DR. MARTIN LUTHER KING, JR. DRIVE, USE STANDARD 701411, APPLICATION 4.
- LANE 1 SB (SN 016-0055):
  - PATCHING DURING STAGE IIIA WILL BE DONE IN LANE 1 SB.
  - TRAFFIC CONTROL:  
CLOSE LANE 3 NB (SN 016-1048) USING SINGLE LANE WEAVE DETAIL ON (SN 016-1048). LEAD TRAFFIC TO (SN 016-1052) LANE 2.  
CLOSE LANE 2 SB (SN 016-1052) AS SHOWN IN STAGE IB. SEE SHEET NO. 6.

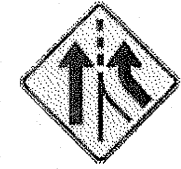
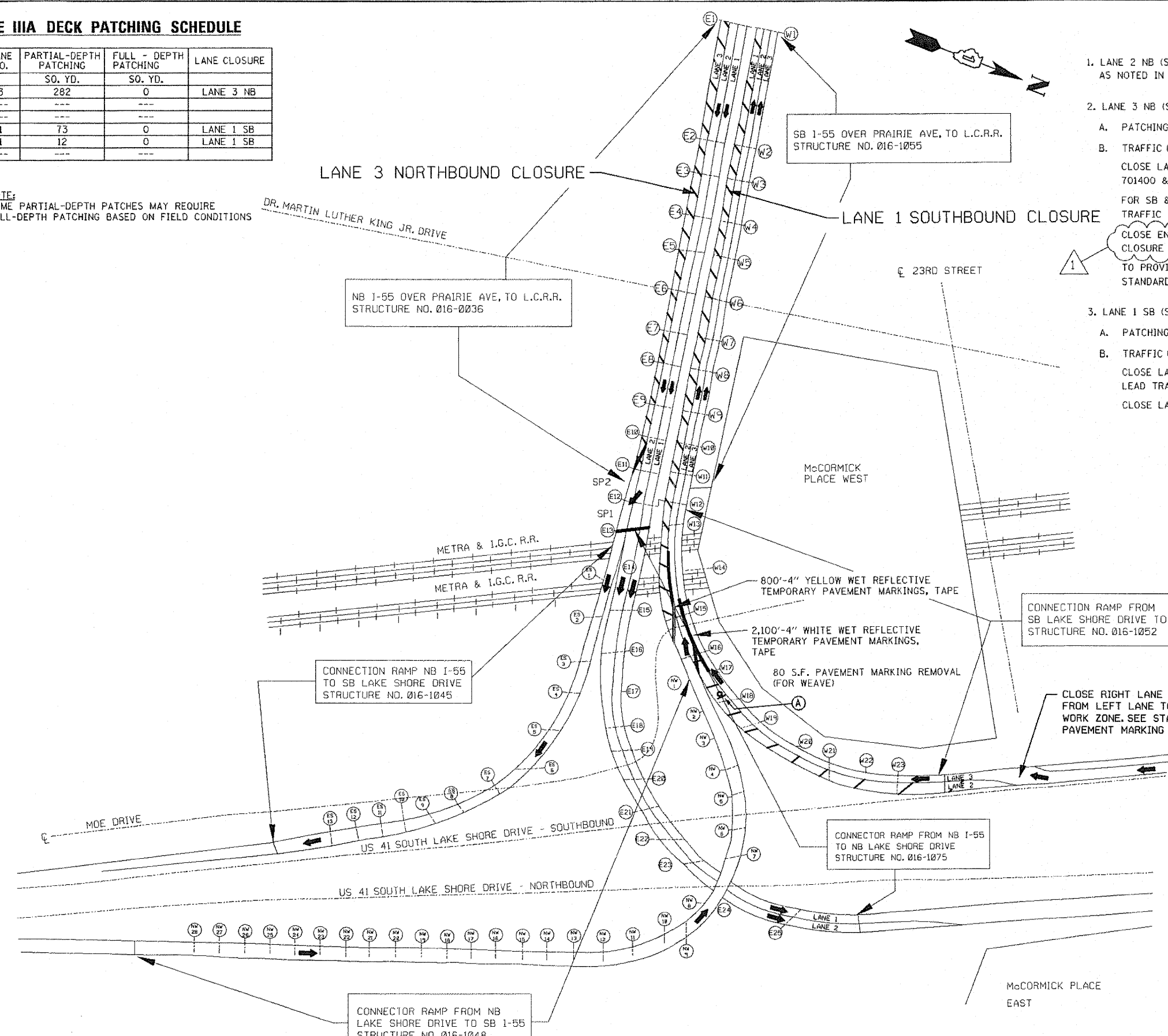

W4-3  
(48 x 48)  
A

**LEGEND:**

- WORK ZONE OR LANE CLOSURE
- TRAFFIC DIRECTION

**STAGE IIIA CONSTRUCTION**

FILE NAME: J:\1102988\1-55\STRUCTURAL\sheet\0160P37-08-stage IIIA.dgn

**CHRISTIAN-ROGE & ASSOCIATES, INC.**

USER NAME = 100T	DESIGNED - J.C.N./B.N.S.	REVISED - ADDENDUM I 11-04-2011
PLOT SCALE = 50.0000' / 1" IN.	CHECKED - B.N.S./J.C.N.	REVISED -
PLOT DATE = 11/3/2011	DRAWN - F.M.	REVISED -
	DATE - OCTOBER 12, 2011	REVISED -

**STATE OF ILLINOIS DEPARTMENT OF TRANSPORTATION**

**SUGGESTED STAGE IIIA CONSTRUCTION**  
F.A.I. RTE. I-55 OVER U.S. 41 / LAKE SHORE DRIVE

SHEET NO. 58 OF 541 SHEETS

F.A.I. RTE.	SECTION	COUNTY	TOTAL SHEETS	SHEET NO.
55	2011-031-BR	COOK	41	8
CONTRACT NO. 60P37				
ILLINOIS FED. AID PROJECT				

- A**  
[DETOUR]  
M4-8  
(24 x 12)
- B**  
[END DETOUR]  
M4-8a  
(24 x 18)
- C**  
[SOUTH]  
M3-3  
(21 x 9)
- D**  
[INTERSTATE 55]  
M1-1  
(24 x 24)
- E**  
[41]  
M1-4  
(24 x 24)
- F**  
[←]  
M5-1(L)  
(21 x 15)
- G**  
[←]  
M6-1(L)  
(21 x 15)
- H**  
[↑]  
M6-3  
(21 x 15)
- I**  
[↗]  
M6-2(R)  
(21 x 15)
- J**  
[↗]  
M5-2  
(21 x 15)

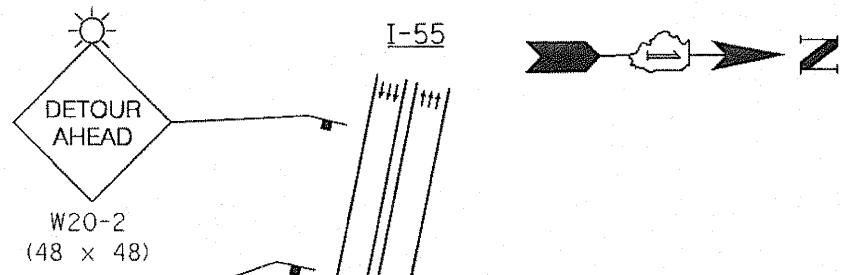

- NOTES:**
- ALL SIGN DIMENSIONS ARE SHOWN IN INCHES.
  - THE COST OF PROVIDING AND REMOVING THE DETOUR SIGNING SHALL BE INCLUDED IN THE BID PRICE FOR "TRAFFIC CONTROL AND PROTECTION (EXPRESSWAYS)".
  - ALL DETOUR AND DIRECTION SIGNS SHALL BE ORANGE WITH BLACK LETTERS & SYMBOLS.
  - SIGN M1-1 SHALL BE BLUE AND RED WITH WHITE LETTERS. SIGN M1-4 SHALL BE WHITE WITH BLACK LETTERS.

SB U.S. 41  
(S LAKE SHORE DR)  
RAMP CLOSED  
USE 18 TH ST  
USE PORTABLE  
CHANGEABLE  
MESSAGE SIGN

STAGE III B  
RAMP & LANE 3 CLOSURES

CONNECTOR RAMP FROM  
NB I-55 TO SB US 41  
STRUCTURE NO. 016-1045

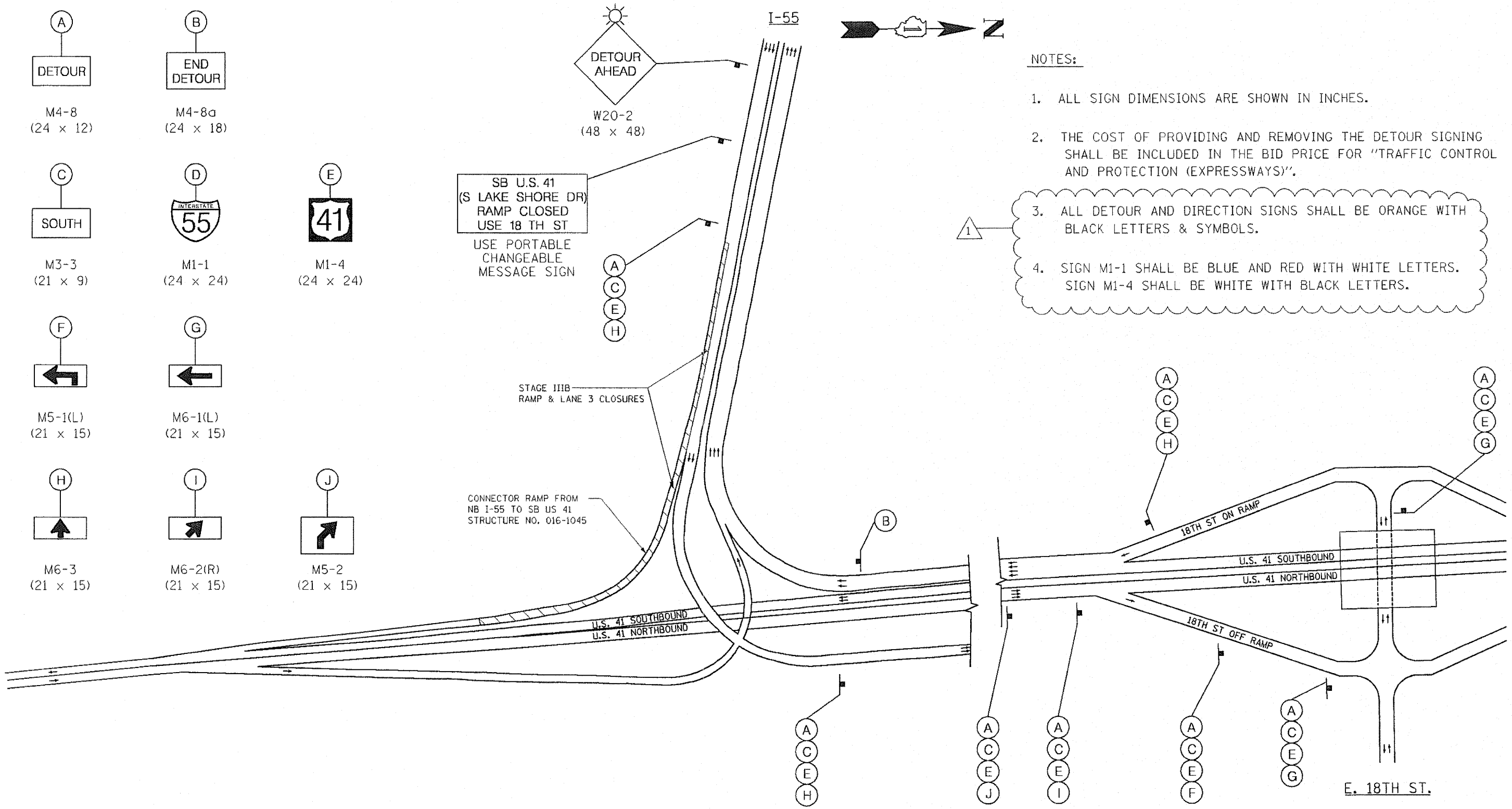

**DETOUR STAGE III B**  
N.B. I-55 TO S.B. U.S. 41

FILE NAME: I:\102408.I-55.STRUCTURAL\shes\3160937-18-detour-11TB.dgn

	USER NAME = IDGT	DESIGNED - J.C.N./B.N.S.	REVISED - 1 ADDENDUM 1 11-04-2011	<b>STATE OF ILLINOIS</b> <b>DEPARTMENT OF TRANSPORTATION</b>	<b>DETOUR PLAN - STAGE III B</b> <b>F.A.I. RTE. I-55 OVER U.S. 41 / LAKE SHORE DRIVE</b>	F.A.I. RTE. 55	SECTION 2011-031-BR	COUNTY COOK	TOTAL SHEETS 41	SHEET NO. 10
	PLOT SCALE = 99.9999' / IN.	DRAWN - F.M.	DATE - OCTOBER 12, 2011			CONTRACT NO. 60P37			ILLINOIS FED. AID PROJECT	
SHEET NO. 510 OF 541 SHEETS										



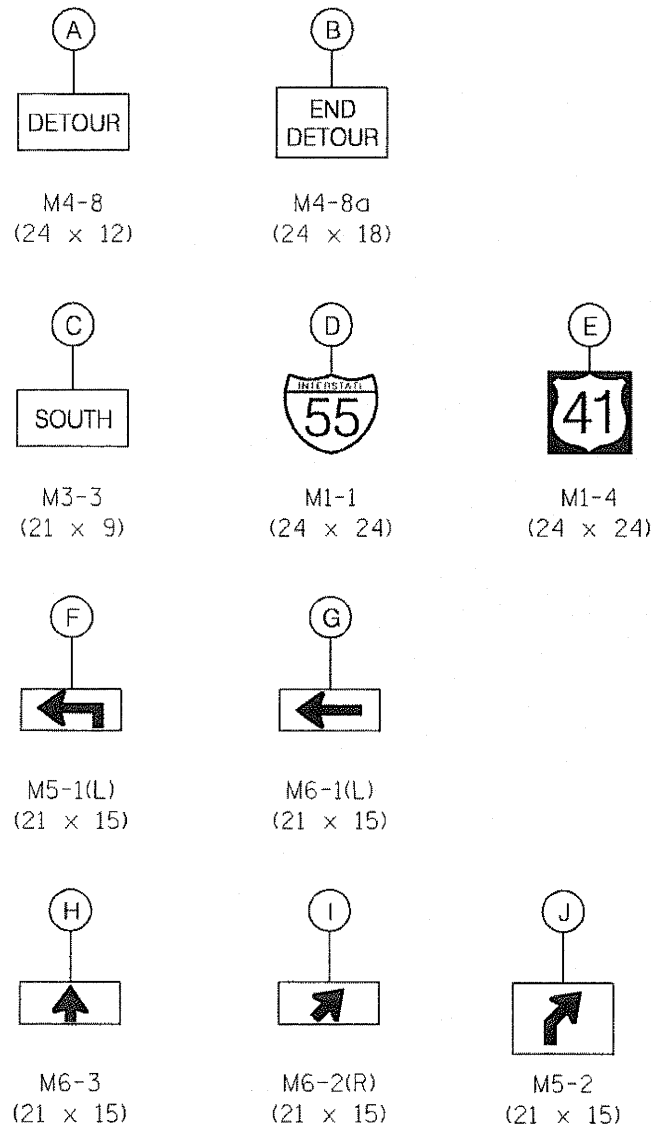

**NOTES:**

1. ALL SIGN DIMENSIONS ARE SHOWN IN INCHES.
2. THE COST OF PROVIDING AND REMOVING THE DETOUR SIGNING SHALL BE INCLUDED IN THE BID PRICE FOR "TRAFFIC CONTROL AND PROTECTION (EXPRESSWAYS)".
3. ALL DETOUR AND DIRECTION SIGNS SHALL BE ORANGE WITH BLACK LETTERS & SYMBOLS.
4. SIGN M1-1 SHALL BE BLUE AND RED WITH WHITE LETTERS. SIGN M1-4 SHALL BE WHITE WITH BLACK LETTERS.

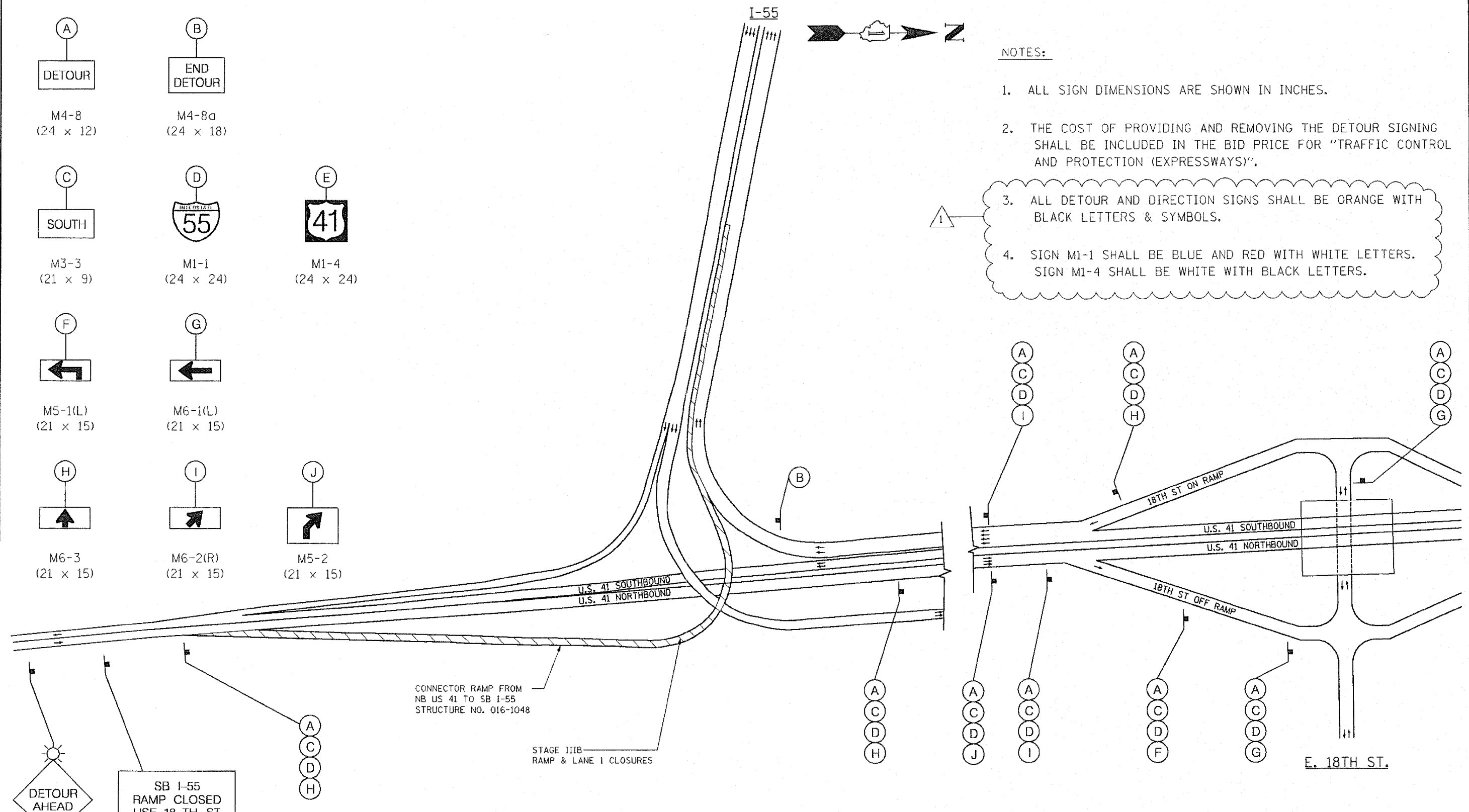

NIGHT TIME DETOUR PLAN - STAGE II & STAGE III B  
N.B. U.S. 41 TO S.B. I-55

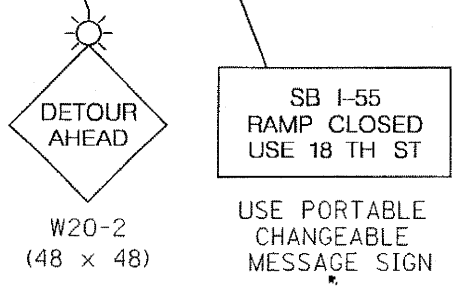

FILE NAME = I:\102506\_I-55\_STRUCTUREAL\sheet\0160P37-11-detour-11B.dgn

	USER NAME = IDDT	DESIGNED - J.C.N./B.N.S.	REVISED - 1-ADDENDUM 1 11-04-2011
	PLOT SCALE = 99.9999 / 1" = 100'	CHECKED - B.N.S./J.C.N.	REVISED -
	PLOT DATE = 11/3/2011	DRAWN - F.M.	REVISED -
		DATE - OCTOBER 12, 2011	REVISED -

**STATE OF ILLINOIS  
DEPARTMENT OF TRANSPORTATION**

**NIGHT TIME DETOUR PLAN - STAGE II & STAGE III B  
F.A.I. RTE. I-55 OVER U.S. 41 / LAKE SHORE DRIVE**

F.A.I. RTE. 55	SECTION 2011-031-BR	COUNTY COOK	TOTAL SHEETS 41	SHEET NO. 11
CONTRACT NO. 60P37				
ILLINOIS FED. AID PROJECT				

SHEET NO. S11 OF S41 SHEETS

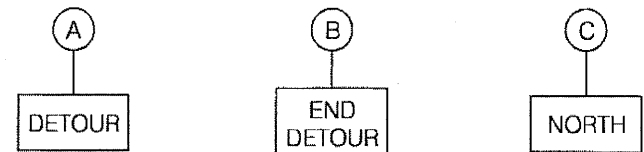

M4-8 (24 x 12)  
 M4-8a (24 x 18)  
 M3-3 (21 x 9)

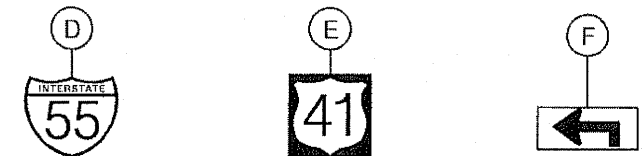

M1-1 (24 x 24)  
 M1-4 (24 x 24)  
 M5-1(L) (21 x 15)

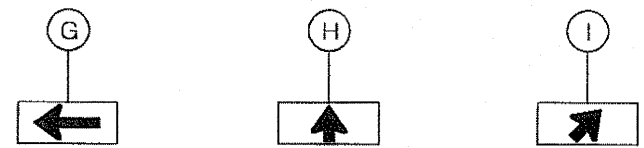

M6-1(L) (21 x 15)  
 M6-3 (21 x 15)  
 M6-2(R) (21 x 15)

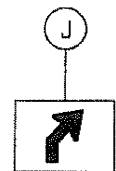

M5-2 (21 x 15)

NOTES:

1. ALL SIGN DIMENSIONS ARE SHOWN IN INCHES.
2. THE COST OF PROVIDING AND REMOVING THE DETOUR SIGNING SHALL BE INCLUDED IN THE BID PRICE FOR "TRAFFIC CONTROL AND PROTECTION (EXPRESSWAYS)".
3. ALL DETOUR AND DIRECTION SIGNS SHALL BE ORANGE WITH BLACK LETTERS & SYMBOLS.
4. SIGN M1-1 SHALL BE BLUE AND RED WITH WHITE LETTERS. SIGN M1-4 SHALL BE WHITE WITH BLACK LETTERS.

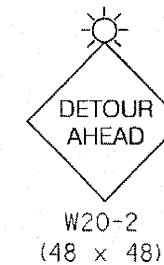

NB U.S. 41 (N LAKE SHORE DR) RAMP CLOSED USE 31ST STREET

PORTABLE CHANGEABLE MESSAGE SIGN



STAGE II NIGHTLY LANES 1 & 2 CLOSURES

CONNECTOR RAMP FROM NB I-55 TO SB US 41 STRUCTURE NO. 016-1045

U.S. 41 SOUTHBOUND  
 U.S. 41 NORTHBOUND

SEE SHEET NO. 11B MATCHLINE 31ST STREET

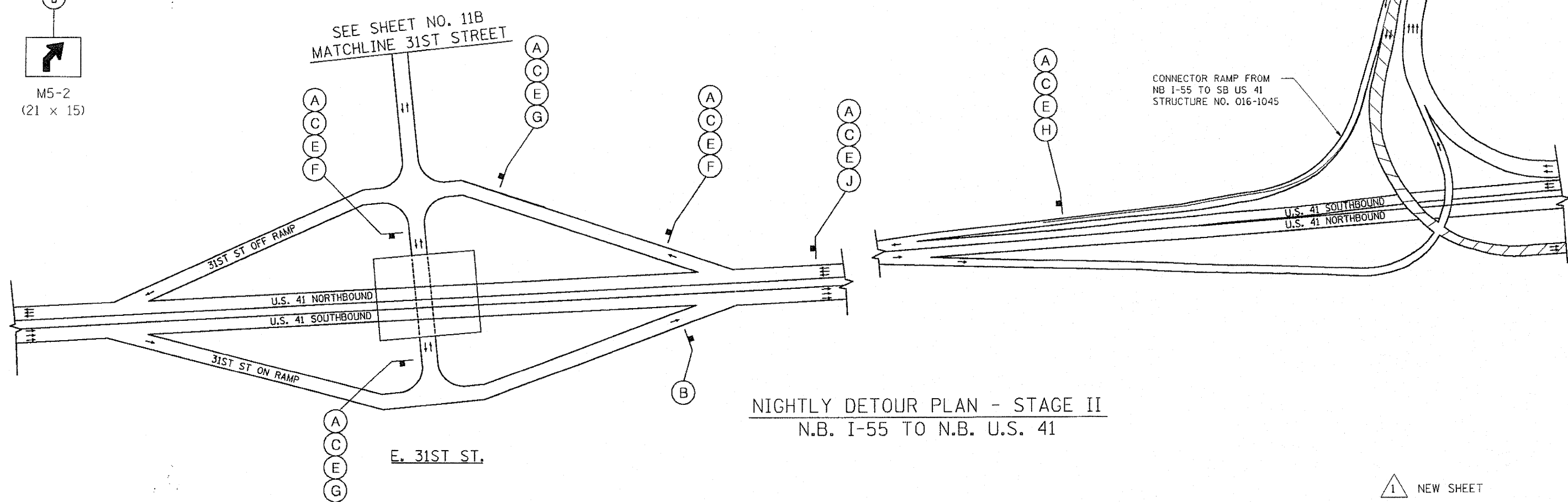

NIGHTLY DETOUR PLAN - STAGE II  
 N.B. I-55 TO N.B. U.S. 41

1 NEW SHEET

FILE NAME = I:\102908\I-55\STRUCTURAL\sheet\102908-11a-detour\_11.dgn

	USER NAME = 100T	DESIGNED - J.C.N./B.N.S.	REVISED - ADDENDUM 1 11-04-2011
	PLOT SCALE = 99.9999' / IN.	CHECKED - B.N.S./J.C.N./S.J.P.	REVISED -
	PLOT DATE = 11/4/2011	DRAWN - F.M.	REVISED -
		DATE - NOVEMBER 4, 2011	REVISED -

STATE OF ILLINOIS  
 DEPARTMENT OF TRANSPORTATION

NIGHTLY DETOUR PLAN - STAGE II  
 F.A.I. RTE. I-55 OVER U.S. 41 / LAKE SHORE DRIVE

F.A.I. RTE.	SECTION	COUNTY	TOTAL SHEETS	SHEET NO.
55	2011-031-BR	COOK	41	11A
				CONTRACT NO. 60P37
ILLINOIS FED. AID PROJECT				

SHEET NO. 511A OF 541 SHEETS

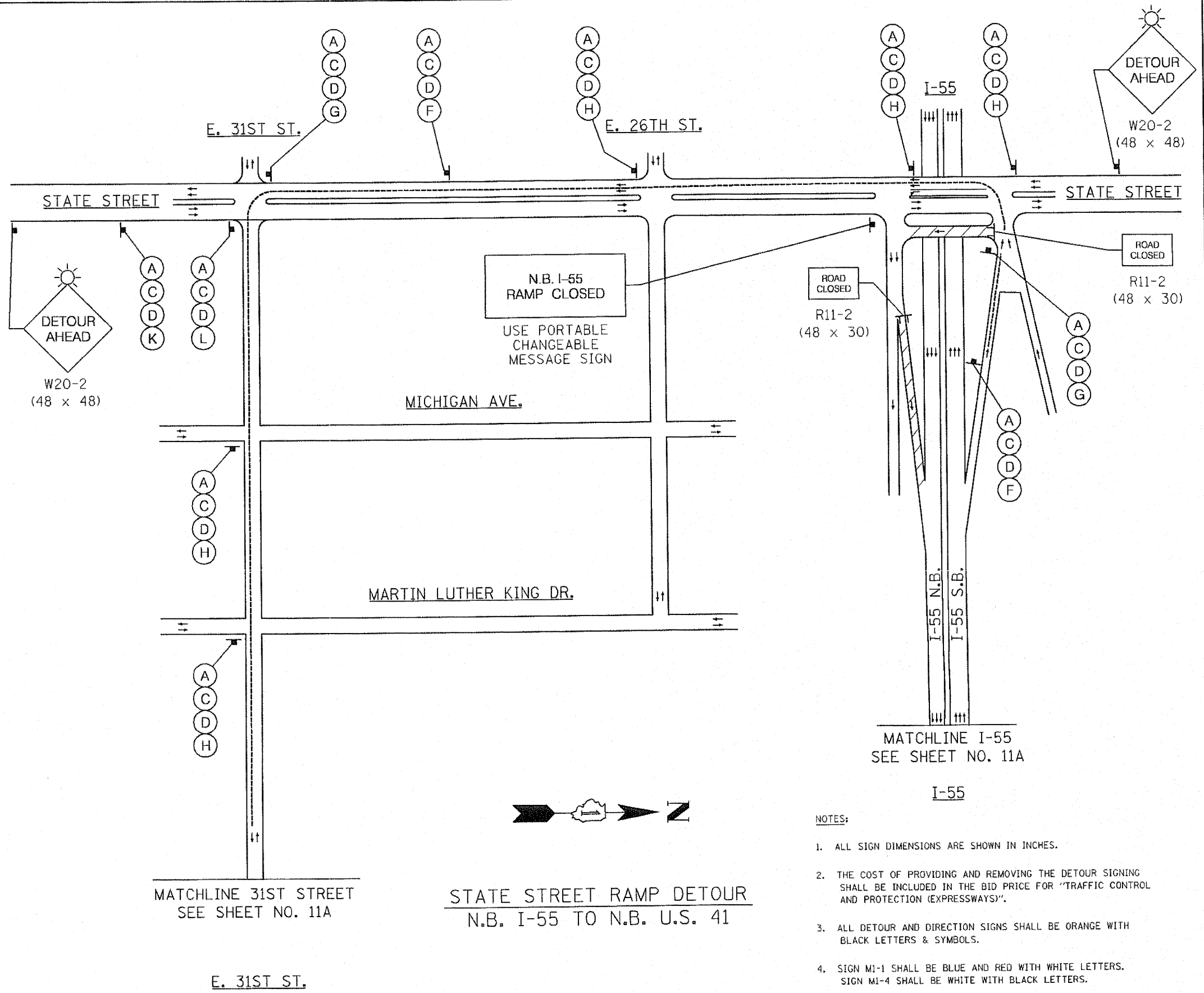
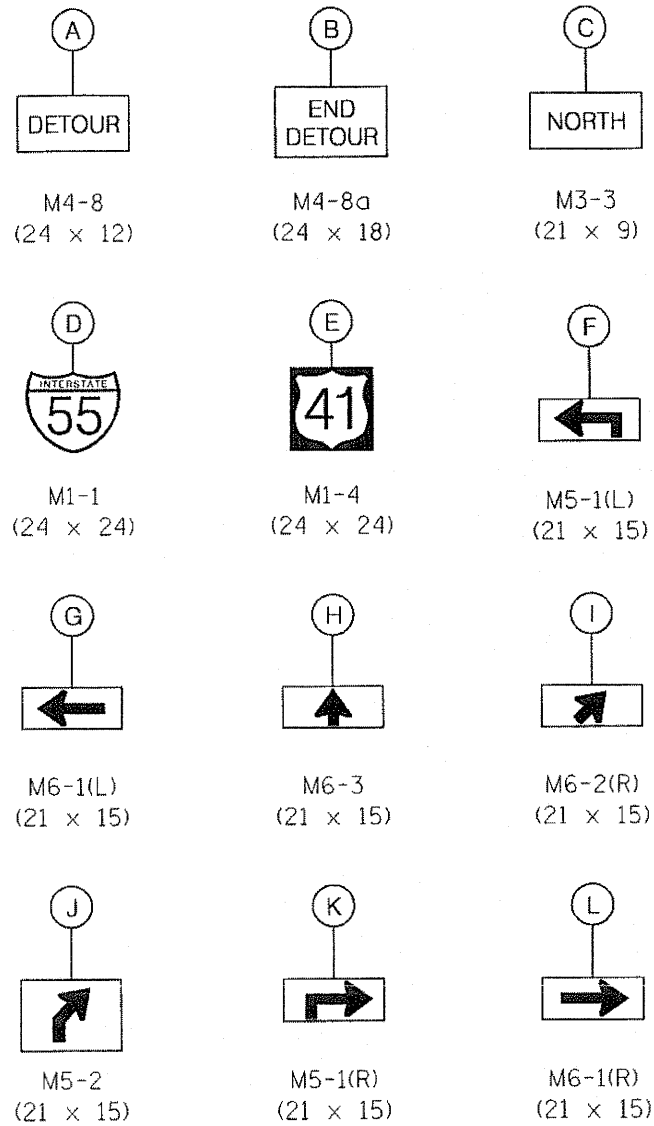

- NOTES:
- ALL SIGN DIMENSIONS ARE SHOWN IN INCHES.
  - THE COST OF PROVIDING AND REMOVING THE DETOUR SIGNING SHALL BE INCLUDED IN THE BID PRICE FOR "TRAFFIC CONTROL AND PROTECTION (EXPRESSWAYS)".
  - ALL DETOUR AND DIRECTION SIGNS SHALL BE ORANGE WITH BLACK LETTERS & SYMBOLS.
  - SIGN M1-1 SHALL BE BLUE AND RED WITH WHITE LETTERS. SIGN M1-4 SHALL BE WHITE WITH BLACK LETTERS.

1 NEW SHEET

FILE NAME = I:\102906.I-55\STRUCTURAL\shes\106937-11B-sta.co.st.detour.dgn

	USER NAME = IDDT	DESIGNED - J.C.N./B.N.S.	REVISED - 1-ADDENDUM I 11-04-2011	<b>STATE OF ILLINOIS</b> <b>DEPARTMENT OF TRANSPORTATION</b>	<b>STATE STREET RAMP DETOUR</b> <b>F.A.I. RTE. I-55 OVER U.S. 41 / LAKE SHORE DRIVE</b>	F.A.I. RTE.	SECTION	COUNTY	TOTAL SHEETS	SHEET NO.
	PLOT SCALE = 99.9999' / IN.	CHECKED - B.N.S./J.C.N./S.J.P.	DRAWN - F.M.			DATE - NOVEMBER 4, 2011	55	2011-031-BR	COOK	41
	PLOT DATE = 11/4/2011					ILLINOIS FED. AID PROJECT		CONTRACT NO. 60P37		