

SN 016-1045 (N.B.)
SN 016-1052 (S.B.)

SN 016-1055 (S.B.)

ELEVATION - S.B. ROADWAY

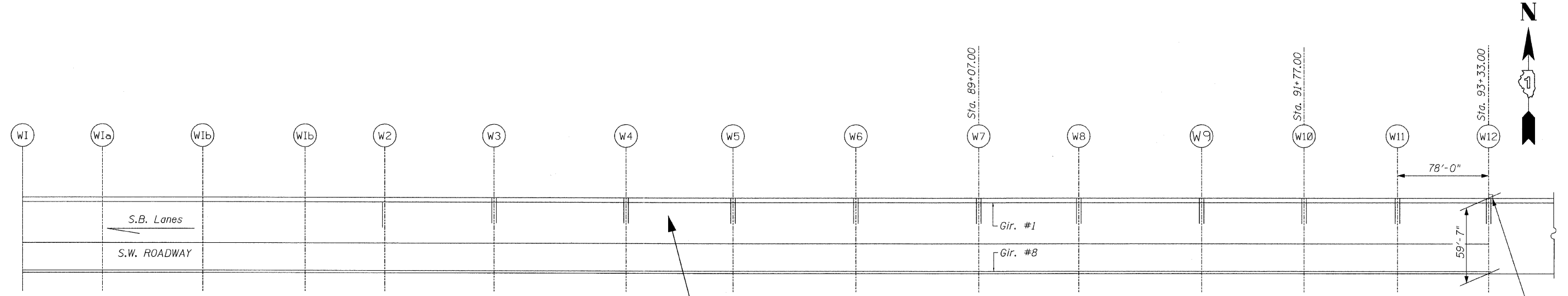

STRUCTURE NO. 016-1055

PLAN

**APPROACH SLAB REPAIR NOTE:
(WEST OF THE BRIDGE)**

- 7 SY(±) - OF APPROACH SLAB REPAIR (FULL DEPTH) &
- 7 SY(±) - OF APPROACH SLAB REPAIR (PARTIAL DEPTH) IS REQUIRED

Sign Truss support
Typical at East Side of
Joints at Piers E10 & E12

**GENERAL PLAN & ELEVATION
F.A.I. RTE. I-55 OVER
U.S. 41/LAKE SHORE DRIVE
COOK COUNTY
STRUCTURE NO. 016-1055**

FILE NAME = JA\102908_1-55\STRUCTURAL\sheet\016\016-1055\016-1055-23-GPE.dgn

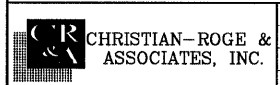

USER NAME = IDOT	DESIGNED - J.C.N./B.N.S.	REVISED -
PLOT SCALE = 50.0000' / IN.	CHECKED - B.N.S./J.C.N.	REVISED -
PLOT DATE = 10/12/2011	DRAWN - F.M.	REVISED -
	DATE - OCTOBER 12, 2011	REVISED -

**STATE OF ILLINOIS
DEPARTMENT OF TRANSPORTATION**

SHEET NO. S23 OF S41 SHEETS

F.A.I. RTE.	SECTION	COUNTY	TOTAL SHEETS	SHEET NO.
55	2011-031-BR	COOK	41	23
				CONTRACT NO. 60P37
[ILLINOIS] FED. AID PROJECT				