

ROUTE	SECTION	COUNTY	TOTAL SHEETS	SHEET NUMBER
VARIOUS	2011-051-1	COOK & DUPAGE	72	29

CONTRACT NO. 60P61

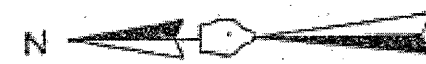

PLAN

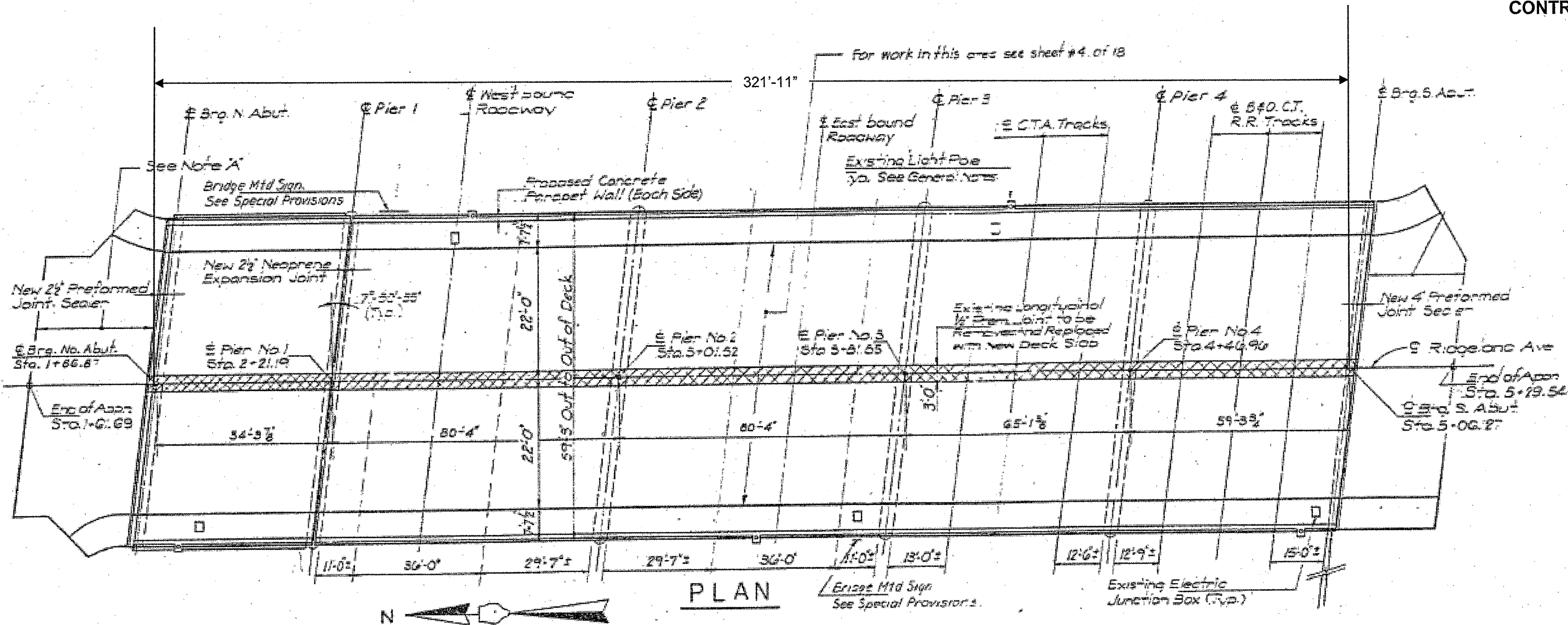
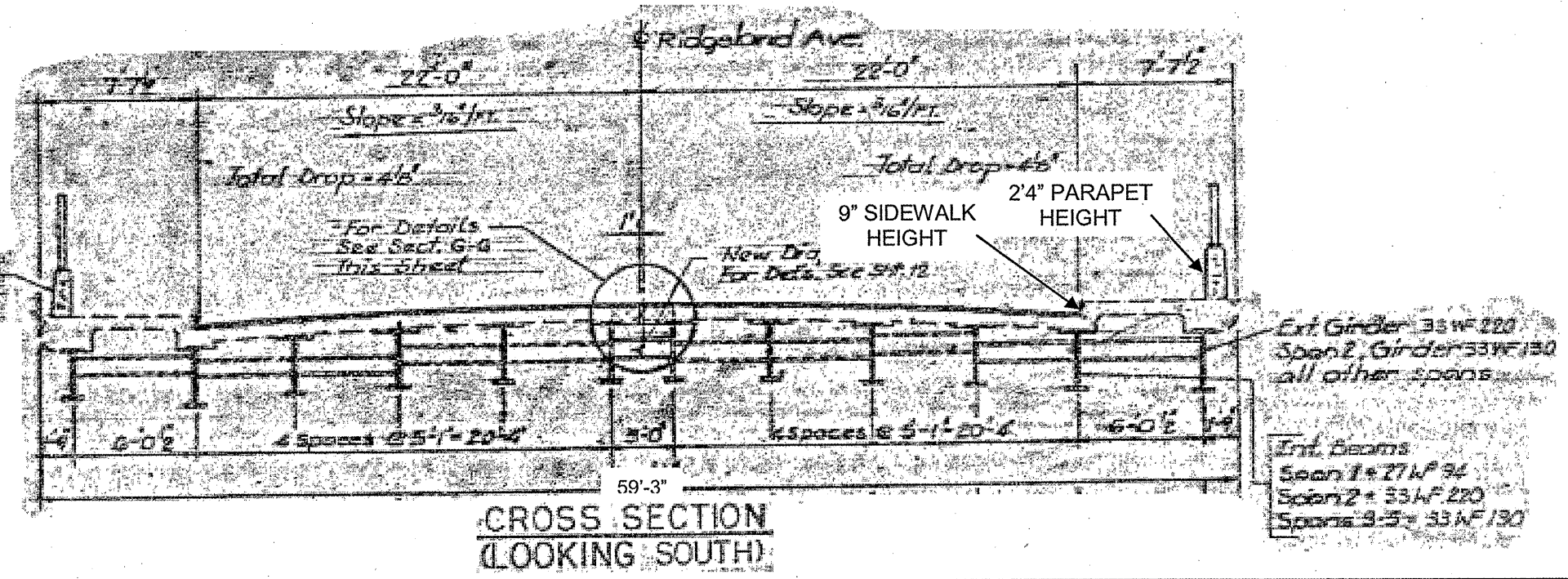

CROSS SECTION
(LOOKING SOUTH)

**FOR
INFORMATION
ONLY**

ILLINOIS DEPARTMENT OF
TRANSPORTATION

EXISTING PLANS & CROSS SECTION
LOCATION 14 (SN 016-0710)
RIDGELAND AVE OVER I-290, CTA, CSX RR
SHEET 1 OF 1