

| | | | | |
|---------|-------------|--------|--------------|--------------|
| ROUTE | SECTION | COUNTY | TOTAL SHEETS | SHEET NUMBER |
| VARIOUS | 2011-060-BR | COOK | 49 | 14 |

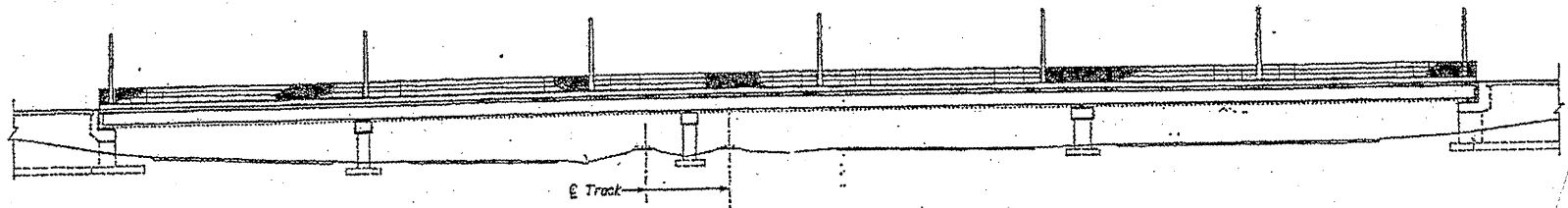

ELEVATION
(Looking West)

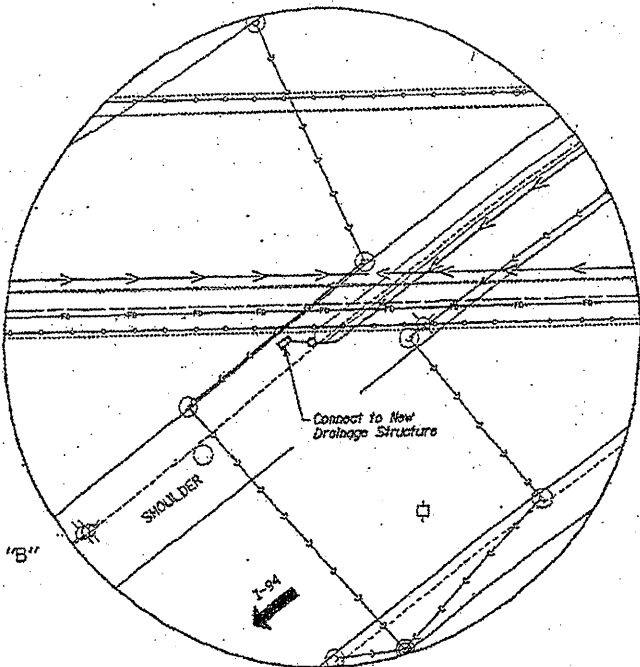

DETAIL "B"

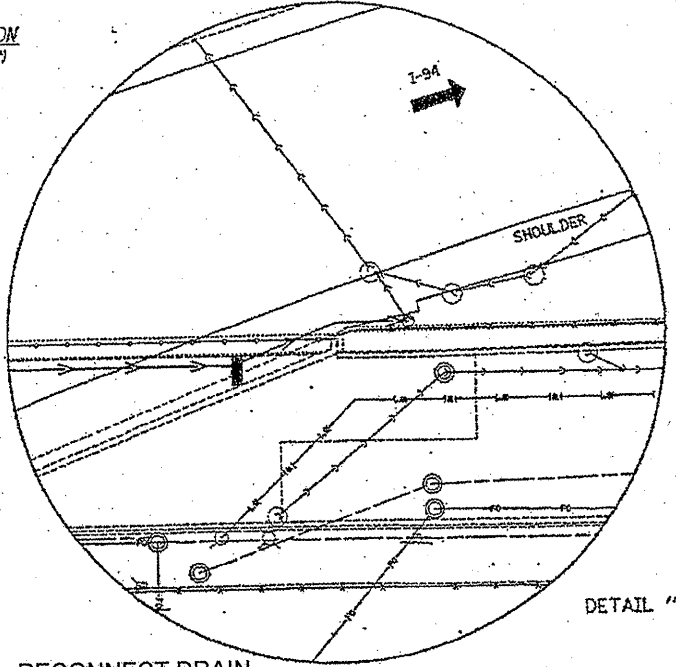

DETAIL "A"

TOTAL BILL OF MATERIALS

| ITEM | UNIT | QUANTITY |
|--|-------|----------|
| BRIDGE DRAINAGE SYSTEM REPAIRS | FOOT | 184 |
| STRUCTURAL REPAIR OF CONCRETE ≤ 5 INCHES | SQ FT | 30 |
| CLEANING DRAINAGE SYSTEM | L SUM | 1 |

NOTES:

1. RECONNECT DRAIN AT WEST SIDE OF SB EXPRESS COST INCLUDED IN THE COST OF "BRIDGE DRAINAGE SYSTEM REPAIRS"
2. STRUCTURAL REPAIR OF CONCRETE ≤ 5 INCHES AT NE CORNER OF NORTH ABUTMENT
3. CLEAN ENTIRE DRAINAGE SYSTEM

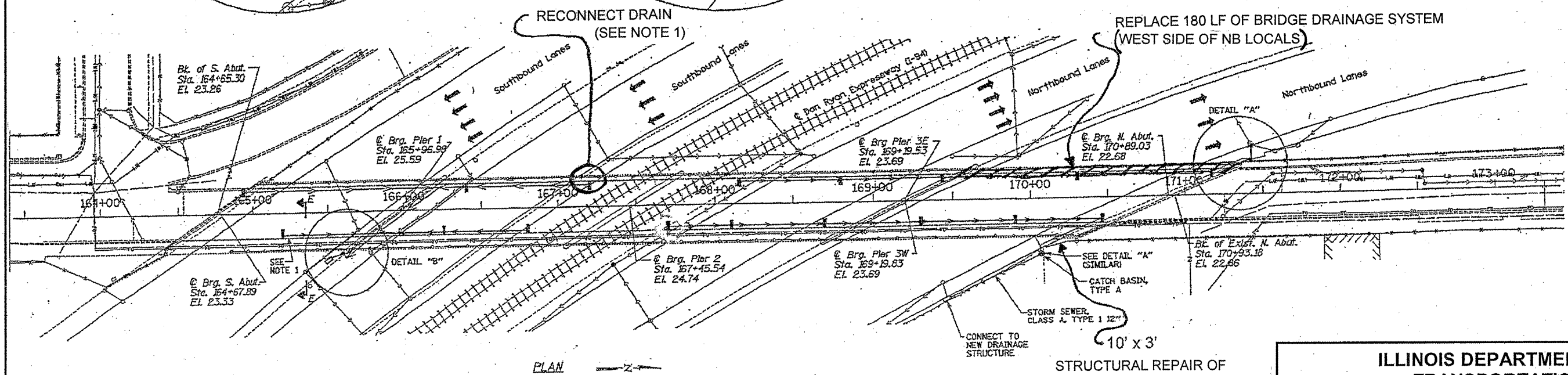

PLAN

STRUCTURAL REPAIR OF CONCRETE ≤ 5 INCHES = 30 SF (SEE NOTE 2)

**ILLINOIS DEPARTMENT OF
TRANSPORTATION
STRUCTURAL REPAIRS
PLAN & ELEVATION
SN: 016-1007
SHEET 2 OF 3**