

\* Order  $a(E)$  &  $a_1(E)$  bars full length.  
Cut to fit skew and use remainder  
of bars in opposite end.

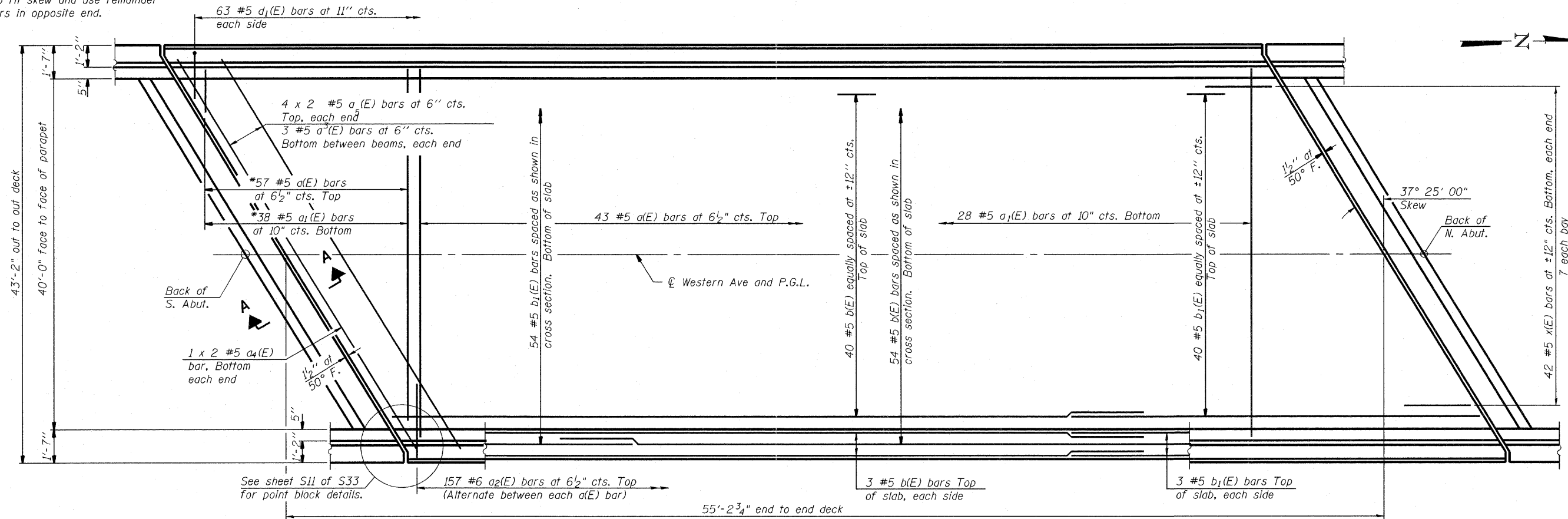

**PLAN**

Notes:  
See Sheet S9 of S35 for superstructure details  
and Bill of Material.  
Bars indicated thus 20 x 3-#5 etc. indicates  
20 lines of bars with 3 lengths per line.  
See Sheet S9 of S35 for parapet reinforcement.

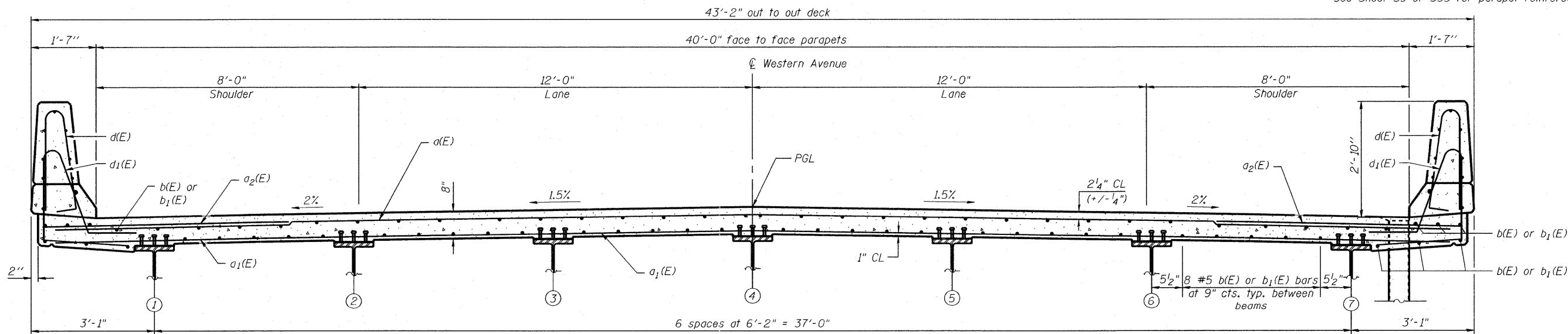

**CROSS SECTION**  
(Looking North)

**APEX**  
CONSULTING ENGINEERS, LLC  
111 N. Wacker Drive, Suite 600  
Chicago, IL 60601  
Phone (312) 977-0660 Fax (312) 977-0661

USER NAME =  
PLOT SCALE =  
PLOT DATE = 10/13/2011

|                |         |
|----------------|---------|
| DESIGNED - RAD | REVISED |
| CHECKED - HAA  | REVISED |
| DRAWN - WHI    | REVISED |
| CHECKED - RAD  | REVISED |

**STATE OF ILLINOIS**  
**DEPARTMENT OF TRANSPORTATION**

**DECK PLAN AND SECTION**  
**STRUCTURE NO. 016-0772**

SHEET NO. 58 OF S33 SHEETS

|                           |                       |                |                       |                   |
|---------------------------|-----------------------|----------------|-----------------------|-------------------|
| F.A.U.<br>RTE.<br>2845    | SECTION<br>2011-206-F | COUNTY<br>COOK | TOTAL<br>SHEETS<br>18 | SHEET<br>NO.<br>7 |
| CONTRACT NO. 60R36        |                       |                |                       |                   |
| ILLINOIS FED. AID PROJECT |                       |                |                       |                   |

FOR INFORMATION ONLY