

PLAN

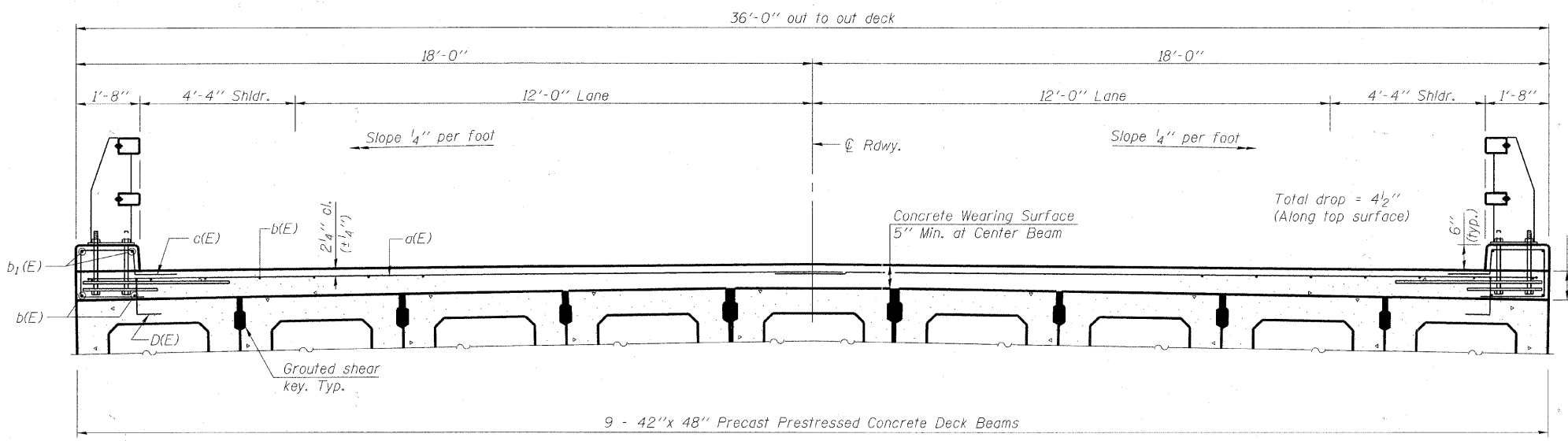

CROSS SECTION
(Looking East)

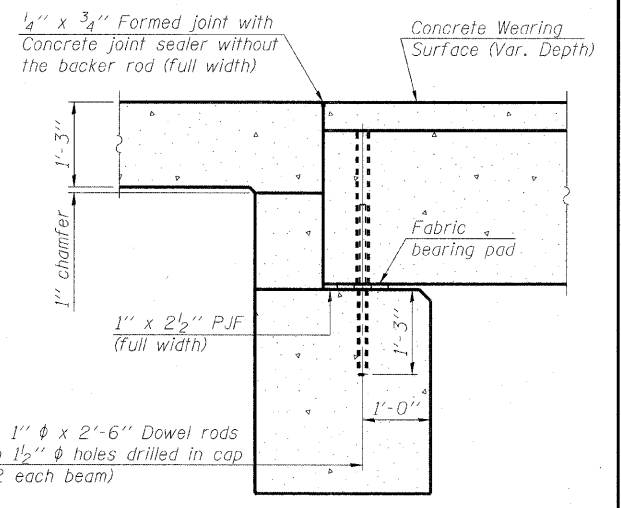

SECTION A-A
(Dimensions are at Rt. L's)

Notes:
All concrete wearing surfaces shall be placed prior to casting a backwall and/or approach slab.
See sheet 4 of 18 for fabric bearing pad details.

Notes:
See sheet 6 of 18 for Superstructure Details and Bill of Material.
Bars indicated thus 20 x 2-#4 etc. indicates 20 lines of bars with 2 lengths per line.
Spacing of a(E) bars shall be measured along the ϕ of structure.
Concrete curb to be paid for as Concrete Superstructure.

MINIMUM BAR LAP
#4 bar = 2'-7"
#5 bar = 3'-3"

COPYRIGHT © 2005 BY BAXTER & WOODMAN, INC.
 STATE OF ILLINOIS - PROFESSIONAL DESIGN FIRM
 5800 N. WILSON AVENUE, SUITE 100
 CHICAGO, ILLINOIS 60630-1000
 TEL: 773-348-1000 FAX: 773-348-1001
 WWW.BAXTERANDWOODMAN.COM



USER NAME =	DESIGNED - BLB	REVISED - 12/30/10 PER MCDOT
PLOT SCALE =	CHECKED - BAB	REVISED -
PLOT DATE =	DRAWN - BCD	REVISED -
	CHECKED - BLB	REVISED -

MCHENRY COUNTY DIVISION OF TRANSPORTATION
GRAF ROAD BRIDGE OVER
WEST BRANCH PISCASAW CREEK

SUPERSTRUCTURE
STRUCTURE NO. 056-3183
 SHEET NO. 5 OF 18 SHEETS

TR RTE.	SECTION	COUNTY	TOTAL SHEETS	SHEET NO.
0037	06-00322-01-BR	MCHENRY	52	28
C-91-258-11			CONTRACT NO. 63580	
FED. ROAD DIST. NO. 1			ILLINOIS FED. AID PROJECT BROS-01110641	