

Notes:  
See sheet 8 of 19 for Sections C-C & D-D and View E-E.  
 $a_1(E)$  and  $a_2(E)$  bar spacings measured along  $\varnothing$  Rdwy.

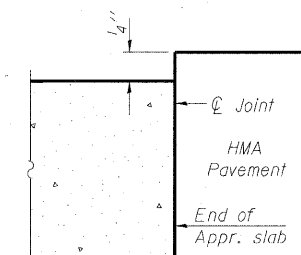

FLEXIBLE PAVEMENT  
DETAIL A

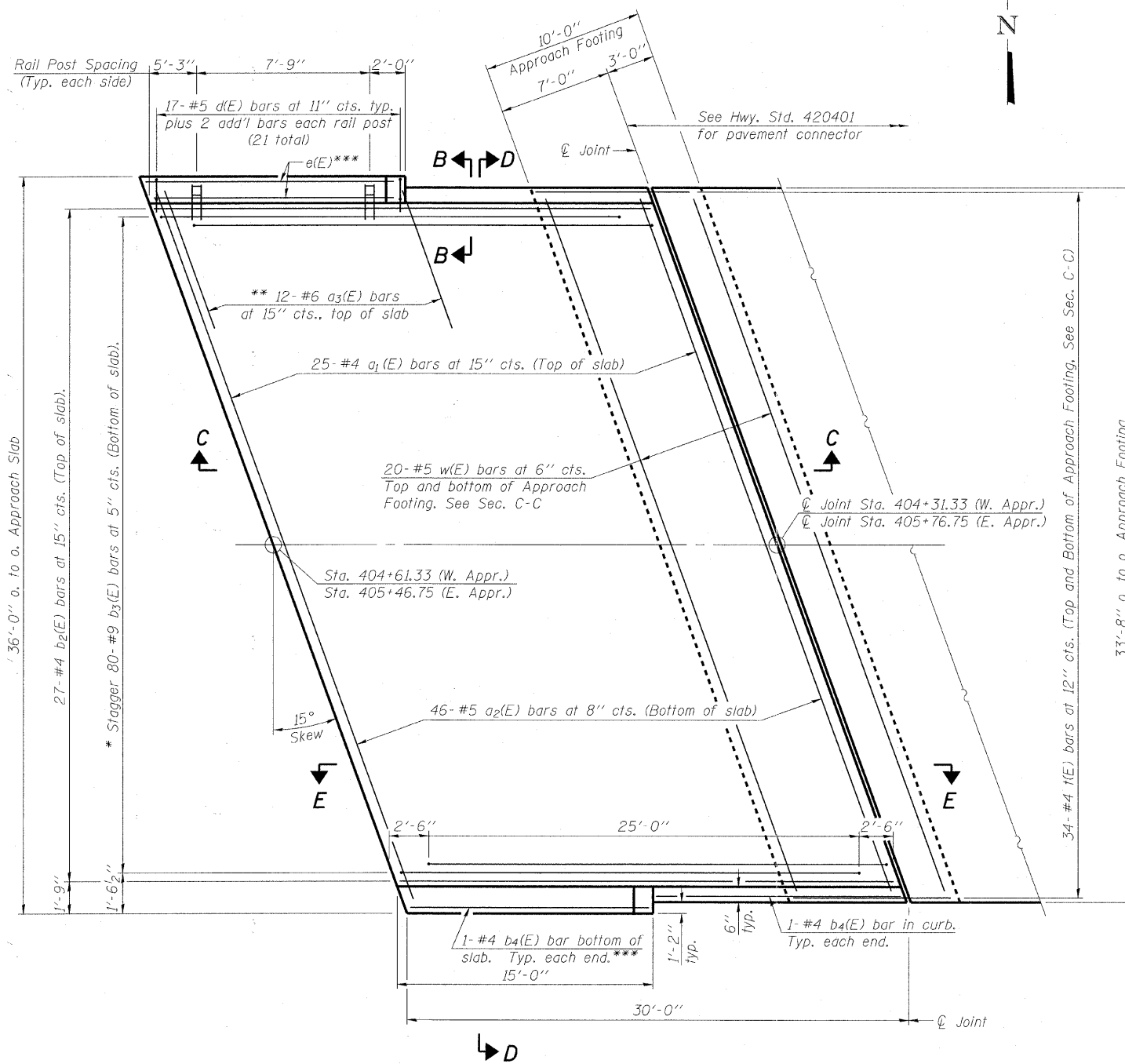
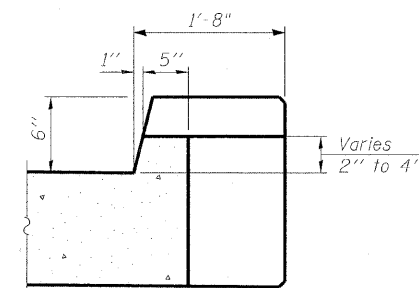

VIEW B-B

PLAN

\* Tilt #9  $b_3(E)$  bars as required to maintain clearance.  
\*\* Space between  $a_1(E)$  bars, typ. each parapet.  
\*\*\* Cut  $e(E)$  and  $b_4(E)$  bars in field to fit.

COPYRIGHT © 2010 BY BAXTER & WOODMAN, INC.  
 STATE OF ILLINOIS - PROFESSIONAL DESIGN FIRM  
 LICENSE NO. 021-07224-0001  
 PROJECT NO. 06-00322-01-BR  
 DATE: 10/08/10



USER NAME =	DESIGNED - BLB	REVISIONS - 12/30/10 PER MCDOT
PLOT SCALE =	CHECKED - BAB	REVISIONS -
PLOT DATE =	DRAWN - BCD	REVISIONS -
	DATE - 10/08/10	REVISIONS -

**MCHENRY COUNTY DIVISION OF TRANSPORTATION**  
**GRAF ROAD BRIDGE OVER**  
**WEST BRANCH PISCASAW CREEK**

**BRIDGE APPROACH SLAB DETAILS**  
**STRUCTURE NO. 056-3183**

SHEET NO. 7 OF 18 SHEETS

TR. RTE.	SECTION	COUNTY	TOTAL SHEETS	SHEET NO.
0037	06-00322-01-BR	MCHENRY	52	30
FED. ROAD DIST. NO. 1 ILLINOIS FED. AID PROJECT			CONTRACT NO. 63580	
			BROS-01110641	

(Sheet 1 of 2)