

NORTH EDGE OF SHOULDER

Location	Station	Offset	Theoretical Grade Elevations
W. End W. Appr. Slab	404+26.95	-16.33	889.85
A1	404+36.95	-16.33	889.81
A2	404+46.95	-16.33	889.77
E. End W. Appr. Slab	404+56.95	-16.33	889.72

NORTH EDGE OF PAVEMENT

Location	Station	Offset	Theoretical Grade Elevations
W. End W. Appr. Slab	404+28.11	-12.00	889.93
A1	404+38.11	-12.00	889.89
A2	404+48.11	-12.00	889.85
E. End W. Appr. Slab	404+58.11	-12.00	889.79

☉ ROADWAY & PROFILE GRADE

Location	Station	Offset	Theoretical Grade Elevations
W. End W. Appr. Slab	404+31.33	0.00	890.17
A1	404+41.33	0.00	890.13
A2	404+51.33	0.00	890.08
E. End W. Appr. Slab	404+61.33	0.00	890.03

SOUTH EDGE OF PAVEMENT

Location	Station	Offset	Theoretical Grade Elevations
W. End W. Appr. Slab	404+34.55	12.00	889.92
A1	404+44.55	12.00	889.87
A2	404+54.55	12.00	889.82
E. End W. Appr. Slab	404+64.55	12.00	889.76

SOUTH EDGE OF SHOULDER

Location	Station	Offset	Theoretical Grade Elevations
W. End W. Appr. Slab	404+35.71	16.33	889.81
A1	404+45.71	16.33	889.77
A2	404+55.71	16.33	889.73
E. End W. Appr. Slab	404+65.71	16.33	889.68

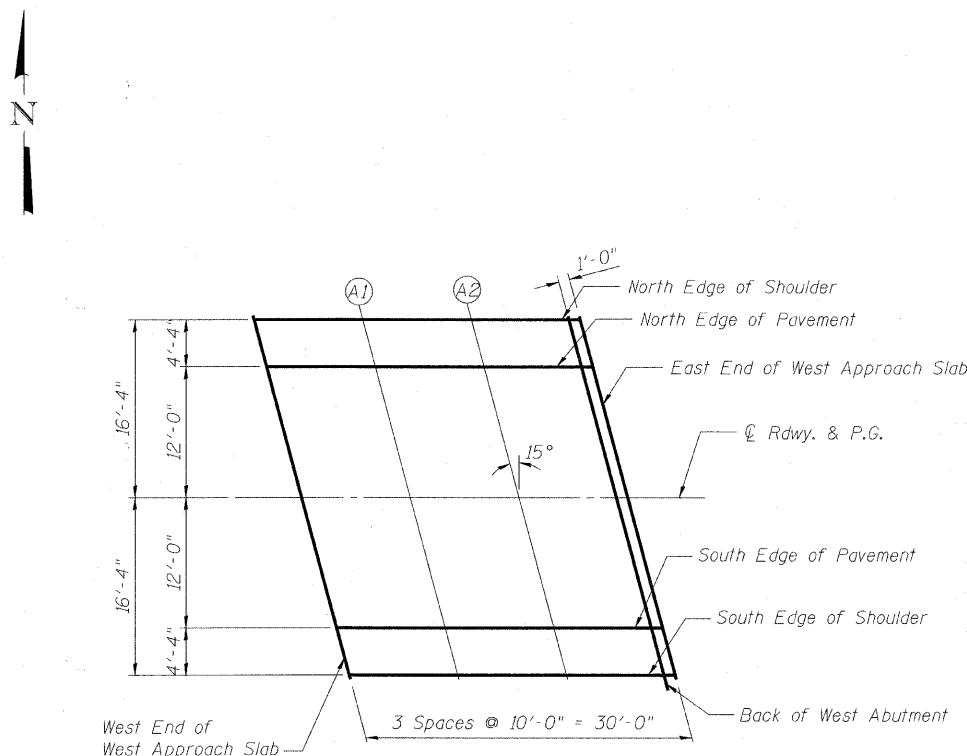

PLAN
West Approach

COPYRIGHT © 2006 BY BAXTER & WOODMAN, INC.
 STATE OF ILLINOIS - PROFESSIONAL DESIGN FIRM
 LICENSE NO. - 06-00322-01-BR
 EXPIRES - 7/23/11
 PROJECT NO. - 06-00322-01-BR
 SHEET NO. - 9 OF 18



USER NAME =	DESIGNED - BLB	REVISED - 12/30/10 PER MCDOT
PLLOT SCALE =	CHECKED - BAB	REVISED -
PLLOT DATE =	DRAWN - BCD	REVISED -
	DATE - 10/08/10	REVISED -

MCHENRY COUNTY DIVISION OF TRANSPORTATION
GRAF ROAD BRIDGE OVER
WEST BRANCH PISCASAW CREEK

TOP OF WEST APPROACH SLAB ELEVATIONS
STRUCTURE NO. 056-3183

SHEET NO. 9 OF 18 SHEETS

TR RTE.	SECTION	COUNTY	TOTAL SHEETS	SHEET NO.
0037	06-00322-01-BR	MCHENRY	52	32
C-91-258-11		CONTRACT NO. 63580		
FED. ROAD DIST. NO. 1		ILLINOIS FED. AID PROJECT BR05-01110641		