

COPYRIGHT © 2011 BY BAXTER & WOODMAN, INC.  
 STATE OF ILLINOIS - PROFESSIONAL DESIGN FIRM  
 LICENSE NO. 186-001201  
 1100 N. WASHINGTON ST., SUITE 200, DEERFIELD, IL 60015  
 TEL: 847.939.8800 FAX: 847.939.8801  
 WWW.BAXTERANDWOODMAN.COM  
 PROJECT: MCHENRY COUNTY DIVISION OF TRANSPORTATION  
 GRAF ROAD BRIDGE OVER WEST BRANCH PISCASAW CREEK  
 DRAWING: GRAF ROAD BRIDGE OVER WEST BRANCH PISCASAW CREEK  
 SHEET: 52 OF 50

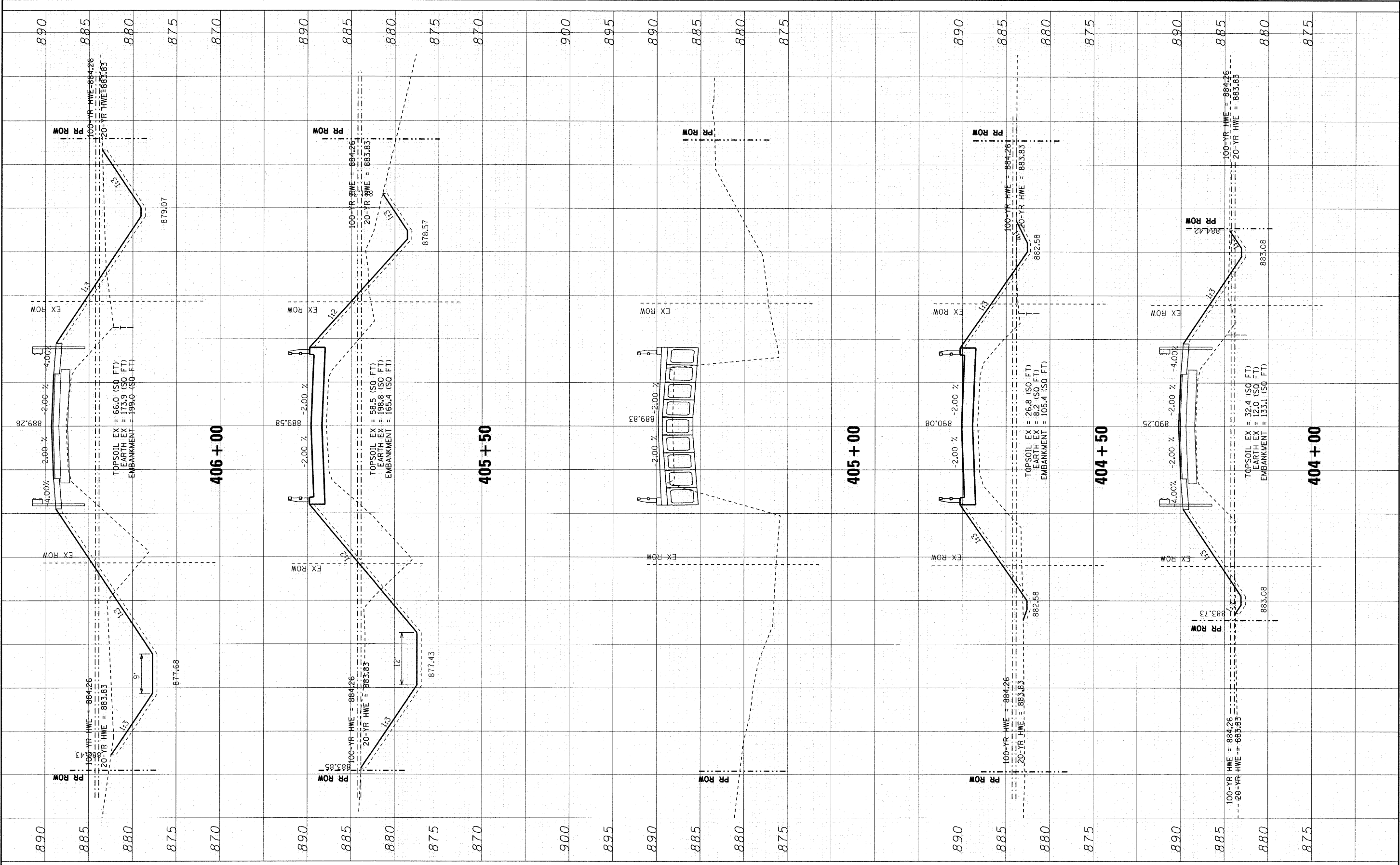

DESIGNED - REW	REVISED - 12/30/10 PER MCDOT
DRAWN - KAR	REVISED -
CHECKED - TLH	REVISED -
DATE - 10/08/10	REVISED -

**MCHENRY COUNTY DIVISION OF TRANSPORTATION  
 GRAF ROAD BRIDGE OVER  
 WEST BRANCH PISCASAW CREEK**

**CROSS SECTIONS**

SCALE: H: 1"=10' V: 1"=5'

STA. 404+00 TO STA. 406+00

TR. RTE. 0037	SECTION 06-00322-01-BR	COUNTY McHENRY	TOTAL SHEETS 52	SHEET NO. 50
C-91-258-11		CONTRACT NO. 63580		
FED. ROAD DIST. NO. 1 ILLINOIS/FED. AID PROJECT BR05-0111064				