

COPYRIGHT © 2011 BY BAXTER & WOODMAN, INC.
 STATE OF ILLINOIS - PROFESSIONAL DESIGN FIRM
 LICENSE NO. - 04-0000066-EXPRES-562000 PW
 4/15/2011
 ...pilotdriver\PR2234.dwg
 "P:\GIS\Drawings\CAD\DR\GRAF\GRAF-01224-Cross-Sections.dwg
 10/23/2010 10:00:00 AM

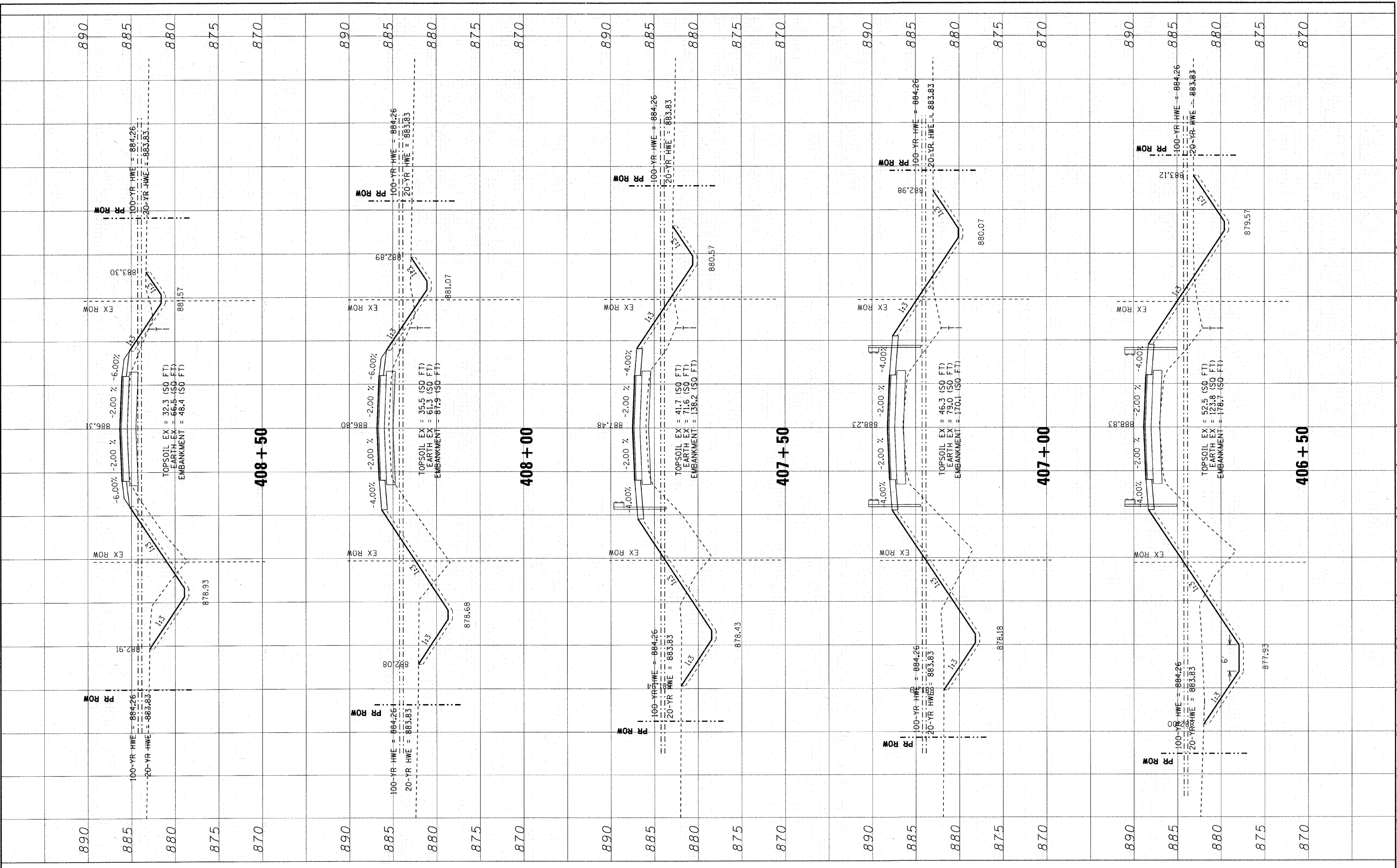

DESIGNED -	REVISION	12/30/10 PER MCDOT
DRAWN -	REVISION	
CHECKED -	REVISION	
DATE - 10/08/10	REVISION	

MCHENRY COUNTY DIVISION OF TRANSPORTATION
GRAF ROAD BRIDGE OVER
WEST BRANCH PISCASAW CREEK

SCALE: H: 1"=10' V: 1"=5'		STA. 406+50 TO STA. 408+50		FED. ROAD DIST. NO. 1 ILLINOIS FED. AID PROJECT BR05-0111064	
CROSS SECTIONS					
TR	SECTION	COUNTY	TOTAL SHEETS	SHEET NO.	
0037	06-00322-01-BR	MCHENRY	52	51	
C-91-258-11			CONTRACT NO. 63580		