

TRAFFIC CONTROL GENERAL NOTES

1. ALL SIGNING SHALL BE IN ACCORDANCE WITH THE APPLICABLE PROVISIONS OF THE STATE OF ILLINOIS "STANDARD SPECIFICATIONS FOR ROAD AND BRIDGE CONSTRUCTION ADOPTED JAN. 1, 2007", "THE QUALITY STANDARD FOR WORK ZONE TRAFFIC CONTROL DEVICES ADOPTED 2010", THE DETAILS IN THESE PLANS, AND THE LATEST EDITION OF THE STATE OF ILLINOIS "MANUAL OF UNIFORM TRAFFIC CONTROL DEVICES".
2. IF DEEMED NECESSARY BY THE ENGINEER, A PRE-CONSTRUCTION MEETING WITH THE CONTRACTOR SHALL BE HELD AT LEAST ONE WEEK PRIOR TO THE DAY OF THE ROADWAY CLOSURE IS TO BE IN EFFECT.
3. THE CONTRACTOR SHALL SUPPLY TO THE ENGINEER THE NAMES AND TELEPHONE NUMBERS OF HIS REPRESENTATIVES ON THE CONSTRUCTION SITE AND HIS REPRESENTATIVE RESPONSIBLE FOR THE TRAFFIC CONTROL PLAN SIGNING PRIOR TO THE START OF THE WORK.
4. LONGITUDINAL DIMENSIONS SHOWN ON THESE PLANS MAY BE ADJUSTED TO FIT FIELD CONDITIONS WITH THE APPROVAL OF THE ENGINEER.
5. THE CONTRACTOR SHALL BE RESPONSIBLE FOR ENSURING THAT ALL BARRICADES, SIGNS, LIGHTS, AND OTHER DEVICES INSTALLED BY HIM ARE IN PLACE AND OPERATION 24 HOURS EACH DAY INCLUDING SUNDAYS AND HOLIDAYS DURING THE TIME THE TRAFFIC CONTROL PLAN IS IN EFFECT.
6. THE TRAFFIC CONTROL SHOWN ON THIS PLAN IS THE MINIMUM NECESSARY TO ENSURE THESE ROADWAY IMPROVEMENTS. THE CONTRACTOR SHALL MAKE ALL CHANGES IN TRAFFIC CONTROL THAT IS DEEMED NECESSARY BY THE ENGINEER.
7. THE SIZES OF ALL SIGNS NOT SPECIFIED IN THESE PLANS SHALL BE AS REQUIRED BY THE ILLINOIS MANUAL ON UNIFORM TRAFFIC CONTROL DEVICES.
8. AS A MINIMUM, ALL AMBER FLASHING LIGHTS THAT ARE REQUIRED FOR THIS DETOUR SHALL MEET THE REQUIREMENTS FOR TYPE 'A' LOW INTENSITY FLASHING LIGHTS IN ARTICLE 1084.01 OF THE STANDARD SPECIFICATIONS. ALL LIGHTS SHALL OPERATE DURING THE HOURS OF DARKNESS. ONLY LIGHTS THAT HAVE BEEN APPROVED BY THE ILLINOIS DEPARTMENT OF TRANSPORTATION SHALL BE USED.
9. ALL BARRICADES SHALL HAVE REFLECTORIZED STRIPING ON BOTH SIDES OF THE BARRICADES. THE TYPE III BARRICADES USED AT THE POINT OF CLOSURE TO THRU TRAFFIC SHALL NOT EXCEED EIGHT FEET (2.4m) IN WIDTH EACH, FOR A SINGLE APPROACH LANE.

TRAFFIC CONTROL GENERAL NOTES Continued

10. THE CONTRACTOR SHALL BE RESPONSIBLE FOR MAINTAINING THE VISIBILITY OF ALL TRAFFIC CONTROL AND CONSTRUCTION SIGNING, INCLUDING BRUSHING BACK VEGETATION IF DEEMED NECESSARY BY THE ENGINEER.
11. THE FOLLOWING ILLINOIS DEPARTMENT OF TRANSPORTATION STANDARDS ARE APPLICABLE FOR THIS WORK:
 701101-02 OFF ROAD OPERATIONS - MULTILANE - LESS THAN 15 FT TO EOP
 701106-02 OFF ROAD OPERATIONS - MULTILANE - MORE THAN 15 FT AWAY
 701301-04 LANE CLOSURE 2L, 2W, SHORT TIME OPERATIONS
 701501-06 URBAN LANE CLOSURE 2L, 2W, UNDIVIDED
 701606-06 URBAN LANE CLOSURE MULTILANE, 2W WITH MOUNTABLE MEDIAN
 701701-07 URBAN LANE CLOSURE MULTILANE INTERSECTION
 701801-04 LANE CLOSURE, MULTILANE, 1W OR 2W, CROSSWALK OR SIDEWALK CLOSURE
 701901-01 TRAFFIC CONTROL DEVICES
12. BARRICADES WILL BE REQUIRED ADJACENT TO PAVEMENT EDGES WHERE CURB & GUTTER, WIDENING OR OVERLAYING WORK IS BEING DONE, AS SPECIFIED IN SECTIONS 701 AND 702 OF THE "STANDARD SPECIFICATIONS FOR ROAD AND BRIDGE CONSTRUCTION", EXCEPT THAT THE BARRICADES SHALL BE TYPE II (OR DRUMS), NON-METALLIC WITH STEADY-BURNING LIGHTS. SPACING SHALL BE AT 15m (49ft) CENTERS UNLESS OTHERWISE DIRECTED BY THE ENGINEER.
13. ROAD NAME PLATES SHALL BE INSTALLED UNDER "ROAD WORK AHEAD" SIGNS AT THE LOCATIONS SHOWN. NAME PLATES SHALL BE 9" BLANKS WITH 6" UPPER CASE AND 5" LOWER CASE LETTERS.
14. ALL CONSTRUCTION SIGNS SHALL HAVE FLUORESCENT ORANGE BACKGROUNDS.
15. MAINTENANCE OF ALL TRAFFIC CONTROL DEVICES ARE THE SOLE RESPONSIBILITY OF THE CONTRACTOR.

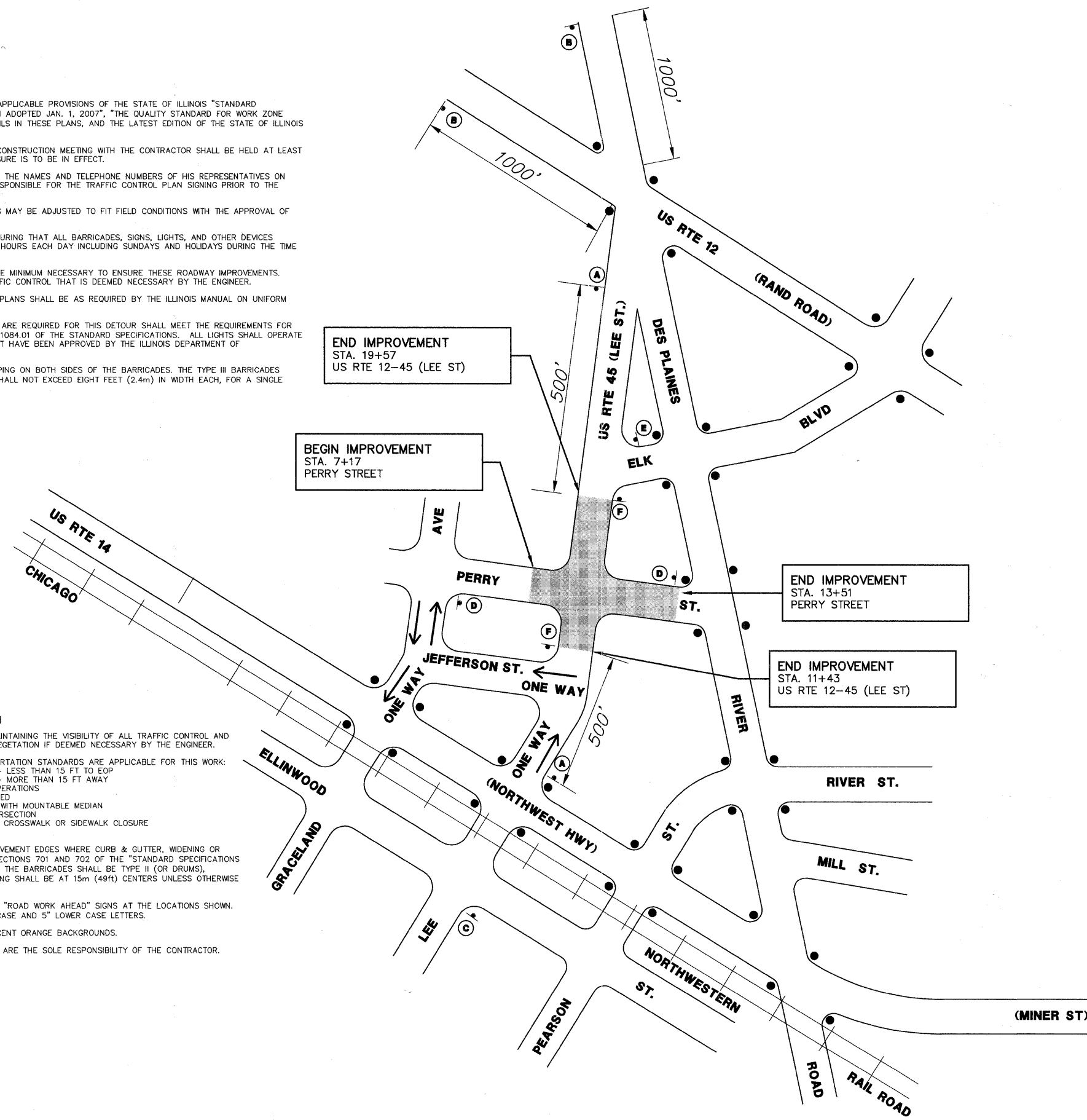

LEGEND

- SIGNALIZED INTERSECTION
- W20-1 48 IN. x 48 IN. CONSTRUCTION WARNING SIGN, WITH AMBER FLASHING LIGHT
- SIGN ON PERMANENT SUPPORT
- M6 SERIES SIGNS
- CONSTRUCTION WORK ZONE

SPEED LIMIT IS 30 MPH - US RTE 12-45 (LEE ST.)
 SPEED LIMIT IS 25 MPH - PERRY ST

SIGN LEGEND

- A** ROAD CONSTRUCTION 500' 2 REQUIRED
- B** ROAD CONSTRUCTION AHEAD 2 REQUIRED
- C** ROAD CONSTRUCTION AHEAD LEE ST. SOUTH 1 REQUIRED
- D** ROAD CONSTRUCTION AHEAD LEE ST. NORTH 2 REQUIRED
- E** ROAD CONSTRUCTION AHEAD 1 REQUIRED
- F** END CONSTRUCTION 2 REQUIRED

FILE NAME = 3850-805-PR1.dwg	USER NAME = ZACH WALLSTEN	DESIGNED - CAD	REVISED -	CITY OF DES PLAINES PROPOSED ROADWAY WIDENING AND TRAFFIC SIGNAL INSTALLATION	TRAFFIC CONTROL PLAN			FAP RTE. 330	SECTION 10-00213-00-CH	COUNTY COOK	TOTAL SHEETS 47	SHEET NO. 6	CONTRACT # 63616	ILLINOIS FED. AID PROJECT	
PLOT SCALE = 1/101	CHECKED - BLS	REVISED -	REVISED -		SCALE: NONE	SHEET NO. OF SHEETS	STA. TO STA.								
PLOT DATE = 8/23/2011	DATE - 8/23/2011	REVISED -	REVISED -												
GHA #3850.805															