

**PROPOSED CONDITIONS LEGEND**

- PROPOSED FULL DEPTH PAVEMENT  
SEE TYPICAL SECTION
- PROPOSED RESURFACING
- PROPOSED SIDEWALK  
SEE TYPICAL CROSS SECTION
- PROPOSED CONCRETE DRIVEWAY  
SEE TYPICAL CROSS SECTION
- B-6.12 COMB. CONC. CURB & GUTTER
- B-6.24 COMB. CONC. CURB & GUTTER
- PROPOSED COMBINATION CURB AND GUTTER  
REVERSE PITCH  
DETECTABLE WARNINGS SEE DETAIL

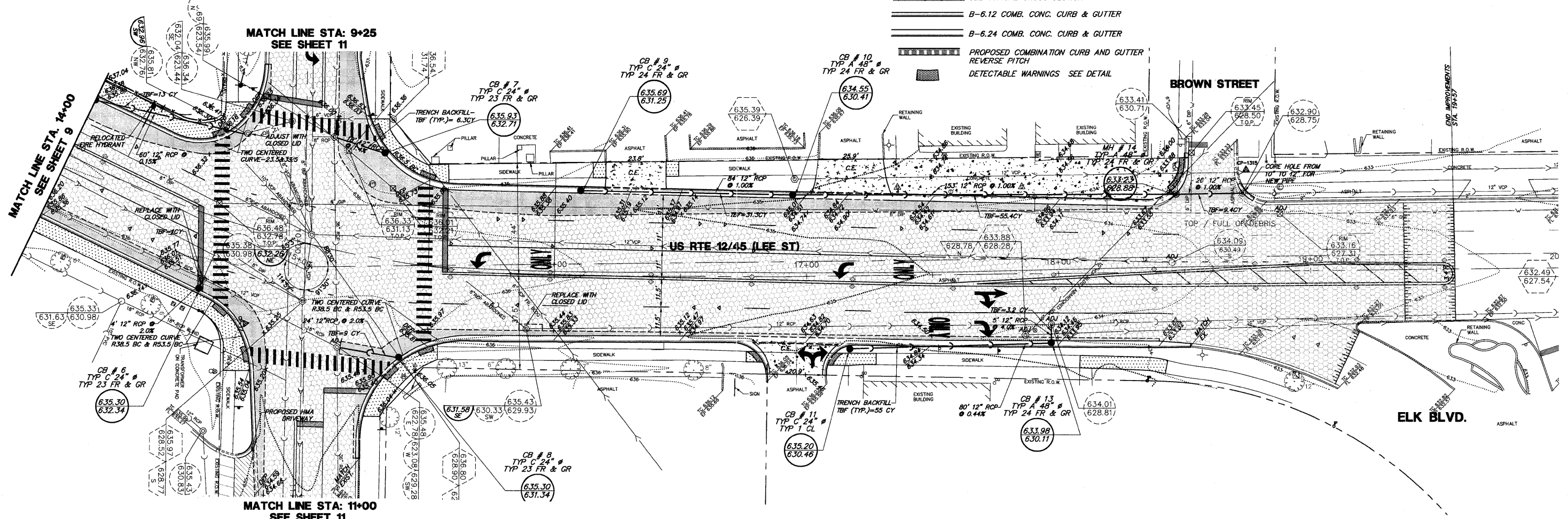

**US RTE 12/45 (LEE ST)**

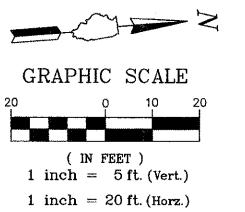
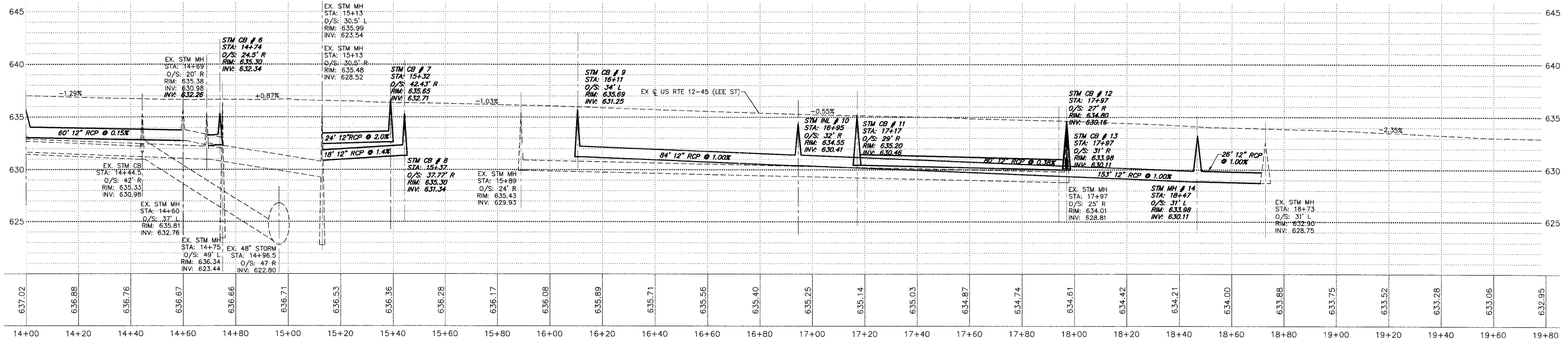

FILE NAME = 3850-805-PR1.dwg	USER NAME = ZACH WALLSTEN	DESIGNED - CAD	REVISED -	<b>CITY OF DES PLAINES PROPOSED ROADWAY WIDENING AND TRAFFIC SIGNAL INSTALLATION</b>	<b>PLAN &amp; PROFILE (LEE STREET)</b>	F.A.P. RTE 330	SECTION 10-00213-00-CH	COUNTY COOK	TOTAL SHEETS 47	SHEET NO. 10	CONTRACT # 63616	ILLINOIS FED. AID PROJECT	
PLOT SCALE = 1/101		DRAWN - CAD	REVISED -			SCALE: 1"=20'	SHEET NO. OF SHEETS	STA. 14+00 TO STA. 19+50					
PLOT DATE = 8/23/2011		CHECKED - BLS	REVISED -										
DATE = 8/23/2011		DATE - 8/23/2011	REVISED -										

GHA #3850.805