

QUANTITY
 4 (100) LINE = 64.1 ft. (19.7 m)
 21.1 sq. ft. (1.97 sq. m)

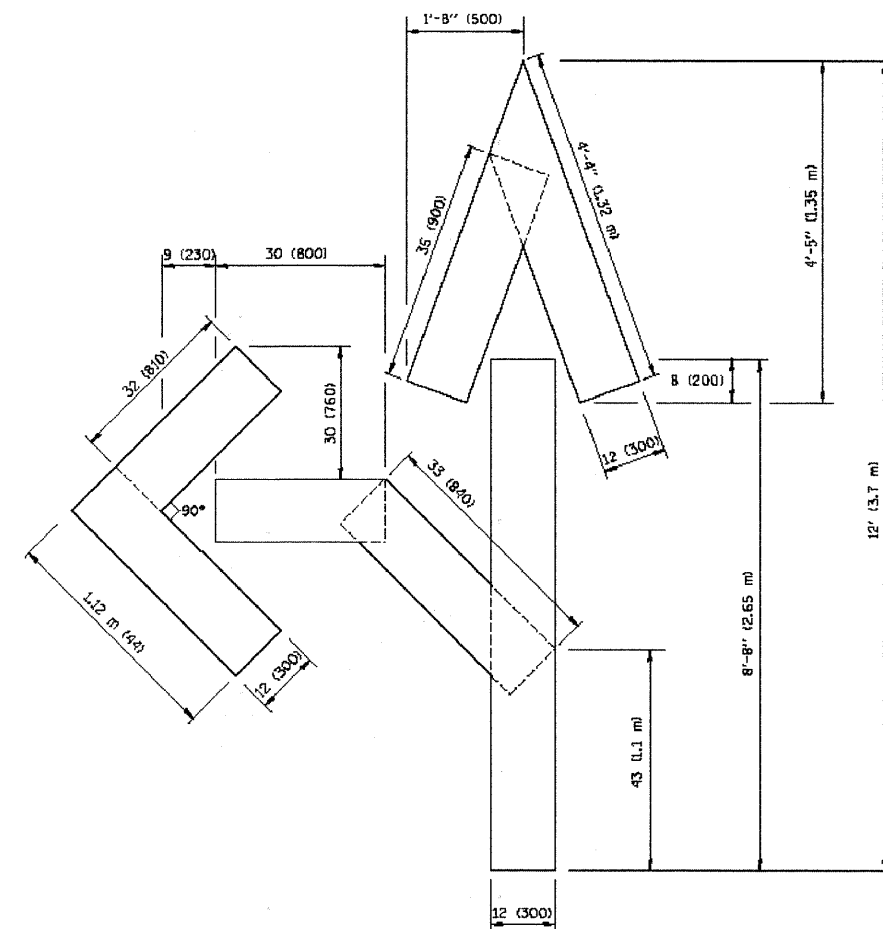

QUANTITY
 4 (100) LINE = 82.5 ft. (25.3 m)
 27.5 sq. ft. (2.53 sq. m)

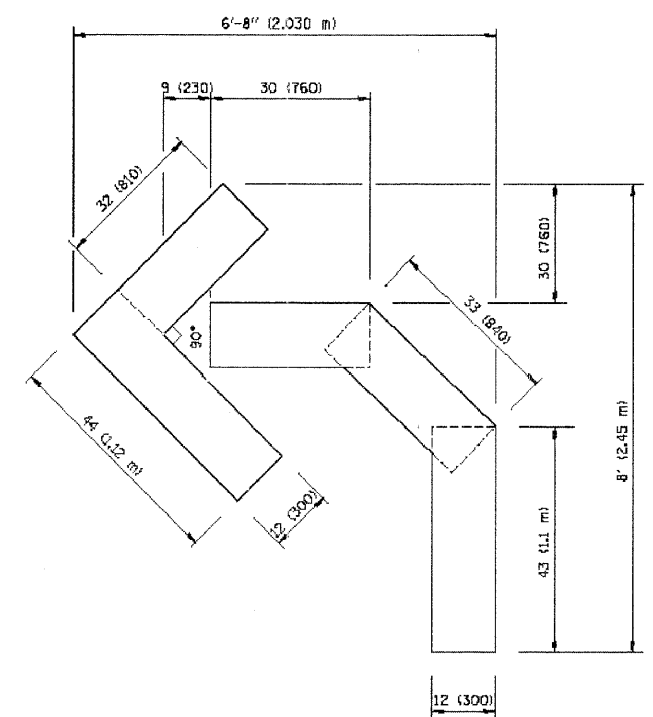

QUANTITY
 4 (100) LINE = 45.5 ft. (13.9 m)
 15.2 sq. ft. (1.39 sq. m)

All dimensions are in inches (millimeters) unless otherwise shown.

FILE NAME =	USER NAME = geglancbt	DESIGNED -	REVISED -T. RAMMACHER 06-05-96
W:\data\22c34\to18.dgn		DRAWN -	REVISED -T. RAMMACHER 11-04-97
		CHECKED -	REVISED -T. RAMMACHER 03-02-98
		DATE - 09-18-94	REVISED -E. GOMEZ 08-28-00

**STATE OF ILLINOIS
 DEPARTMENT OF TRANSPORTATION**

**PAVEMENT MARKING LETTERS AND SYMBOLS
 FOR TRAFFIC STAGING**

SCALE: NONE SHEET NO. 1 OF 1 SHEETS STA. TO STA.

F.A.V. RTE.	SECTION	COUNTY	TOTAL SHEETS	SHEET NO.
2763	10-00061-00-RS	COOK	41	34a
TC-16			CONTRACT NO. 63631	
FED. ROAD DIST. NO. 1 ILLINOIS FED. AID PROJECT			M-9003(752)	

Drawing file: W:\Projects\61210209 - Cornfield Road Recon\94_T010(eta)_34.dwg Sep 12, 2011 - 3:23pm