

DETECTABLE WARNINGS

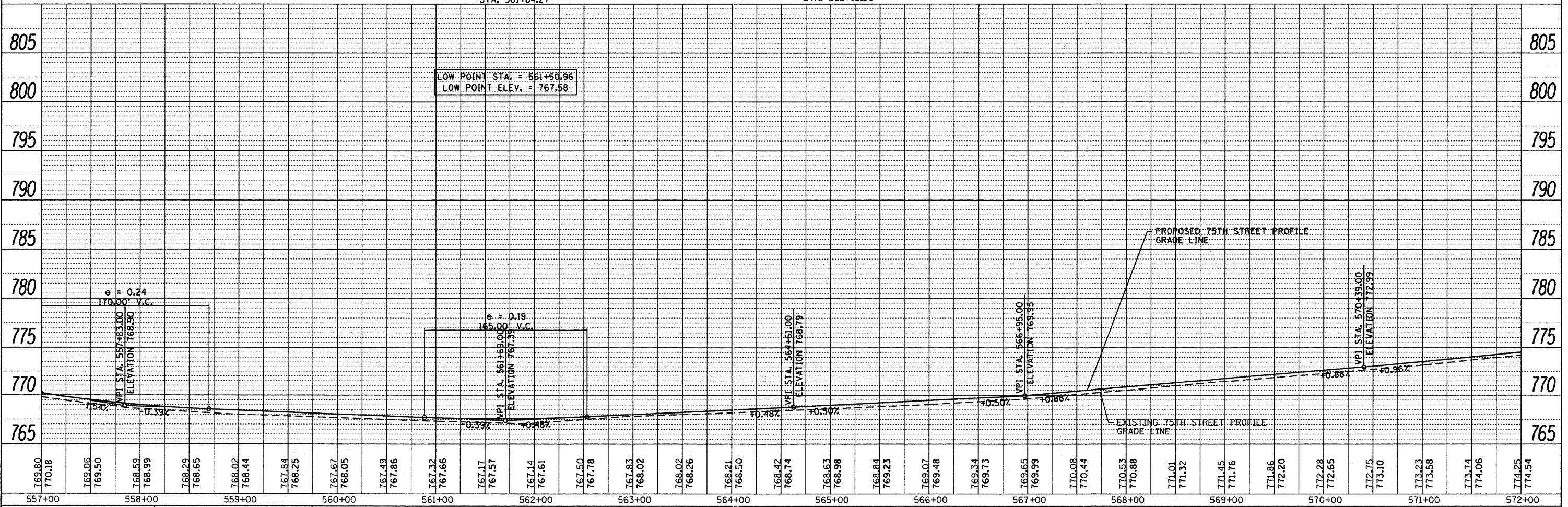

DATE	
BY	
REVISIONS	
NO.	
DESCRIPTION	
DATE	
BY	
REVISIONS	
NO.	
DESCRIPTION	
DATE	
BY	
REVISIONS	
NO.	
DESCRIPTION	
DATE	
BY	
REVISIONS	
NO.	
DESCRIPTION	

DATE	
BY	
REVISIONS	
NO.	
DESCRIPTION	
DATE	
BY	
REVISIONS	
NO.	
DESCRIPTION	
DATE	
BY	
REVISIONS	
NO.	
DESCRIPTION	

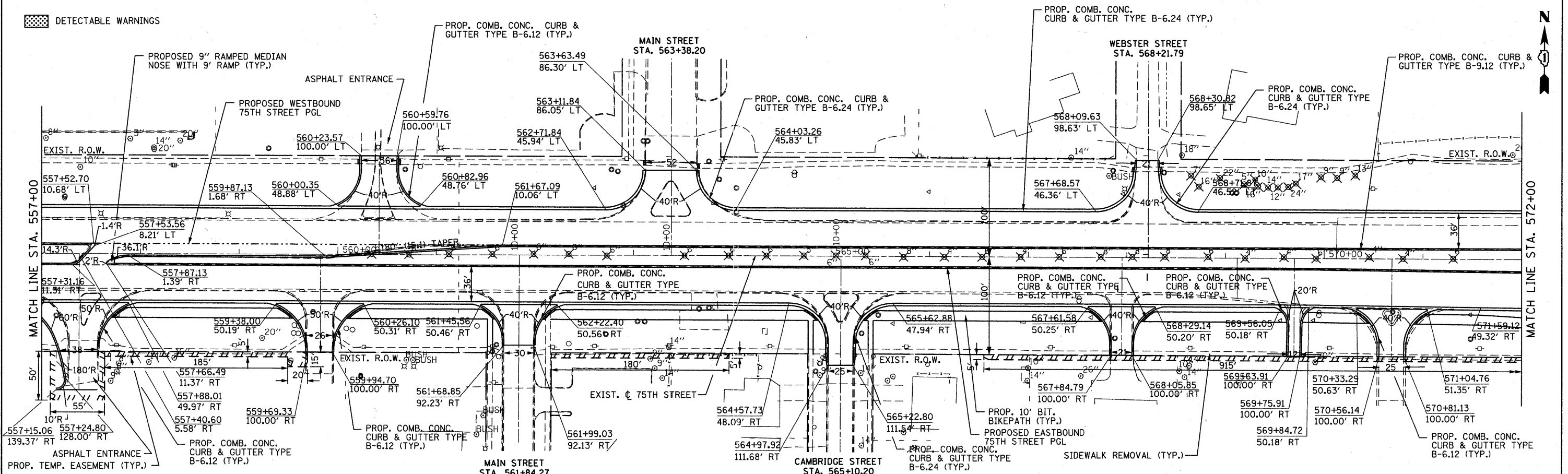

769.80	770.18	769.05	769.50	768.59	768.99	768.29	768.65	768.02	768.44	767.84	768.25	767.67	768.05	767.49	767.86	767.32	767.66	767.17	767.57	767.14	767.61	767.50	767.78	767.83	768.02	768.02	768.26	768.21	768.50	768.42	768.74	768.63	768.98	768.84	769.23	769.07	769.48	769.34	769.73	769.65	769.99	770.08	770.44	770.53	770.88	771.01	771.32	771.45	771.76	771.86	772.20	772.28	772.65	772.75	773.10	773.23	773.58	773.74	774.06	774.25	774.54
557+00		558+00		559+00		560+00		561+00		562+00		563+00		564+00		565+00		566+00		567+00		568+00		569+00		570+00		571+00		572+00																															

B Bollinger, Lach & Associates, Inc.
ITASCA, ILLINOIS

USER NAME = gellwanger
DESIGNED - GJE
DRAWN - DC
CHECKED - JP
DATE - 09/08/11

REVISED -
REVISED -
REVISED -
REVISED -

STATE OF ILLINOIS
DEPARTMENT OF TRANSPORTATION

PLAN AND PROFILE
75TH STREET
VERT. 1"=5'
SCALE: HORZ. 1"=50' SHEET NO. 23 OF 198 SHEETS STA. 557+00 TO STA. 572+00

F.A.P. RTE.	SECTION	COUNTY	TOTAL SHEETS	SHEET NO.
	07-00232-04-WR	DuPAGE	198	23
CONTRACT NO. 63632			ILLINOIS FED. AID PROJECT	