

DATE	
BY	
SURVEYED	
PLOTTED	
TEMPLATE	
NOTE BOOK	
AREAS CHECKED	
NO.	

DATE	
BY	
SURVEYED	
PLOTTED	
TEMPLATE	
NOTE BOOK	
AREAS CHECKED	
NO.	

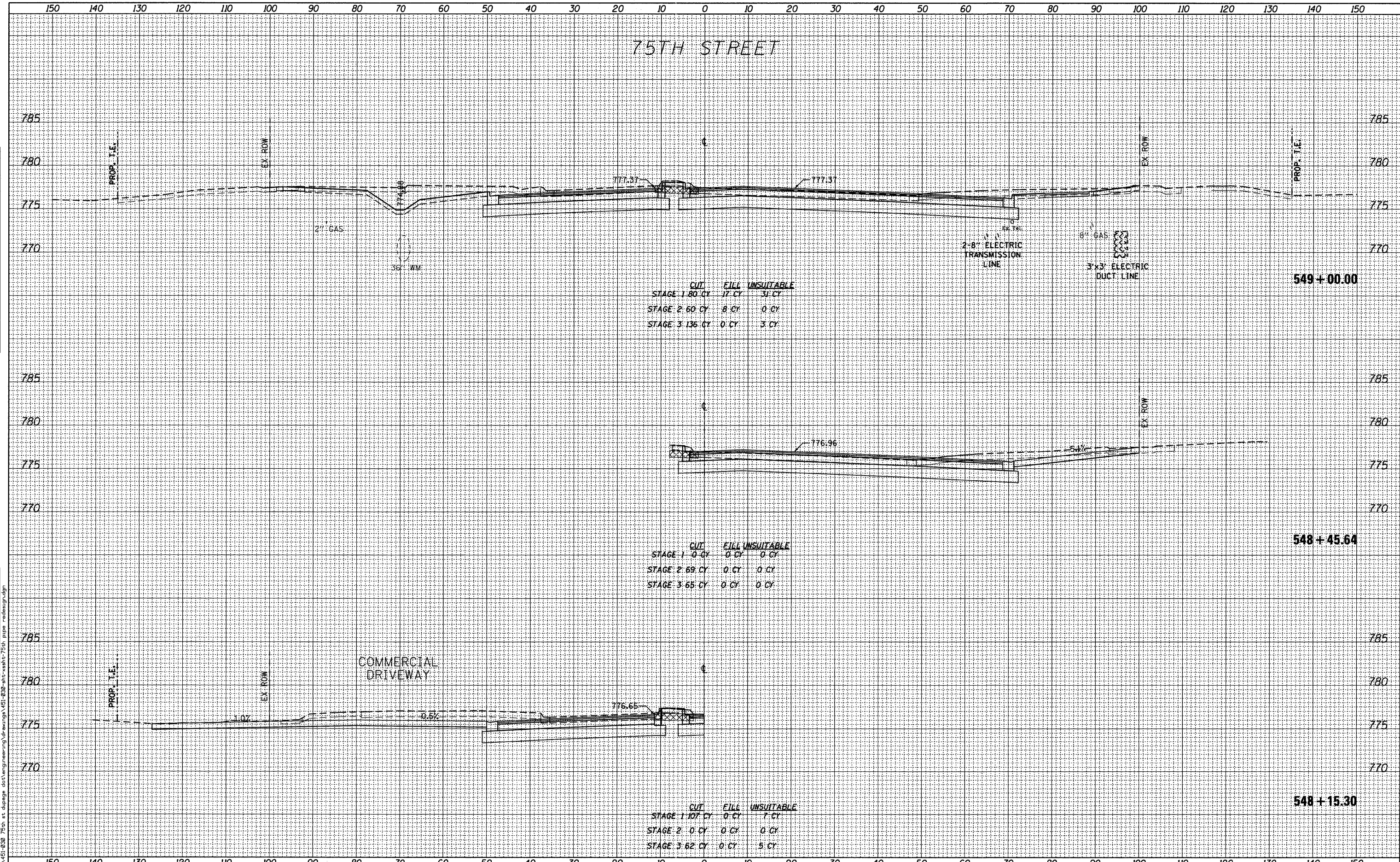

	CUT	FILL	UNSUITABLE
STAGE 1	180 CY	17 CY	31 CY
STAGE 2	60 CY	8 CY	0 CY
STAGE 3	136 CY	0 CY	3 CY

	CUT	FILL	UNSUITABLE
STAGE 1	0 CY	0 CY	0 CY
STAGE 2	69 CY	0 CY	0 CY
STAGE 3	65 CY	0 CY	0 CY

	CUT	FILL	UNSUITABLE
STAGE 1	107 CY	0 CY	7 CY
STAGE 2	0 CY	0 CY	0 CY
STAGE 3	62 CY	0 CY	5 CY

**B** Bollinger, Lach & Associates, Inc.  
ITASCA, ILLINOIS

USER NAME = gellwanger  
DESIGNED - GJE  
DRAWN - DC  
CHECKED - JP  
DATE - 09/08/11

REVISIED -  
REVISIED -  
REVISIED -  
REVISIED -

STATE OF ILLINOIS  
DEPARTMENT OF TRANSPORTATION

CROSS SECTIONS  
75TH STREET  
V: 1"=5'  
SCALE: H: 1"=10'  
SHEET NO. 173 OF 198 SHEETS  
STA. 548+15.30 TO STA. 549+00.00

F.A.P. RTE.	SECTION	COUNTY	TOTAL SHEETS	SHEET NO.
0369	07-00232-04-WR	DUPAGE	198	173
CONTRACT NO. 63632			ILLINOIS FED. AID PROJECT	

FILE NAME = F:\451-030 75th st. dupage.dwg