

150 140 130 120 110 100 90 80 70 60 50 40 30 20 10 0 10 20 30 40 50 60 70 80 90 100 110 120 130 140 150

75TH STREET

DATE	
BY	
SURVEYED	
PLOTTED	
TEMPLATE	
NOTE BOOK	
AREAS CHECKED	
NO.	

DATE	
BY	
SURVEYED	
PLOTTED	
TEMPLATE	
NOTE BOOK	
AREAS CHECKED	
NO.	

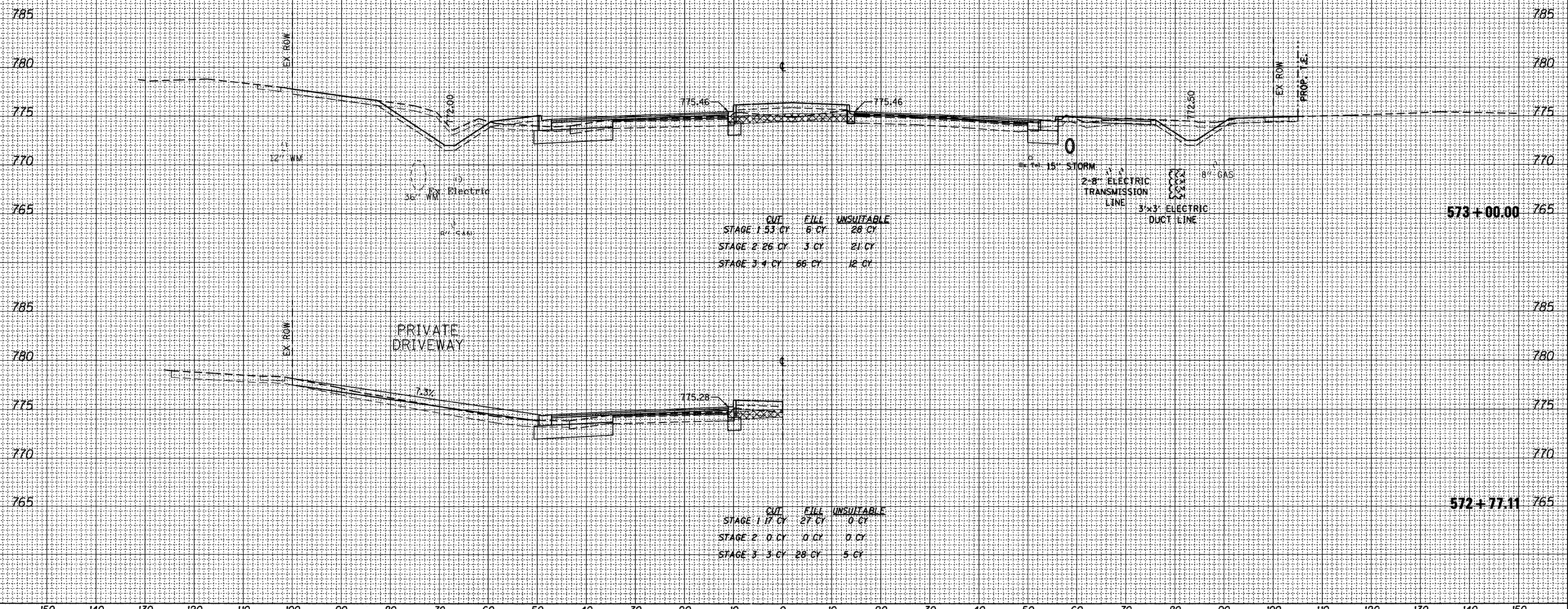

	CUT	FILL	UNSUITABLE
STAGE 1	53 CY	6 CY	28 CY
STAGE 2	26 CY	3 CY	21 CY
STAGE 3	4 CY	66 CY	12 CY

	CUT	FILL	UNSUITABLE
STAGE 1	17 CY	27 CY	0 CY
STAGE 2	0 CY	0 CY	0 CY
STAGE 3	3 CY	28 CY	5 CY

**B** Bollinger, Lach & Associates, Inc.  
ITASCA, ILLINOIS

USER NAME = gellwanger	DESIGNED - GJE	REVISED -
PLOT SCALE = 10,0000' / IN.	DRAWN - DC	REVISED -
PLOT DATE = 9/7/2011	CHECKED - JP	REVISED -
	DATE - 09/08/11	REVISED -

STATE OF ILLINOIS  
DEPARTMENT OF TRANSPORTATION

V: 1"=5'	CROSS SECTIONS	
SCALE: H: 1"=10'	75TH STREET	
SHEET NO. 188 OF 198 SHEETS	STA. 572+77.11	TO STA. 573+00.00

F.A.P. RTE. 0369	SECTION 07-00232-04-WR	COUNTY DUPAGE	TOTAL SHEETS 198	SHEET NO. 188
CONTRACT NO. 63632			ILLINOIS FED. AID PROJECT	

FILE NAME = F:\451-038 75th st dupage det\engr\engr\dr\rauga\451-038-011-xshh\75th pipe -redesign.dgn