

CONTROL POINT #10
NOT SHOWN

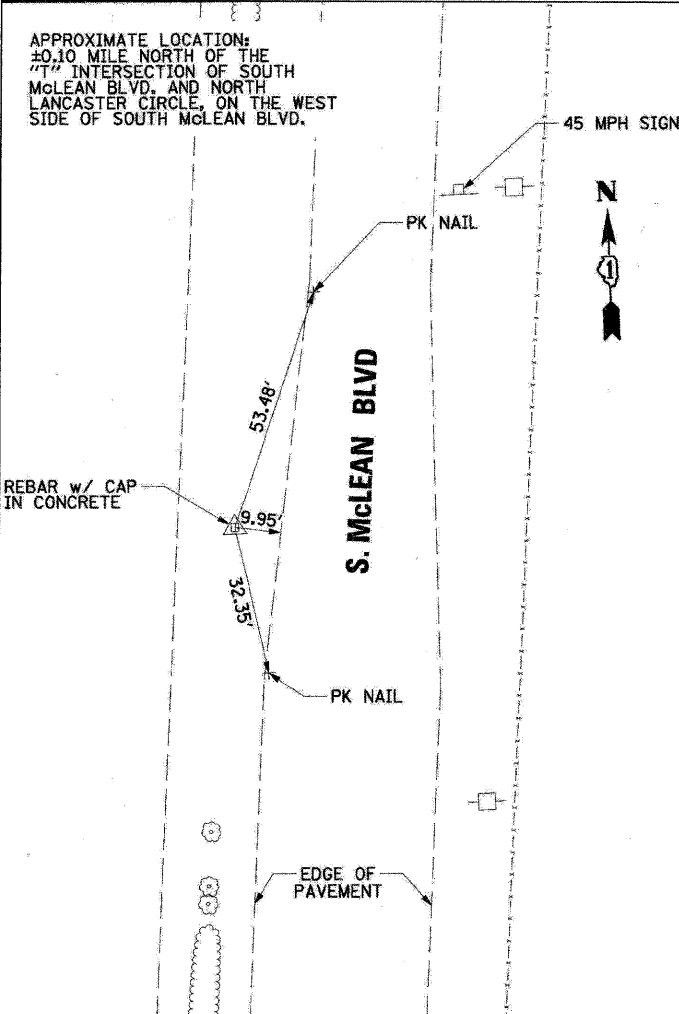

CONTROL POINT #11
NOT SHOWN

BENCHMARKS

- BENCHMARK #15**
"ALUMINUM DISK" SET IN CONCRETE AT THE SOUTHWEST CORNER OF IL RTE 31 AND MCLEAN BLVD. ELEV. 716.31 (NGVD 29)
- REFERENCE MARK #12**
A STANDARD U.S. GEOLOGICAL SURVEY DISK SET IN THE SOUTH HEADWALL OF A BRIDGE LOCATED ON STATE ROUTE 31, ABOUT 130 FEET WEST OF MCLEAN BLVD. ELEV. 710.37 (NGVD 29)
- SITE BENCHMARK**
CHISLED SQAURE ON WEST SIDE OF LIGHT POLE FOUNDATION LOCATED IN THE MEDIAN OF LANCASTER CIRCLE ON THE EAST SIDE WAS SOUTH MCLEAN BLVD. ELEV. 778.13 (NGVD 29)

NOTE:
ALIGNMENT, BENCHMARK, AND CONTROL POINT INFORMATION, WITH EXCEPTION OF TRAIL ALIGNMENTS AND SITE BENCHMARK, HAVE BEEN PROVIDED BY CONSULTANTS FROM PREVIOUS STEARNS ROAD CONTRACTS (63073, 63074, 63075, AND 63076).

LEGEND

⊙ = BENCHMARK LOCATION

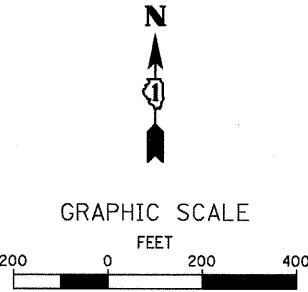

FILE NAME = \\MAP\projects\2011\110131 Stearns Rd\2011\110131.dgn

WILLS BURKE KELSEY ASSOCIATES LTD. 116 West Main Street, Suite 201 St. Charles, Illinois 60174	USER NAME = nparr15	DESIGNED - PJF	REVISED -	STATE OF ILLINOIS DEPARTMENT OF TRANSPORTATION	MCLEAN BLVD ENVIRONMENTAL ADAPTIVE MANAGEMENT PLANS ALIGNMENT, TIES AND BENCHMARKS	F.A.P. RTE. 361	SECTION 06-00214-11-LS	COUNTY KANE	TOTAL SHEETS 54	SHEET NO. 7	
	PLOT SCALE = 1"=200'	CHECKED - PDK	REVISED -			SCALE: 1"=200'	SHEET NO. 1 OF 2 SHEETS	STA. TO STA.	FED. ROAD DIST. NO. ILLINOIS	FED. AID PROJECT	CONTRACT NO. 63638
	PLOT DATE = 8/30/2011	DATE - 8/29/11	REVISED -								