

PLAN	REVISIONS	DATE
NO.	NO.	
NO.	NO.	
NO.	NO.	
NO.	NO.	
NO.	NO.	
NO.	NO.	
NO.	NO.	
NO.	NO.	
NO.	NO.	

PROFILE	REVISIONS	DATE
NO.	NO.	
NO.	NO.	
NO.	NO.	
NO.	NO.	
NO.	NO.	
NO.	NO.	
NO.	NO.	
NO.	NO.	
NO.	NO.	

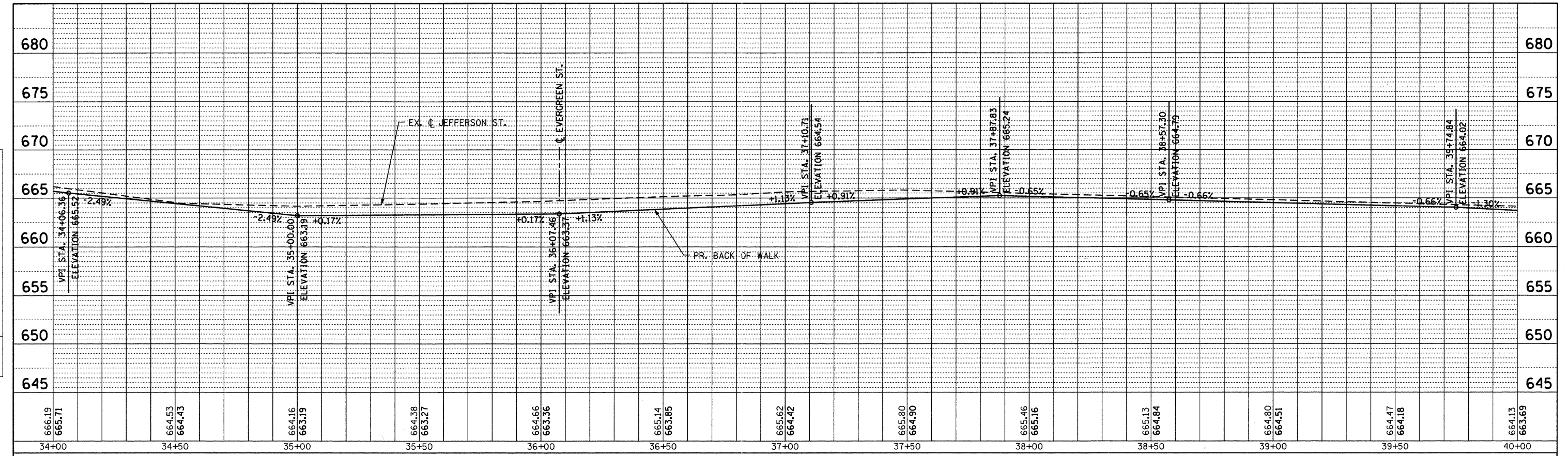

**SOUTH SIDE - JEFFERSON ST**

NO LONGITUDINAL SLOPES EXCEED 5%. ALL SIDEWALKS ADA COMPLIANT.

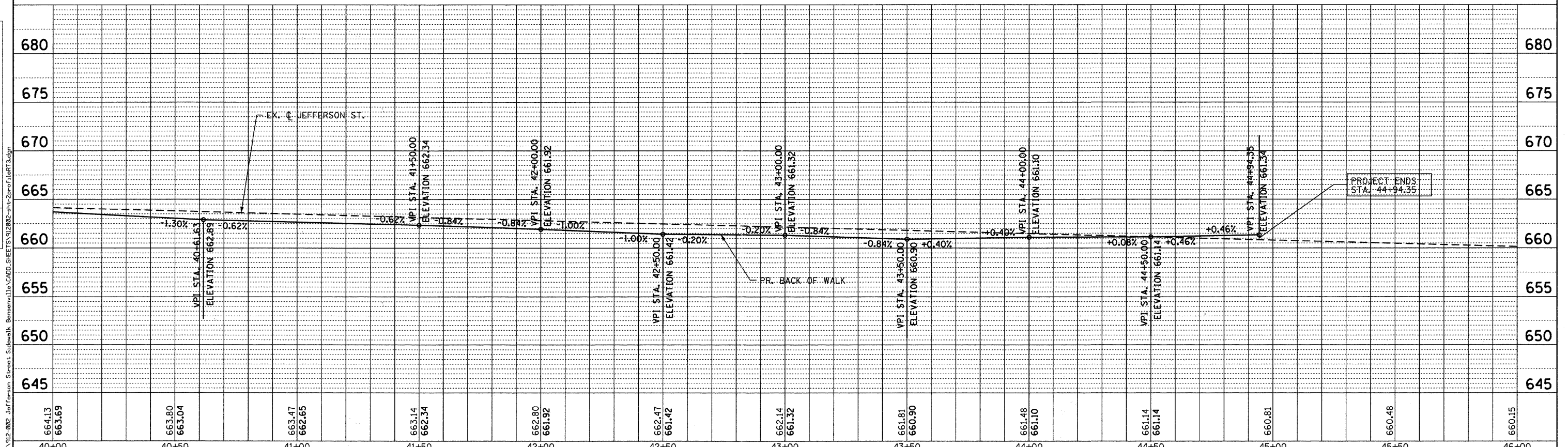

**Bollinger, Lach & Associates, Inc.**  
 MASCA, ILLINOIS

USER NAME = delj	DESIGNED - BPD	REVISED -
PLOT SCALE = 20.0000' / IN.	DRAWN - MTC	REVISED -
PLOT DATE = 8/29/2011	CHECKED - BPD	REVISED -
	DATE - 08-29-2011	REVISED -

**STATE OF ILLINOIS  
 DEPARTMENT OF TRANSPORTATION**

**PROFILE - BACK OF WALK - SOUTH SIDE**

SCALE: 1"=20' HZ  
 1"=5' VT

SHEET NO. 19 OF 38 SHEETS  
 STA. 34+00 TO STA. 45+50

F.A.U. RTE.	SECTION	COUNTY	TOTAL SHEETS	SHEET NO.
1370	11-00088-00-SW	DUPAGE	38	19
CONTRACT NO. 63639			ILLINOIS FED. AID PROJECT	

FILE NAME = W:\12-002 Jefferson Street Sidewalk Bensenville\11a\CADD\SHEET\19-2002-ahz-2pr-f1.lefT3.dgn