

FRAMING PLAN

* Temporary Cross Frame to be used until closure pour is complete and then replaced with permanent cross frame, CFI.

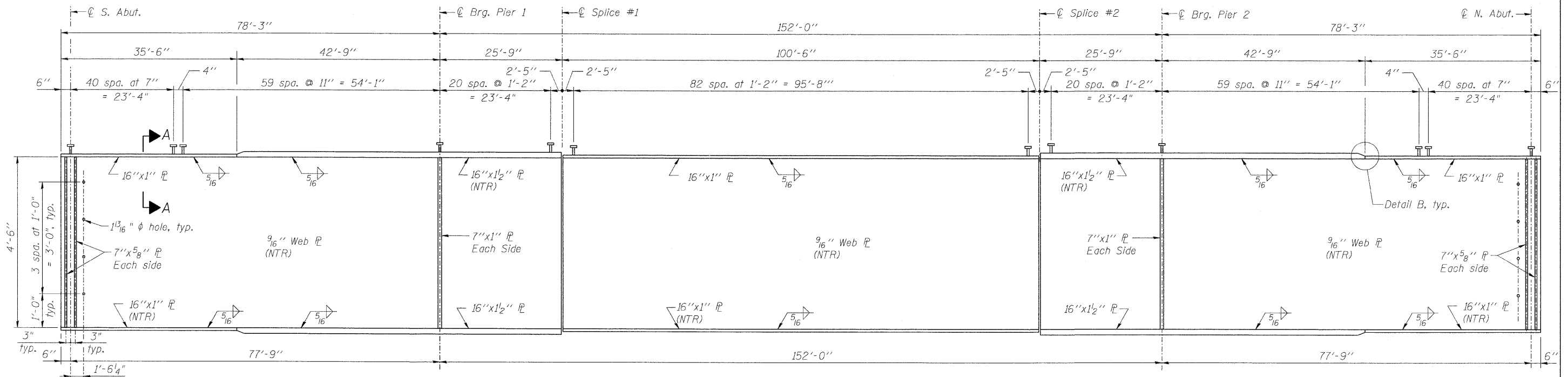

GIRDER ELEVATION

"NTR" denotes plates to which notch toughness requirements are applicable.

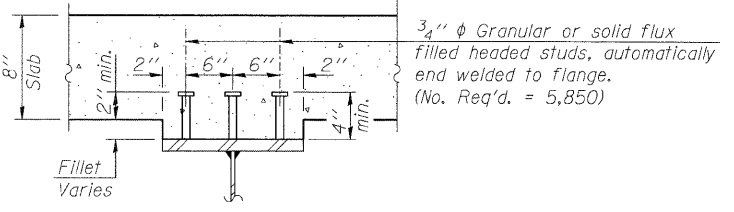

SECTION A-A

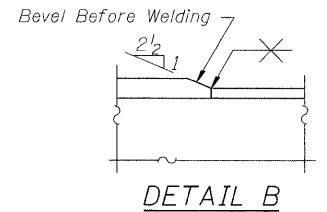

DETAIL B

NOTES

1. All cross frames or diaphragms shall be installed as steel is erected and secured with erection pins and bolts except as otherwise noted. Individual cross frames or diaphragms at supports may be temporarily disconnected to install bearing anchor rods.
2. See Sheet 17 for details of Temporary Cross Frames along Stage Construction Line in Span 2.
3. Load carrying components designated "NTR" shall conform to the Impact Testing Requirements given in the special provision for Structural Steel for Bridges.
4. Girder plates and bearing stiffeners shall be Grade 50 Structural Steel **.

** See Special Provision for Structural Steel for Bridges

TA 5015-Phase II, IL-281L-265-StructVdgn, IL2.dgn \07120917-64D16-015-FP1.dgn

LOCHNER H.W. LOCHNER, INC. CONSULTING ENGINEERS AND PLANNERS 20 N. WACKER DRIVE, SUITE 1200 CHICAGO, ILLINOIS 60606	USER NAME =	DESIGNED - CMM	REVISED -	STATE OF ILLINOIS DEPARTMENT OF TRANSPORTATION	FRAMING PLAN STRUCTURE 071-0097 SHEET NO. 15 OF 26 SHEETS	F.A.P. RTE.	SECTION	COUNTY	TOTAL SHEETS	SHEET NO.
	FILE NAME = 07120917-64D16-015-FP1.dgn	CHECKED - JSD	REVISED -			742	38VBR-1		87	76
	PLOT SCALE =	DRAWN - EF	REVISED -			CONTRACT NO. 64D16				
	PLOT DATE =	CHECKED - JSD	REVISED -			ILLINOIS FED. AID PROJECT				