

# PRE-STAGE 1A

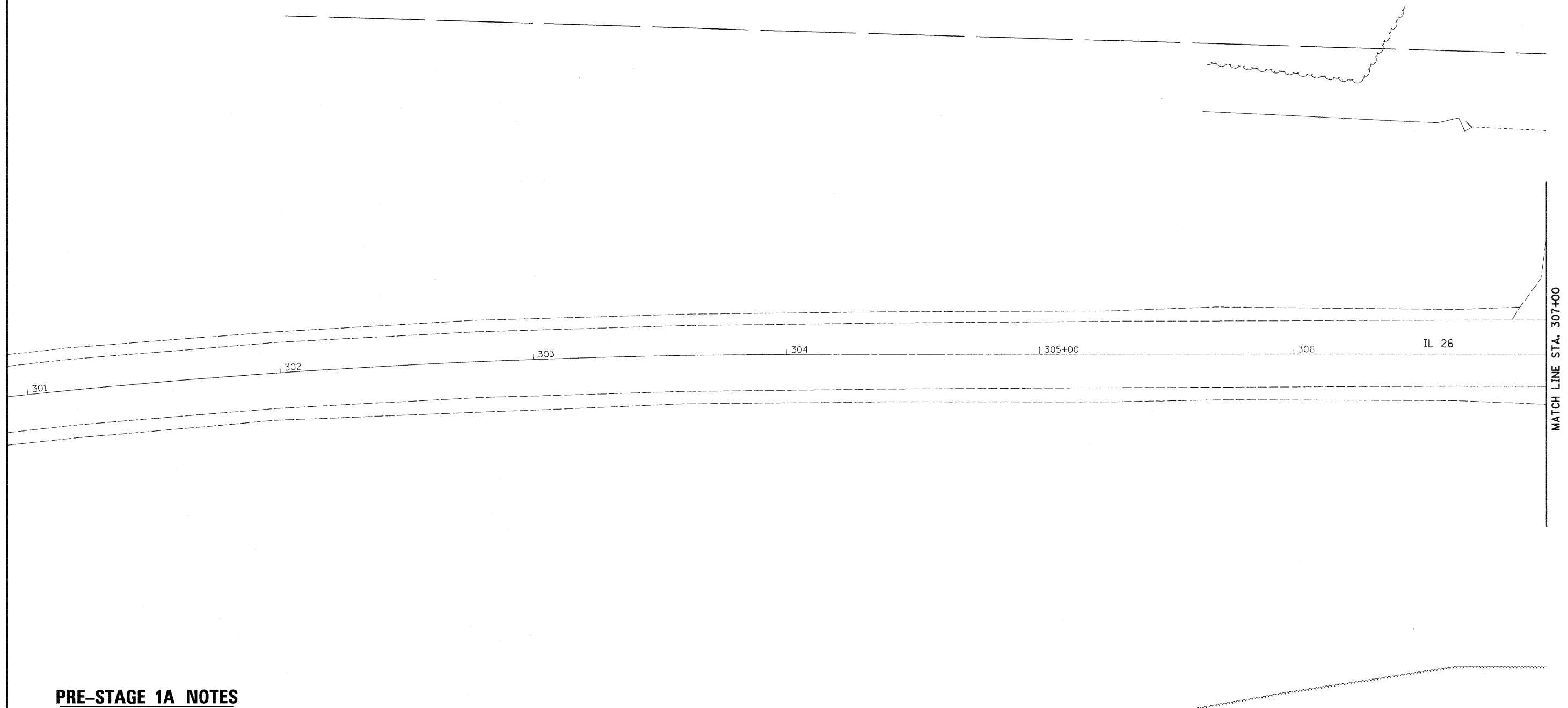

## PRE-STAGE 1A NOTES

1. USE STANDARD 7010326 FOR SHOULDER WORK.
2. PLACE SHOULDERS FROM STA. 309+00 LT TO STA. 310+84.66 LT. AND STA. 312+05.90 LT TO STA. 314+00 LT.

• 102BR-5, 102BR-6 & 102BR-7

|  |                                      |            |           |   |  |           |    |        |                       |              |                    |                        |                    |
|--|--------------------------------------|------------|-----------|---|--|-----------|----|--------|-----------------------|--------------|--------------------|------------------------|--------------------|
| FILE NAME =<br>c:\pwork\pwork\dot\grantpm\dms41810\0210807-sht-staging.dgn | USER NAME = grantpm                  | DESIGNED - | REVISED - | <b>STATE OF ILLINOIS<br/>DEPARTMENT OF TRANSPORTATION</b> | <b>IL 26 STAGING DETAILS<br/>S.N. 052-0081 PRE-STAGE 1</b> |           |    |        | F.A.P.<br>RTE.<br>316 | SECTION<br>* | COUNTY<br>LEE      | TOTAL<br>SHEETS<br>216 | SHEET<br>NO.<br>33 |
|  | PLOT SCALE = 20.0000' / 1in.         | DRAWN -    | REVISED - |   | SCALE:   | SHEET NO. | OF | SHEETS | STA.                  | TO STA.      | CONTRACT NO. 64D57 |                        |                    |
|  | PLOT DATE = Tue Aug 23 06:22:17 2011 | CHECKED -  | REVISED - |   | ILLINOIS FED. AID PROJECT                                  |           |    |        |                       |              |                    |                        |                    |
|  |                                      | DATE -     | REVISED - |   |  |           |    |        |                       |              |                    |                        |                    |