

STAGE 1

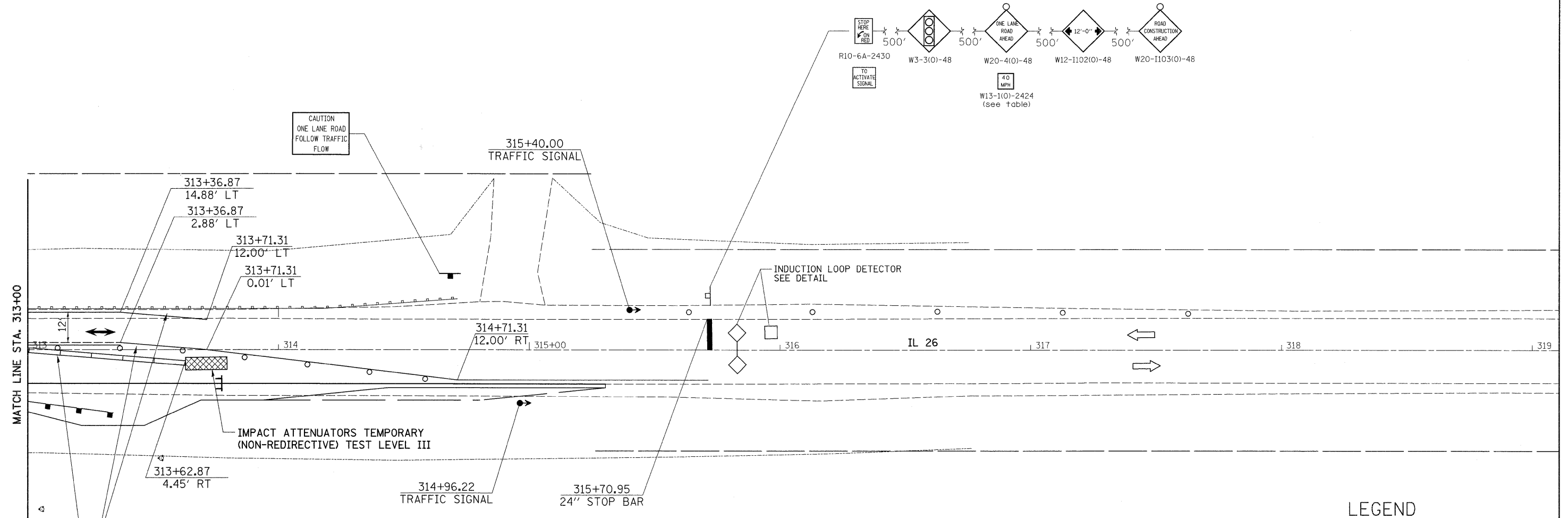
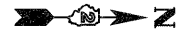

MATCH LINE STA. 313+00

STAGE 1 NOTES

1. USE STANDARD 701321.
2. CONSTRUCT BRIDGE RT TO STAGE CONSTRUCTION LINE.
3. CONSTRUCT TEMPORARY RAMPS.
4. INSTALL GUARDRAIL RT. EXISTING GUARDRAIL LT TO REMAIN IN PLACE

LEGEND

	= WORK ZONE
	= TYPE III BARRICADE WITH FLASHING LIGHTS
	= SIGN
	= BARRICADE, OR DRUM WITH STEADY BURNING LIGHTS
	= INDUCTION LOOP DETECTOR
	= TRAFFIC SIGNAL

• 102BR-5, 102BR-6 & 102BR-7

FILE NAME =	USER NAME = grantpm	DESIGNED -	REVISED -	STATE OF ILLINOIS DEPARTMENT OF TRANSPORTATION	IL 26 STAGING DETAILS S.N. 052-0081 STAGE 1			F.A.P. RTE. 316	SECTION *	COUNTY LEE	TOTAL SHEETS 216	SHEET NO. 38			
ct:\pw_work\pwwork\grantpm\dms41810\0210507-sht-staging.dgn		DRAWN -	REVISED -					SCALE: SHEET NO. OF SHEETS STA. TO STA.			CONTRACT NO. 64D57				
		PLOT SCALE = 20,0000' / in.	REVISED -												
		PLOT DATE = Tue Aug 23 06:22:20 2011	REVISED -												

ILLINOIS FED. AID PROJECT