

**STATE OF ILLINOIS  
DEPARTMENT OF TRANSPORTATION  
DIVISION OF HIGHWAYS**

FOR INDEX OF SHEETS AND STANDARDS,  
SEE SHEET NO. 2

# PROPOSED HIGHWAY PLANS

**FAP ROUTE 326 (IL 47)  
SECTION (5CS, 13C, 108, 109)R  
PROJECT: ACNHF-0326(083)  
KENDALL COUNTY  
C-93-064-05**

	ADT SOUTH END	ADT NORTH END	ADT DOWNTOWN
2012	15,500	22,700	27,000
2017	16,800	25,600	30,000

**DESIGN DESIGNATION**  
3600 (17) OTHER PRINCIPAL ARTERIAL (12.71)(PCC-20)  
CLASS II TRUCK ROUTE

**PAVEMENT RECONSTRUCTION, LANE ADDITIONS,  
STORM SEWER, AND TRAFFIC SIGNALS, NORTH OF IL 71  
TO SOUTH OF KENNEDY DRIVE IN THE CITY OF YORKVILLE**

**METRIC RATIOS**

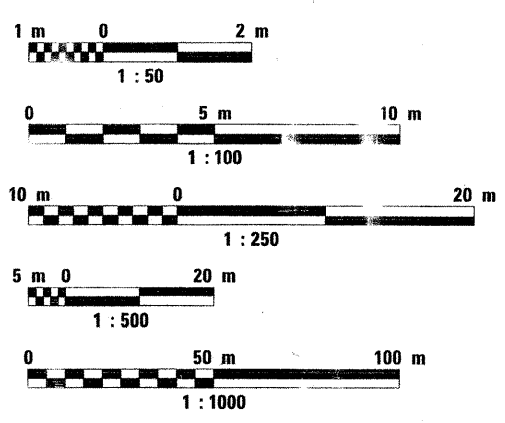

FULL SIZE PLANS HAVE BEEN PREPARED USING  
STANDARD ENGINEERING SCALES. REDUCED SIZED  
PLANS WILL NOT CONFORM TO STANDARD SCALES.  
IN MAKING MEASUREMENTS ON REDUCED PLANS,  
THE ABOVE SCALES MAY BE USED.

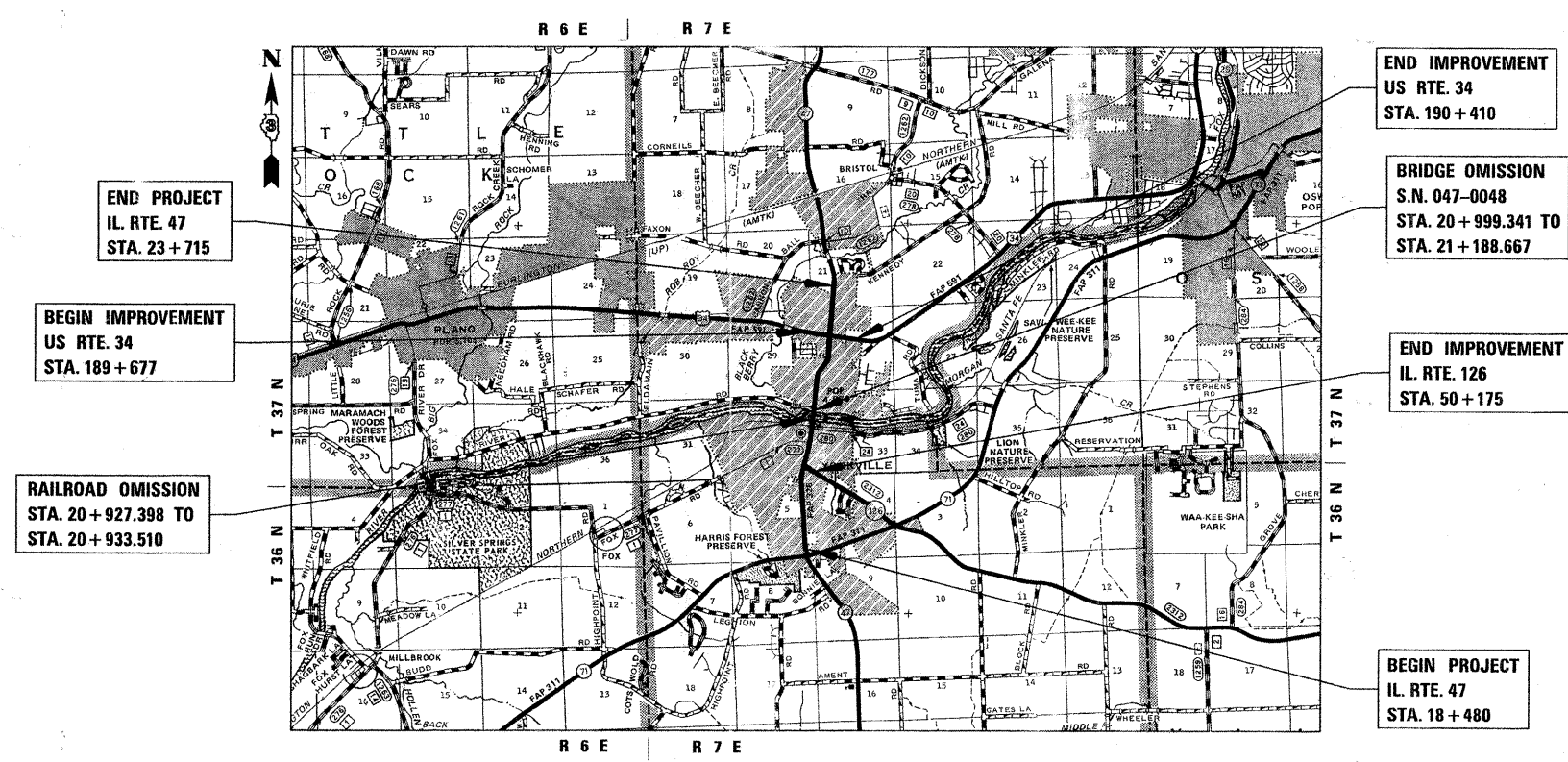
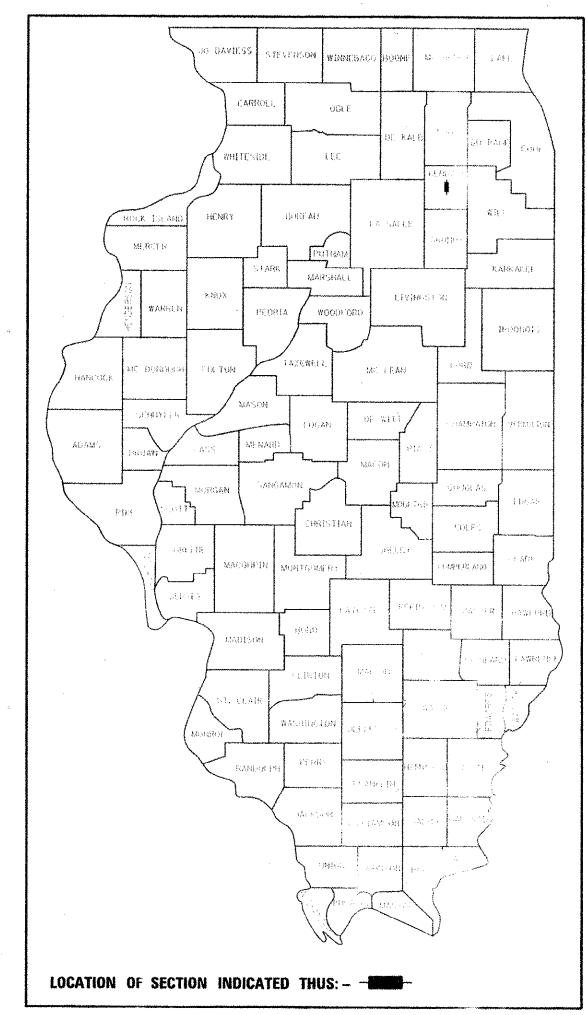

**LOCATION MAP**  
SCALE: NONE

GROSS LENGTH OF IMPROVEMENT	= 5,235 METERS	= 5.235 KILOMETERS
ROAD AND BRIDGE OMISSIONS	= 195.438 METERS	= 0.195438 KILOMETERS
NET LENGTH OF IMPROVEMENT	= 5,039.562 METERS	= 5.039562 KILOMETERS

**STATE OF ILLINOIS  
DEPARTMENT OF TRANSPORTATION  
DIVISION OF HIGHWAYS**

SUBMITTED 09/01 20 11

Evan S. Thurler  
DEPUTY DIRECTOR OF HIGHWAYS, REGION ENGINEER

October 14 20 11  
Scott E. Stett P.E.  
acting ENGINEER OF DESIGN AND ENVIRONMENT

October 14 20 11  
Christine M. Road  
DIRECTOR OF HIGHWAYS, CHIEF ENGINEER

**PRINTED BY THE AUTHORITY  
OF THE STATE OF ILLINOIS**

U.L.I.E.  
PRINT UTILITY LOCATION INFORMATION FOR EXCAVATION  
800-892-0123

**NOT DISTRICT 3 - (618) 434-6131**  
**PROJECT ENGINEER: DAVID REED, PE**  
**ROAD LEADER: BRAD JUNCAN, PE**  
**CONTRACT NO. 66671**

PLANS PREPARED BY

**HMG**  
ENGINEERS  
SURVEYORS

HMG Engineers, Inc.  
1075 Lake Road • P.O. Box 70 • Carlyle, Illinois 62231  
Phone: 618-594-3711 • Fax: 618-594-8217  
www.hmgengineers.com

Scott A. Rakers  
P.E.  
ILLINOIS REGISTERED ENGINEER NO. 062-049177  
EXPIRES NOV. 30, 2011