

F.A.P. RTE.	SECTION	COUNTY	TOTAL SHEETS	SHEET NO.
326	(5CS,13C,108,109)R	KENDALL	931	164
STA. TO STA.		ILLINOIS FED. AID PROJECT		
FED. ROAD DIST. NO.		ILLINOIS FED. AID PROJECT		

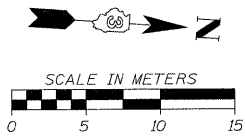

TBM STA. 19+200.257, 19.046m RT.
RR SPIKE IN 3RD POWER POLE NORTH
OF GREENBRIAR RD. ELEV. 210.370

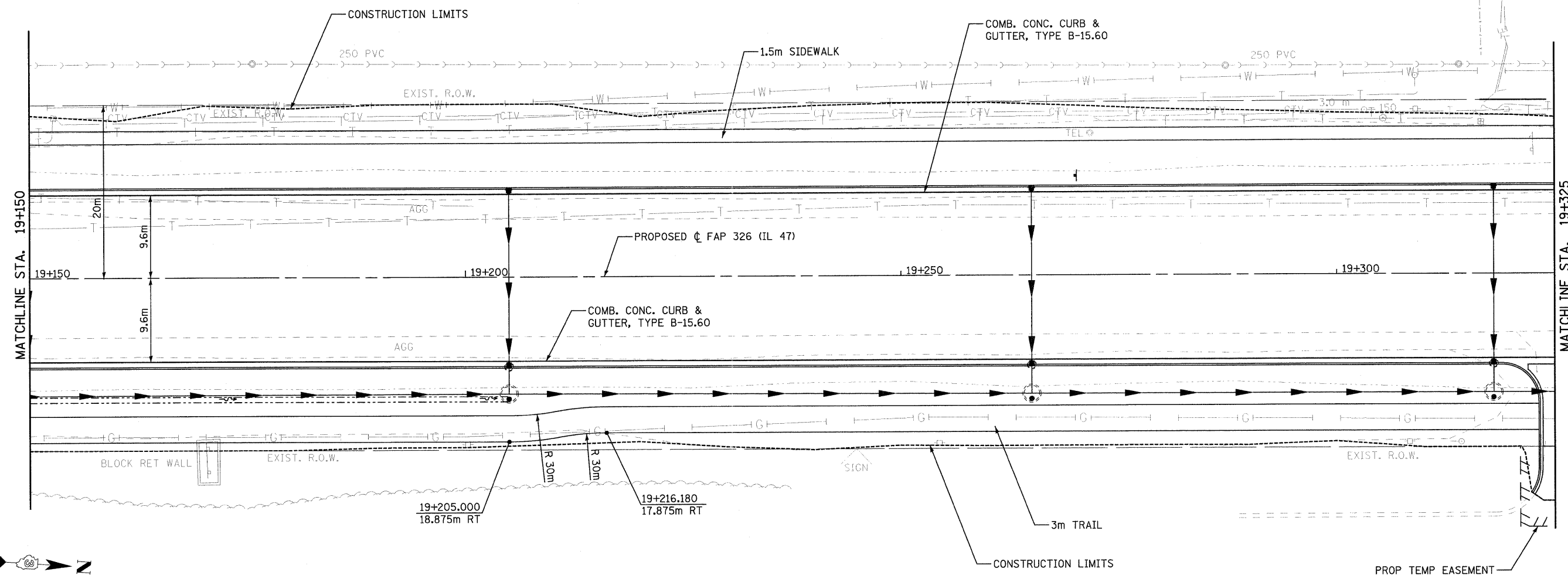
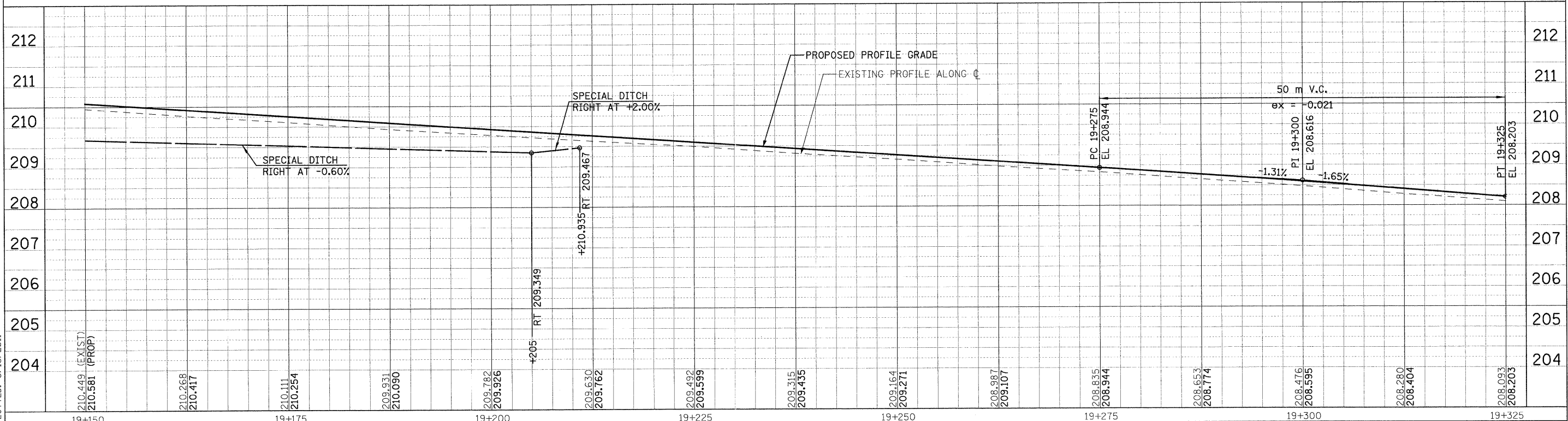

FILE: 164pp47_08.dgn
PLOTTED: 8/13/2011

Sheet: 8
Angle: 93.9081
Color: P_11.47

HMG JOB NO. 5122