

F.A.P. RTE.	SECTION	COUNTY	TOTAL SHEETS	SHEET NO.
326	(5CS,13C,108,109R)	KENDALL	931	189
STA. TO STA.		FED. ROAD DIST. NO. ILLINOIS FED. AID PROJECT		

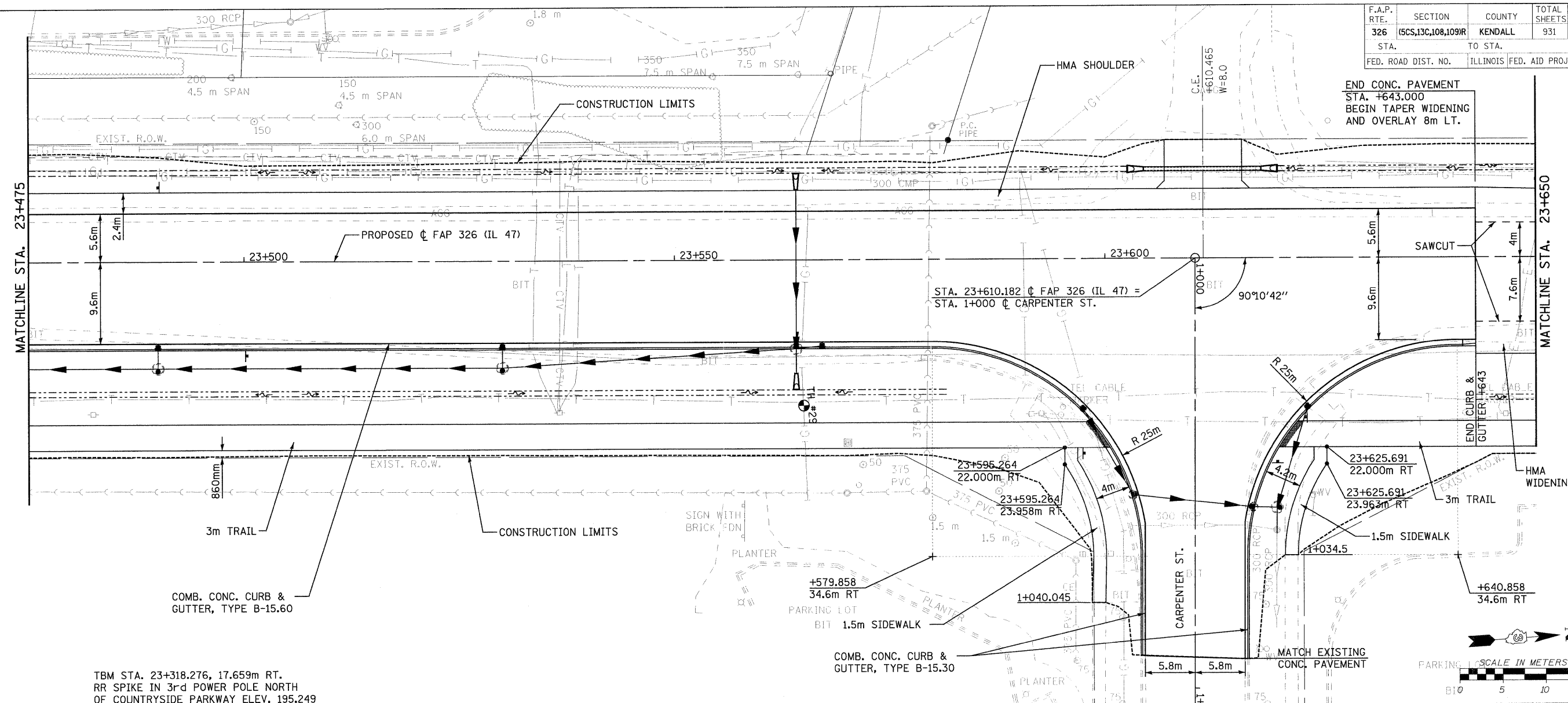

TBM STA. 23+318.276, 17.659m RT.
RR SPIKE IN 3rd POWER POLE NORTH
OF COUNTRYSIDE PARKWAY ELEV. 195.249

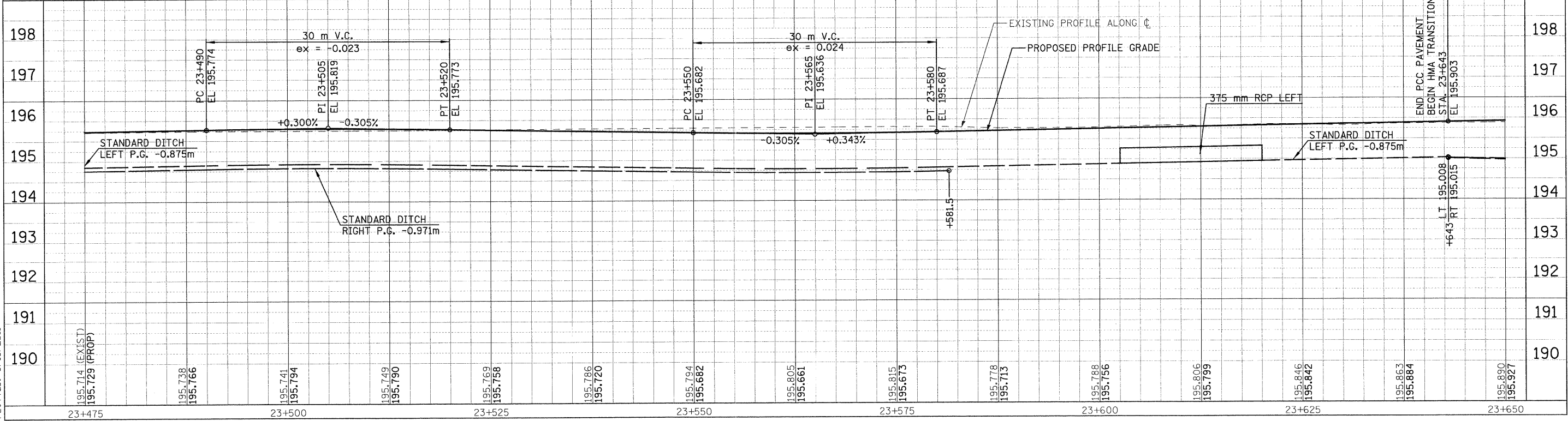
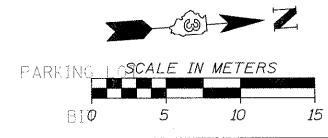

FILE: 189pp47-33.dgn
PLOTTED: 8/13/2011
Sheet: 32
Angle: 85.6535
Color: P.11.47

HMG JOB NO. 5122