

F.A.P. RTE.	SECTION	COUNTY	TOTAL SHEETS	SHEET NO.
326	(SCS,13C,108,109)R	KENDALL	931	192
STA.	TO STA.			
FED. ROAD DIST. NO.	ILLINOIS	FED. AID PROJECT		

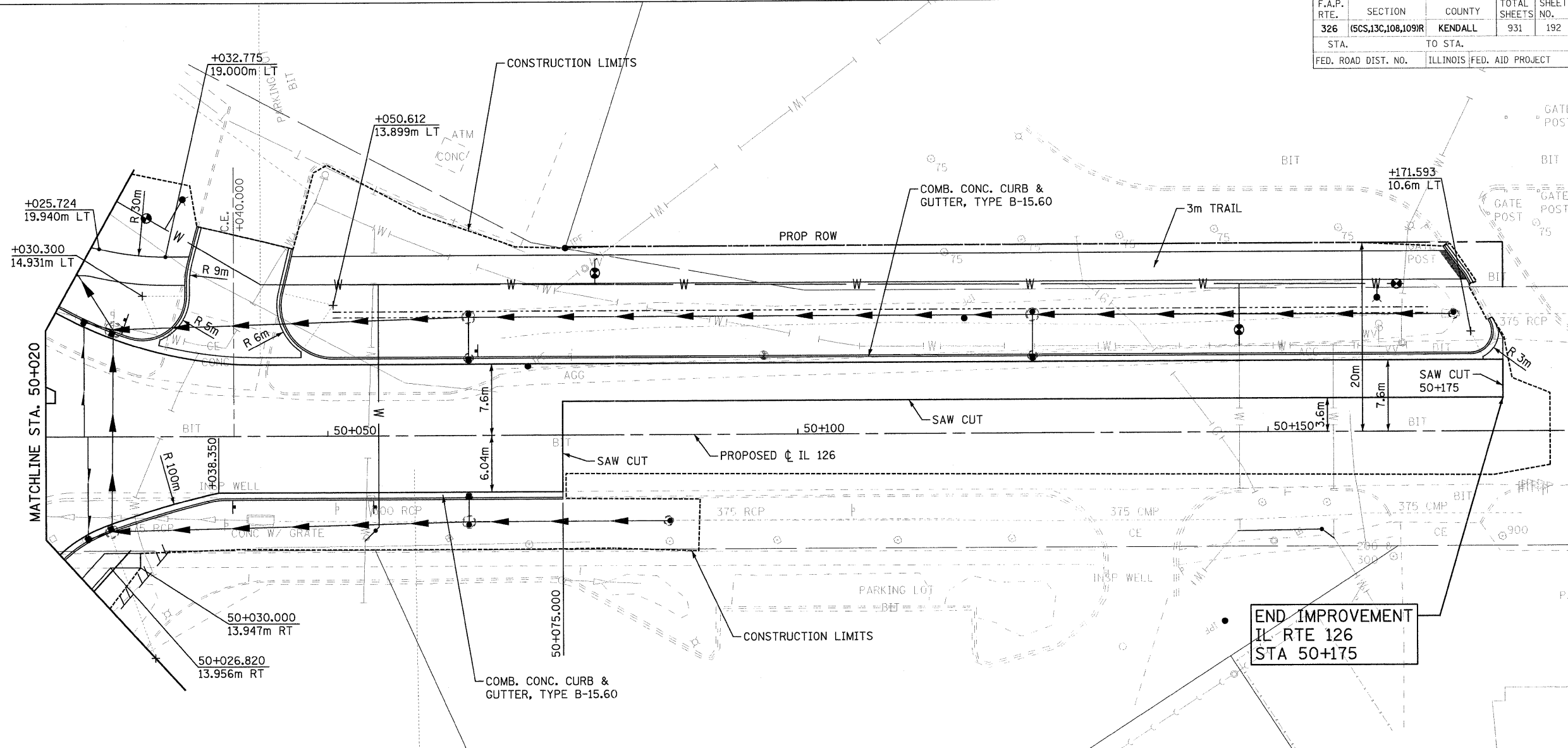

SEE IL. RTE. 47 FOR CONTINUATION

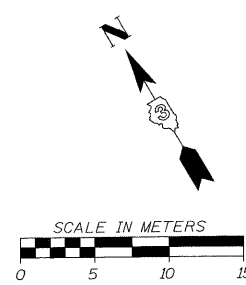

END IMPROVEMENT
IL RTE 126
STA 50+175

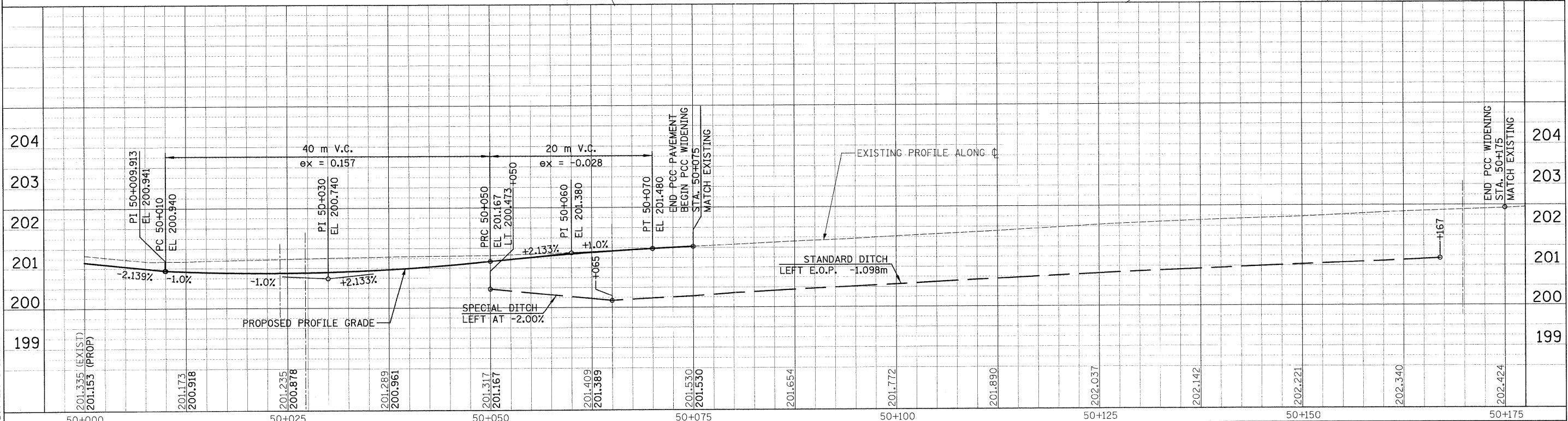

FILE: 192ppt\126.1.dgn
PLOTTED: 8/13/2011

HMG JOB NO. 5122