

F.A.P. RTE.	SECTION	COUNTY	TOTAL SHEETS	SHEET NO.
326	(5CS,13C,108,109)R	KENDALL	931	225
STA.		TO STA.		
FED. ROAD DIST. NO.		ILLINOIS FED. AID PROJECT		

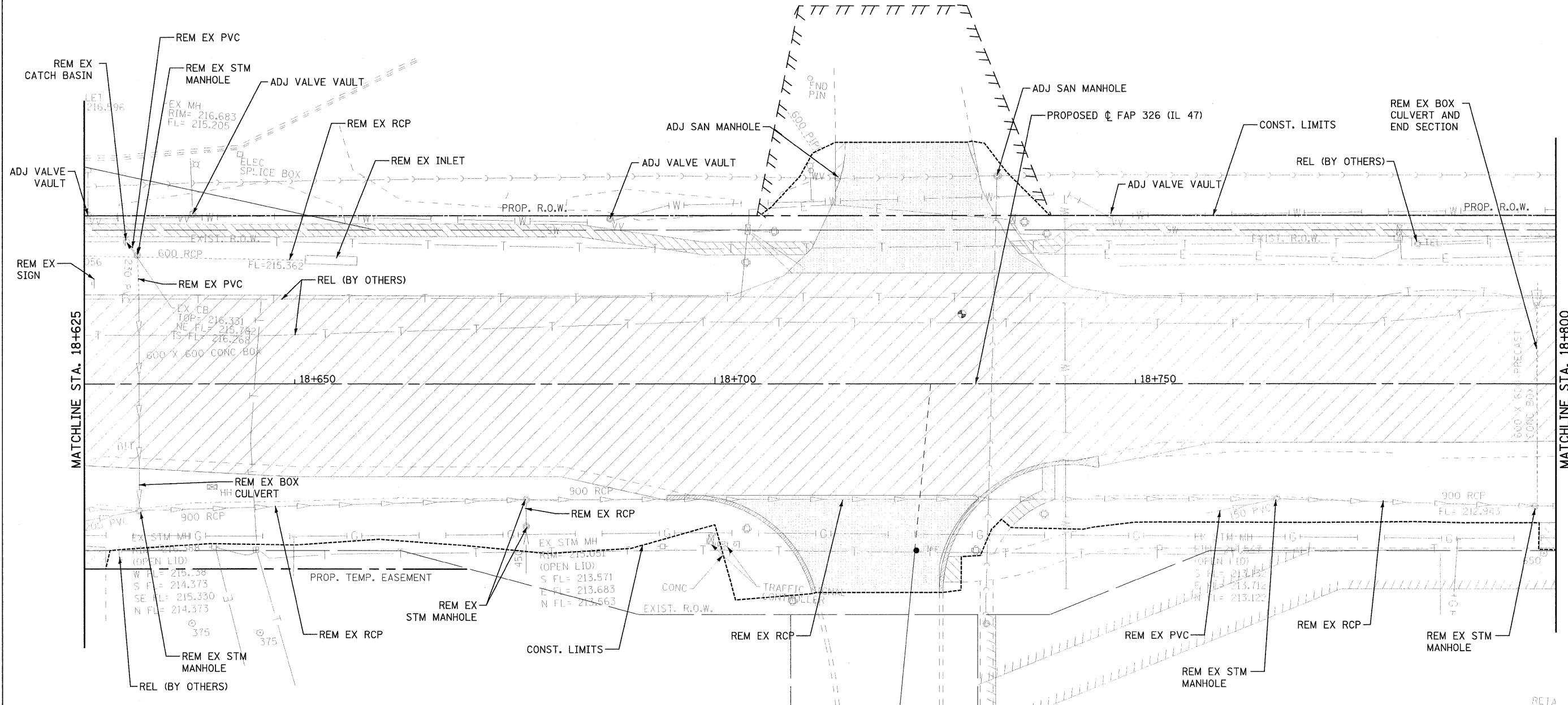

- X TREE REMOVAL
- REM REMOVE
- ADJ ADJUST
- REL RELOCATE
- [Hatched Pattern] PAVEMENT REMOVAL
- [Hatched Pattern] COMBINATION CURB AND GUTTER REMOVAL
- [Hatched Pattern] DRIVEWAY PAVEMENT REMOVAL
- [Hatched Pattern] SIDEWALK REMOVAL
- [Hatched Pattern] MEDIAN REMOVAL
- [Hatched Pattern] PAVED DITCH REMOVAL
- [Hatched Pattern] HMA SURFACE REMOVAL
- [Hatched Pattern] ISLAND REMOVAL

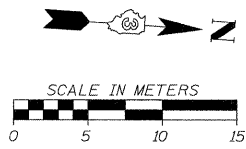

NOTE: SEE SIGNAL PLANS FOR SIGNAL EQUIPMENT REMOVALS.

FILE: 225-em47\_05.dgn  
 PLOTTED: 8/11/2011  
 Sheet: 5  
 Angle: 93.0081  
 Origin: P.11.47

HMG JOB NO. 5122