

F.A.P. RTE.	SECTION	COUNTY	TOTAL SHEETS	SHEET NO.
326	5CS,13C,108,109R	KENDALL	931	247
STA.		TO STA.		
FED. ROAD DIST. NO.		ILLINOIS FED. AID PROJECT		

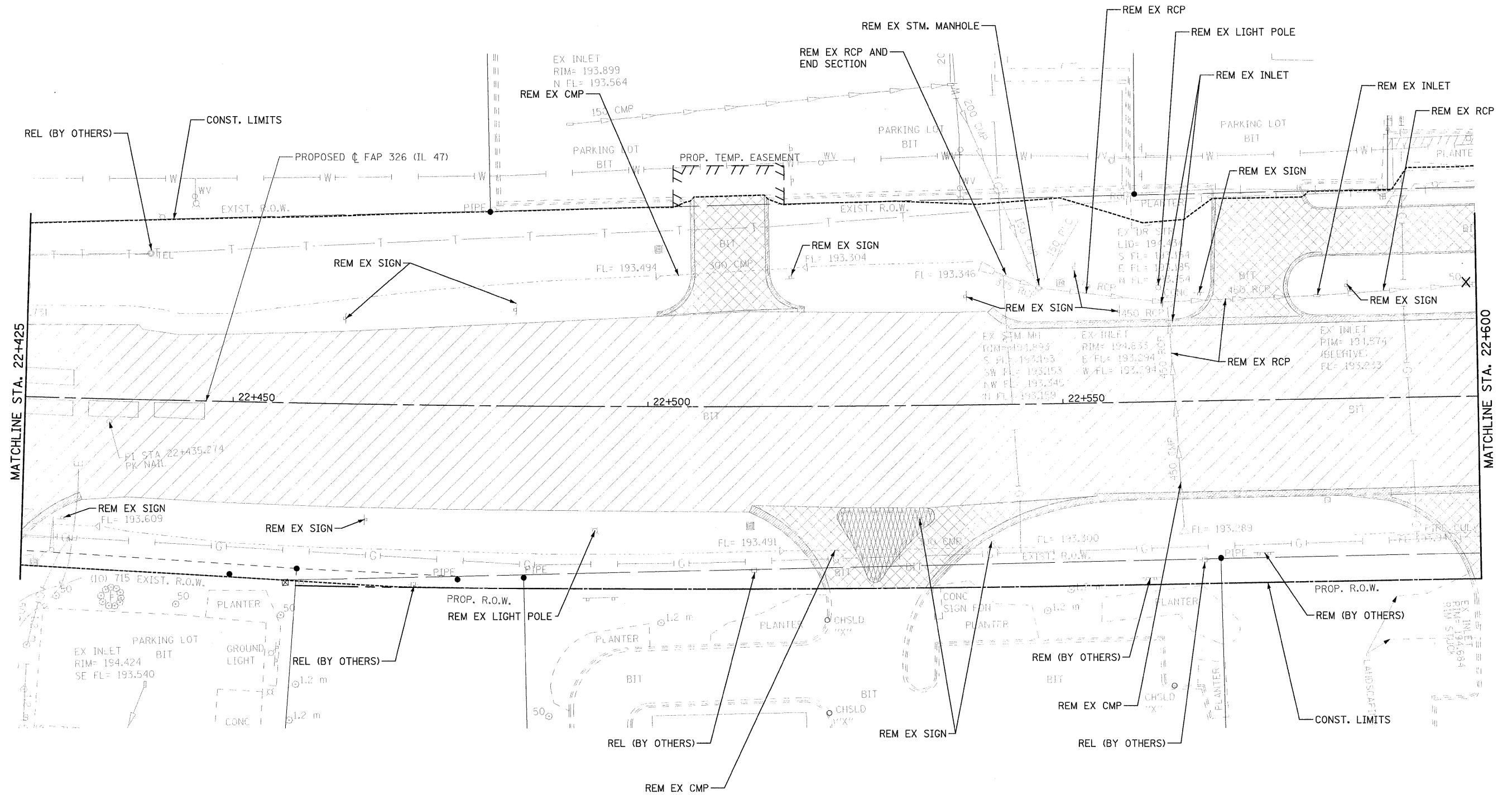

- X TREE REMOVAL
- REM REMOVE
- ADJ ADJUST
- REL RELOCATE
- [Hatched Box] PAVEMENT REMOVAL
- [Hatched Box] COMBINATION CURB AND GUTTER REMOVAL
- [Hatched Box] DRIVEWAY PAVEMENT REMOVAL
- [Hatched Box] SIDEWALK REMOVAL
- [Hatched Box] MEDIAN REMOVAL
- [Hatched Box] PAVED DITCH REMOVAL
- [Hatched Box] HMA SURFACE REMOVAL
- [Hatched Box] ISLAND REMOVAL

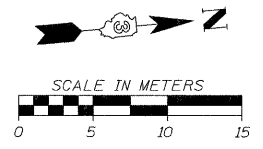

NOTE: SEE SIGNAL PLANS FOR SIGNAL EQUIPMENT REMOVALS.

FILE: 247rem47_27.dgn
PLOTTED: 8/11/2011

Sheet: 27
Angle: 84.1257
Choir: P.L.47

HMG JOB NO. 5122