

F.A.P. RTE.	SECTION	COUNTY	TOTAL SHEETS	SHEET NO.
326	(SCS,13C,108,109)R	KENDALL	931	292
STA.		TO STA.		
FED. ROAD DIST. NO.		ILLINOIS FED. AID PROJECT		

NOTES:
 1. THE CLOSURE OF SOMONAUK STREET SHALL BE LIMITED TO NO MORE THAN 30 WORKING DAYS AND SHALL BE SCHEDULED SO THAT UPON COMPLETION, THE PROJECT SHALL TRANSITION TO STAGE 2. THIS CLOSURE SHALL NOT OCCUR UNTIL SPRING STREET HAS BEEN COMPLETED AND REOPENED TO TRAFFIC. THIS SHEET DEPICTS THE CHANGES/ADDITIONS TO THE TRAFFIC CONTROL REQUIRED DURING THE CLOSURE OF SOMONAUK STREET.

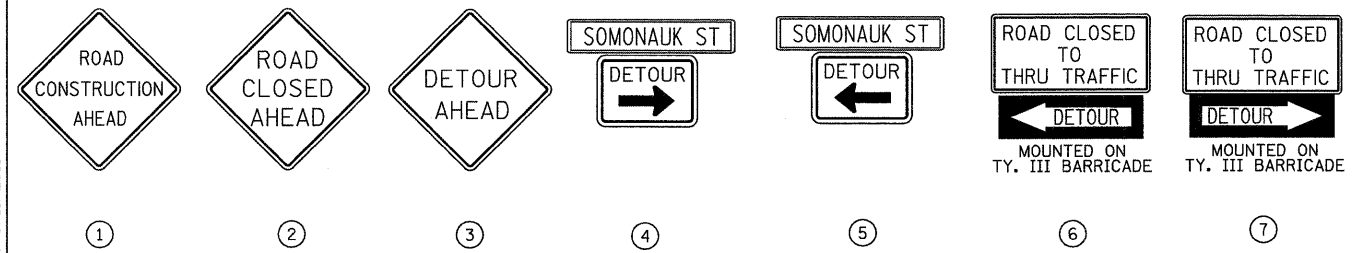
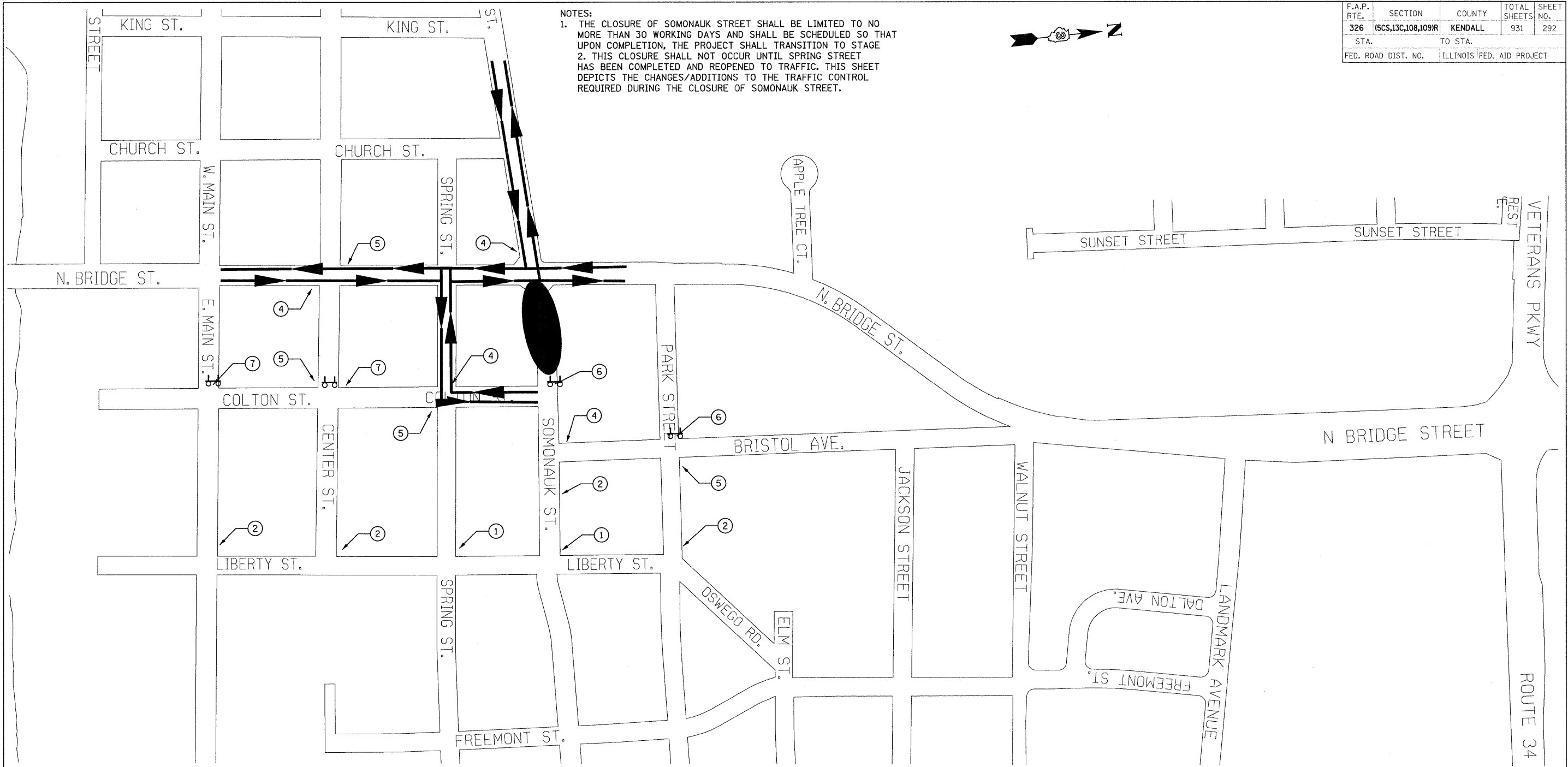

FILE: 292TC.plen_Stage1B_SomoDetour_01.dgn
 PLOTTED: 8/11/2011

HMG JOB NO. 5122