

F.A.P. RTE.	SECTION	COUNTY	TOTAL SHEETS	SHEET NO.
326	(SCS,13C,108,109)R	KENDALL	931	364
STA.	TO STA.			
FED. ROAD DIST. NO.	ILLINOIS FED. AID PROJECT			

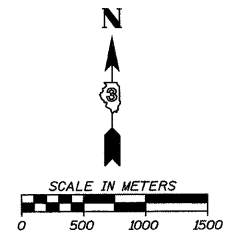

DETOUR ROUTE

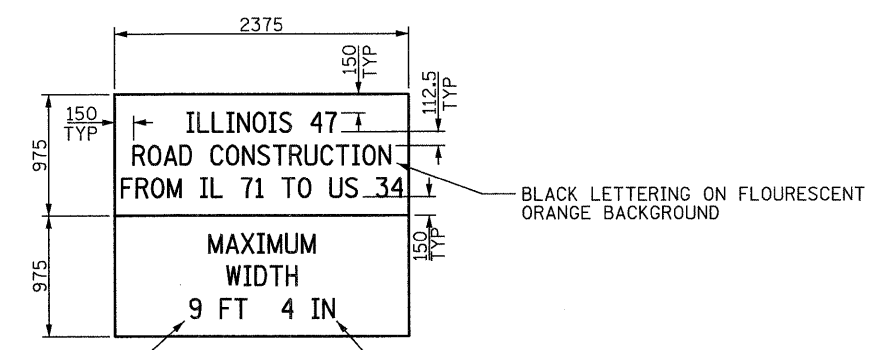
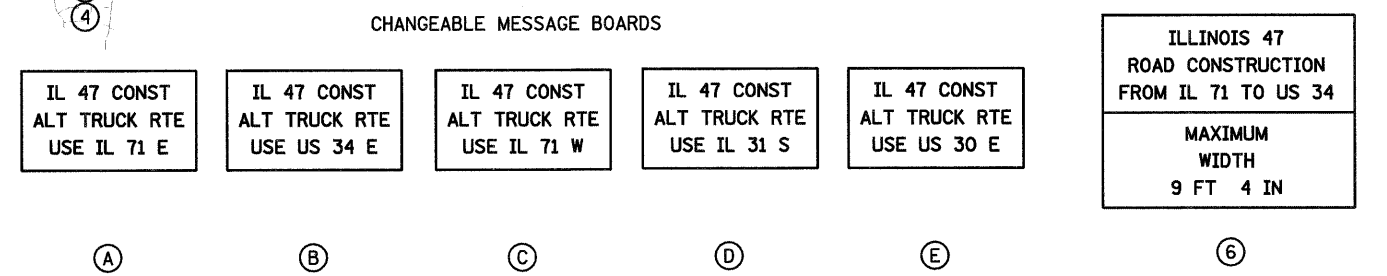
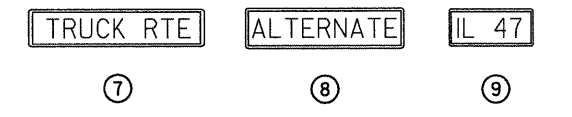
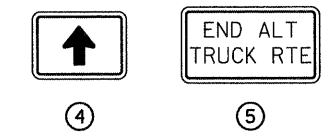
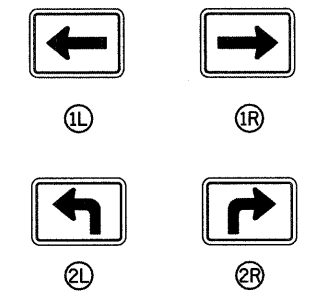
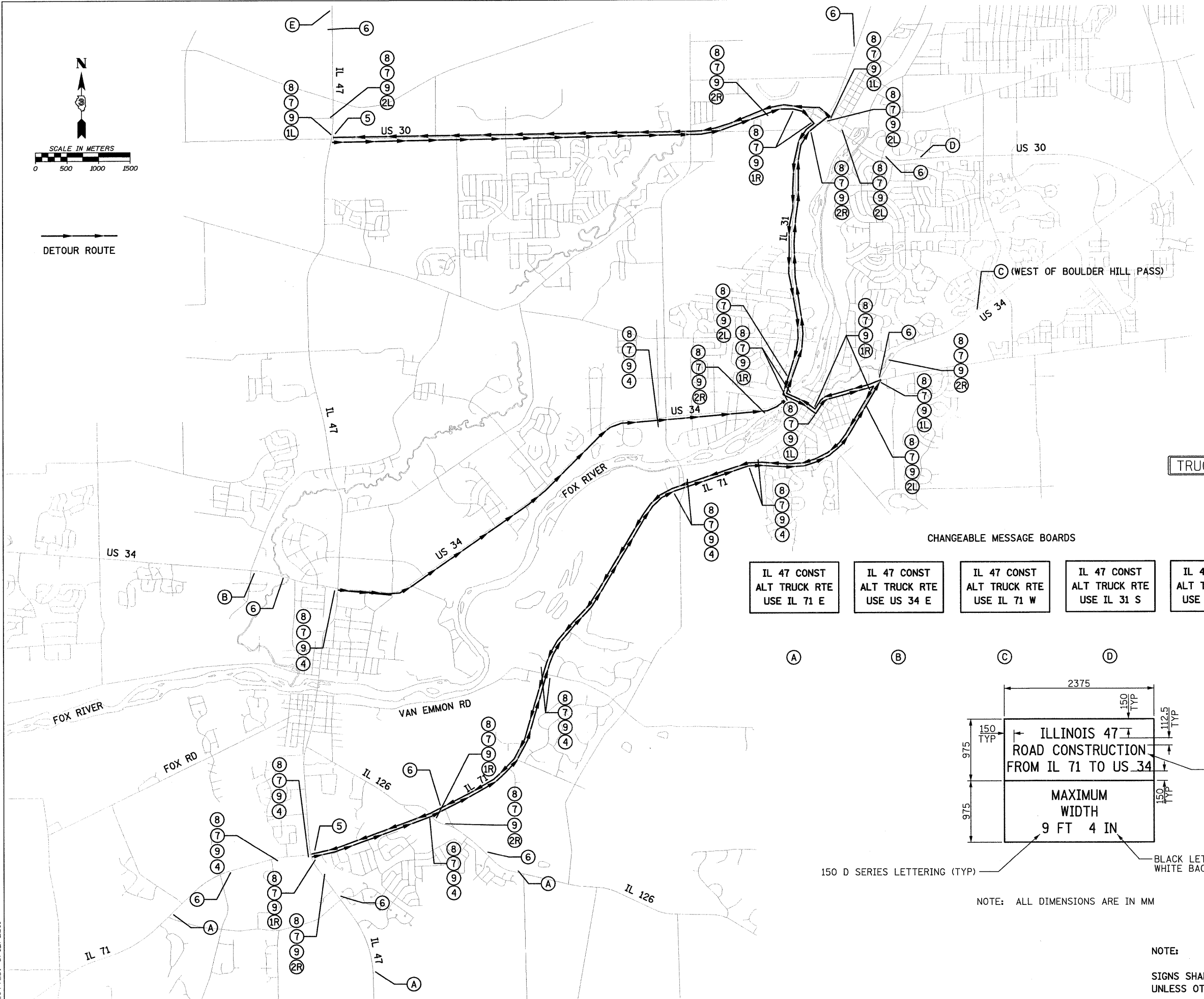

150 D SERIES LETTERING (TYP)

NOTE: ALL DIMENSIONS ARE IN MM

NOTE:  
SIGNS SHALL BE FLOURESCENT ORANGE WITH BLACK LETTERS UNLESS OTHERWISE NOTED.

FILE: 364\_Truck\_Rte\_Stage8.dgn  
PLOTTED: 8/12/2011

HMG JOB NO. 5122