

F.A.P. RTE.	SECTION	COUNTY	TOTAL SHEETS	SHEET NO.
326	(5CS,13C,108,109R)	KENDALL	931	368
STA.		TO STA.		
FED. ROAD DIST. NO.		ILLINOIS FED. AID PROJECT		

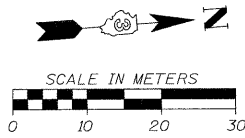

MATCHLINE STA. 1+150

MATCHLINE STA. 23+250

MATCHLINE STA. 22+900

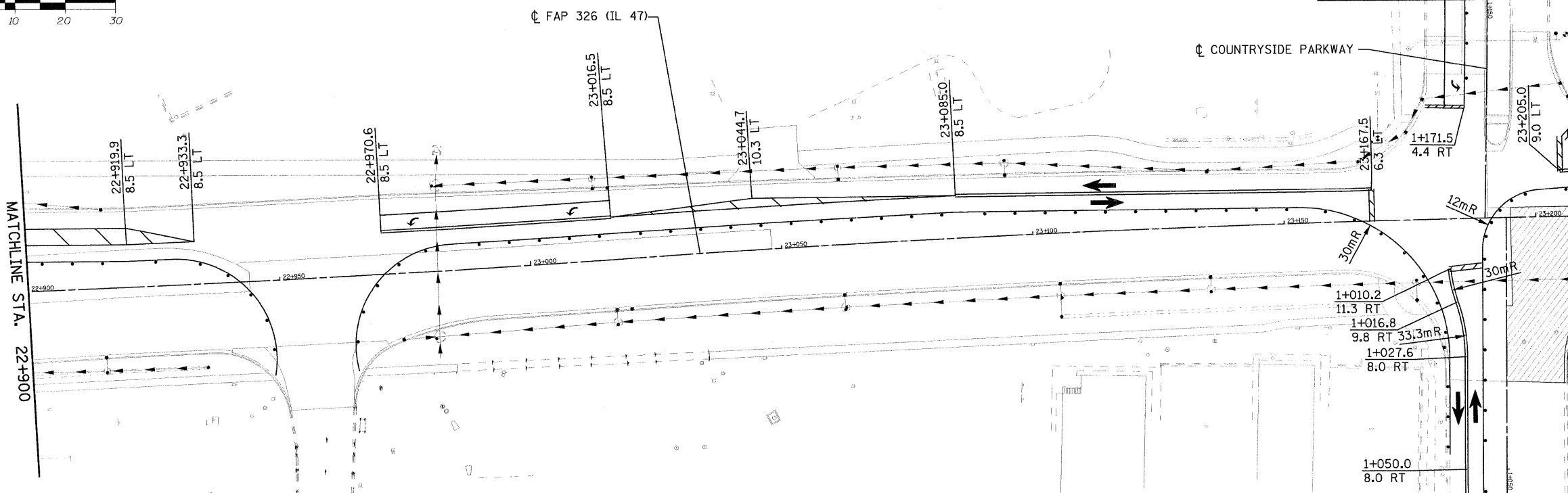

**LEGEND**

	CONSTRUCTION THIS STAGE		TEMPORARY CONCRETE BARRIER
	TEMPORARY PAVEMENT		IMPACT ATTENUATOR
	TRAFFIC FLOW		DRUM OR BARRICADE
	TEMPORARY PAVEMENT MARKING		TYPE III BARRICADE WITH FLASHING LIGHTS
	SIGN ON PORTABLE OR PERMANENT SUPPORT		

COUNTRYSIDE PARKWAY

MATCHLINE STA. 1+150

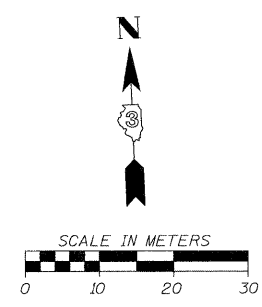

FILE: 368STAGE\_8\_47\_09.dgn  
PLOTTED: 8/11/2011

HMG JOB NO. 5122