

F.A.P. RTE.	SECTION	COUNTY	TOTAL SHEETS	SHEET NO.
326	(5CS,13C,108,109R)	KENDALL	931	474
STA.		TO STA.		
FED. ROAD DIST. NO.		ILLINOIS FED. AID PROJECT		

The Contractor shall confirm depths and locations of existing utilities and services prior to the start of construction.

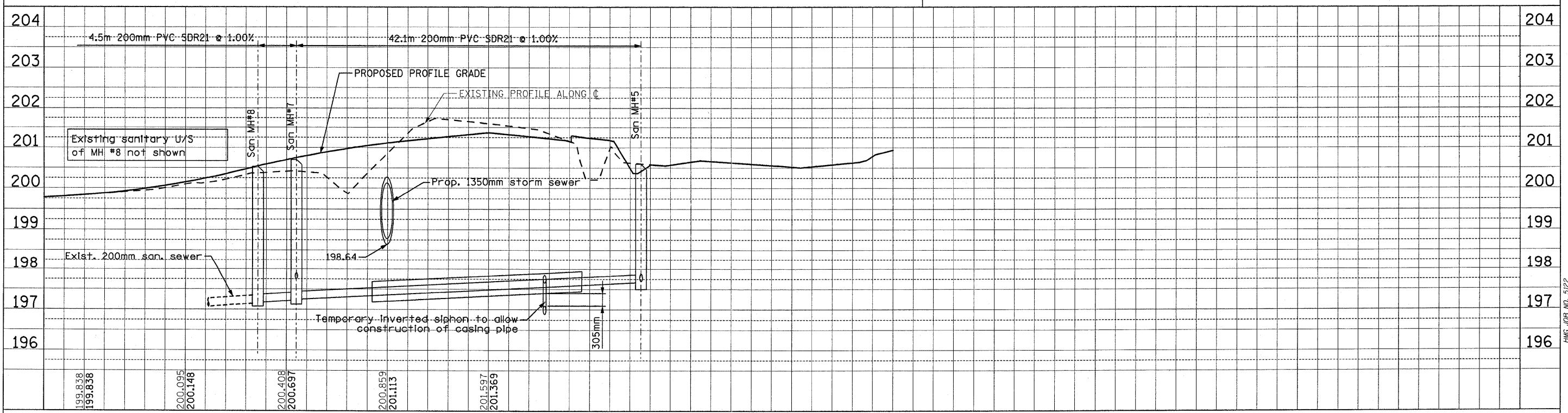
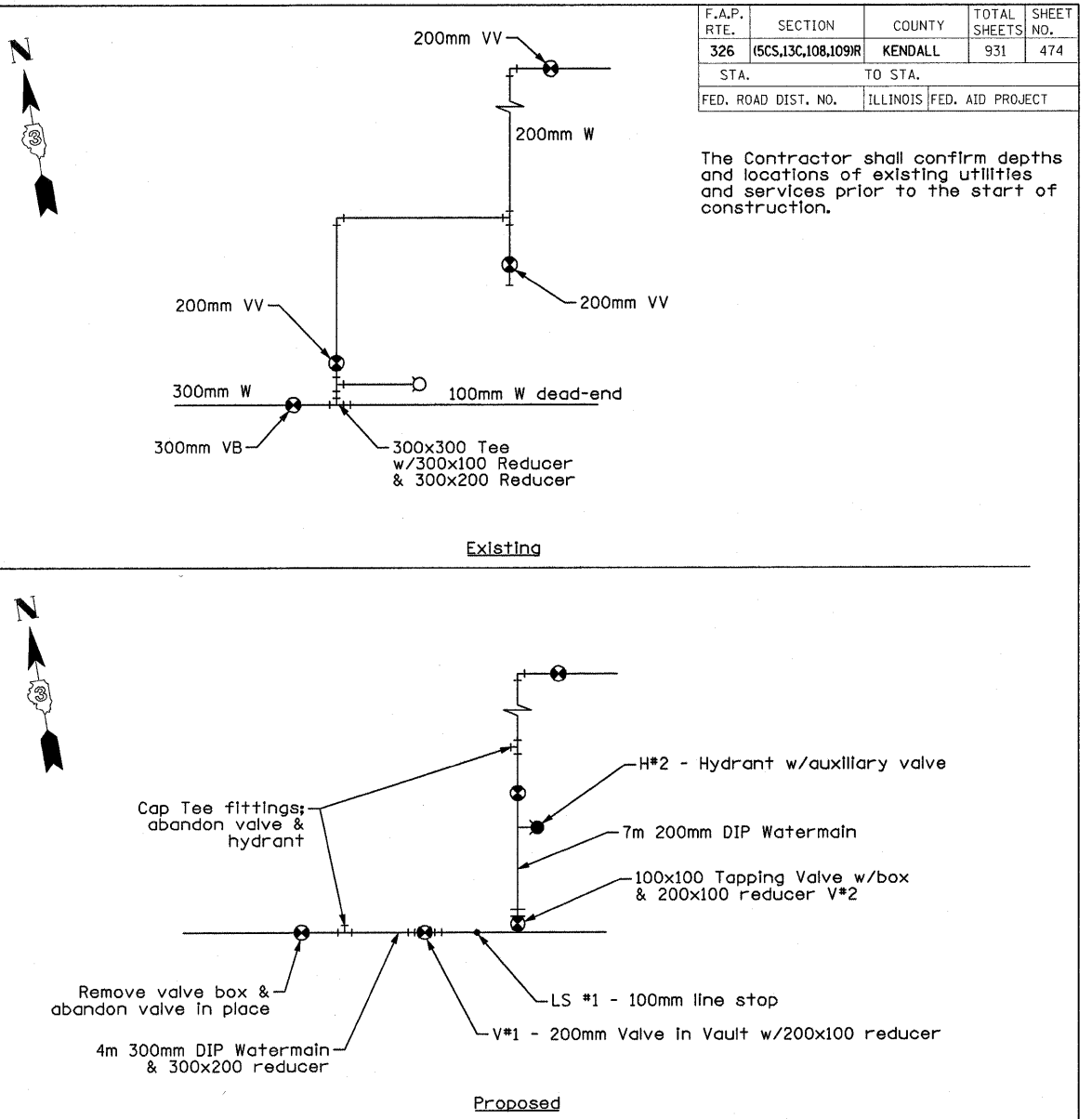
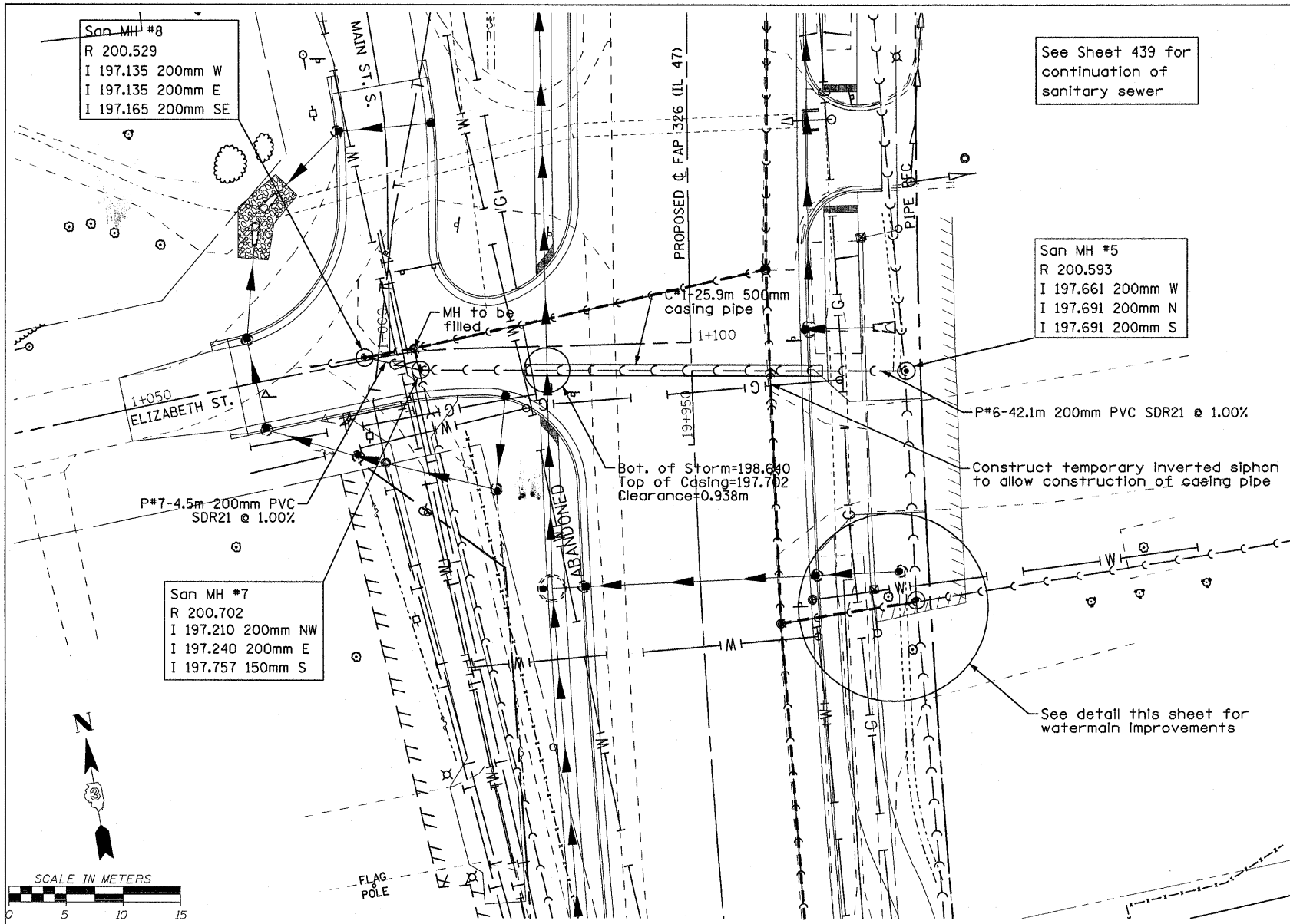

FILE: 47448\Sppl\Elizabeth.dgn  
PLOTTED: 8/22/2011

HMG JOB NO. 5122