

| | | | | |
|---------------------|---------------------------|---------|--------------|-----------|
| F.A.P. RTE. | SECTION | COUNTY | TOTAL SHEETS | SHEET NO. |
| 326 | (SCS,13C,108,109)R | KENDALL | 931 | 529 |
| STA. | TO STA. | | | |
| FED. ROAD DIST. NO. | ILLINOIS FED. AID PROJECT | | | |

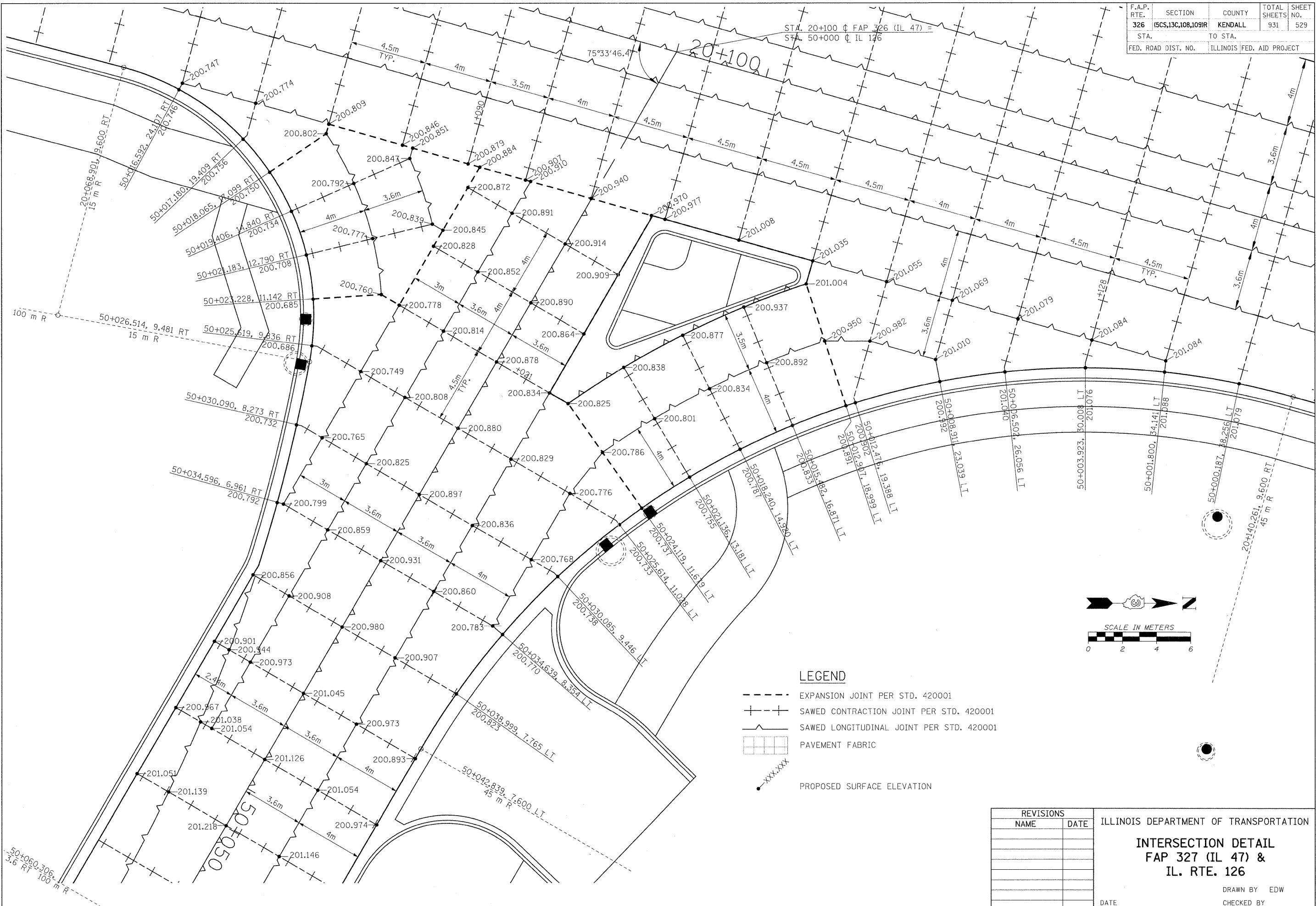

- LEGEND**
- EXPANSION JOINT PER STD. 420001
 - + + + SAWED CONTRACTION JOINT PER STD. 420001
 - SAWED LONGITUDINAL JOINT PER STD. 420001
 - ▭ PAVEMENT FABRIC
 - XXX.XXX PROPOSED SURFACE ELEVATION

| REVISIONS | |
|-----------|------|
| NAME | DATE |
| | |
| | |
| | |
| | |
| | |

ILLINOIS DEPARTMENT OF TRANSPORTATION

INTERSECTION DETAIL
FAP 327 (IL 47) &
IL. RTE. 126

DATE _____ DRAWN BY EDW
 CHECKED BY _____

FILE: 5291D_IL126.dgn
 PLOTTED: 8/11/2011

HMG JOB NO. 5122