

F.A.P. RTE.	SECTION	COUNTY	TOTAL SHEETS	SHEET NO.
326		KENDALL	931	633
STA. 21+075.00 TO STA. 21+775.00				
FED. ROAD DIST. NO. 5 ILLINOIS FED. AID PROJECT				
*5CS, 13C, 108, 109R				

**SIGNAL INTERCONNECT LEGEND**

- |     |                                     |  |                          |
|-----|-------------------------------------|--|--------------------------|
|     | PR. HANDHOLE                        |  | EXISTING HANDHOLE        |
|     | PR. DOUBLE HANDHOLE                 |  | EXISTING DOUBLE HANDHOLE |
|     | PR. CONTROLLER                      |  | EXISTING CONTROLLER      |
|     | PR. CONDUIT: "T" TRENCH, "P" PUSHED |  | EXISTING CONDUIT         |
| "S" | "S" SYSTEM                          |  |                          |
| "I" | "I" INTERSECTION                    |  |                          |
|     | PR. JUNCTION                        |  |                          |

MATCH LINE STA. 21+075.00

FOX RIVER BRIDGE

21+100      21+150      21+200      21+250      21+300      21+350      21+400

IL. ROUTE 47 (BRIDGE ST.)

MATCH LINE STA. 21+425.00

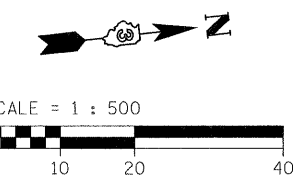
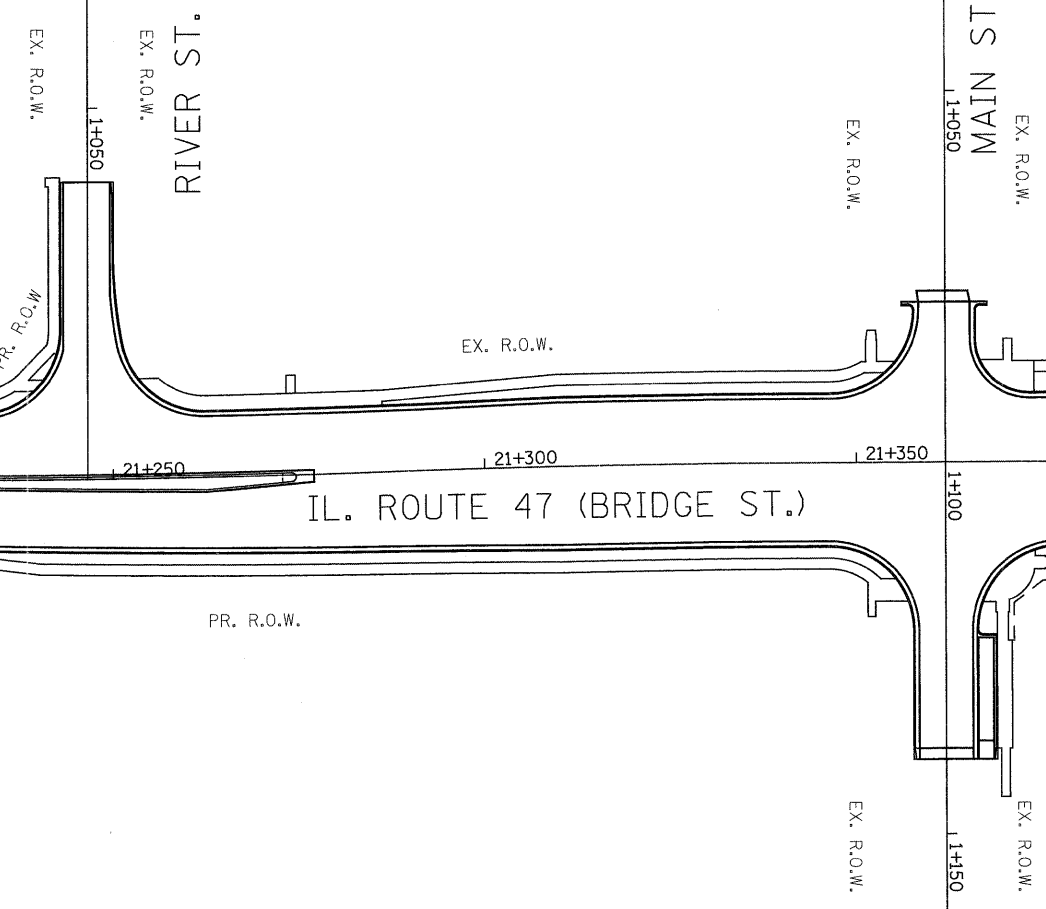

MATCH LINE STA. 21+425.00

CENTER ST.

21+450      21+500      21+550      21+600      21+650      21+700      21+750

IL. ROUTE 47 (BRIDGE ST.)

MATCH LINE STA. 21+775.00

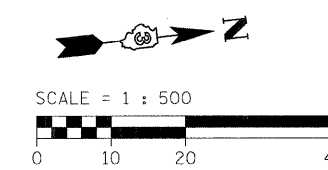
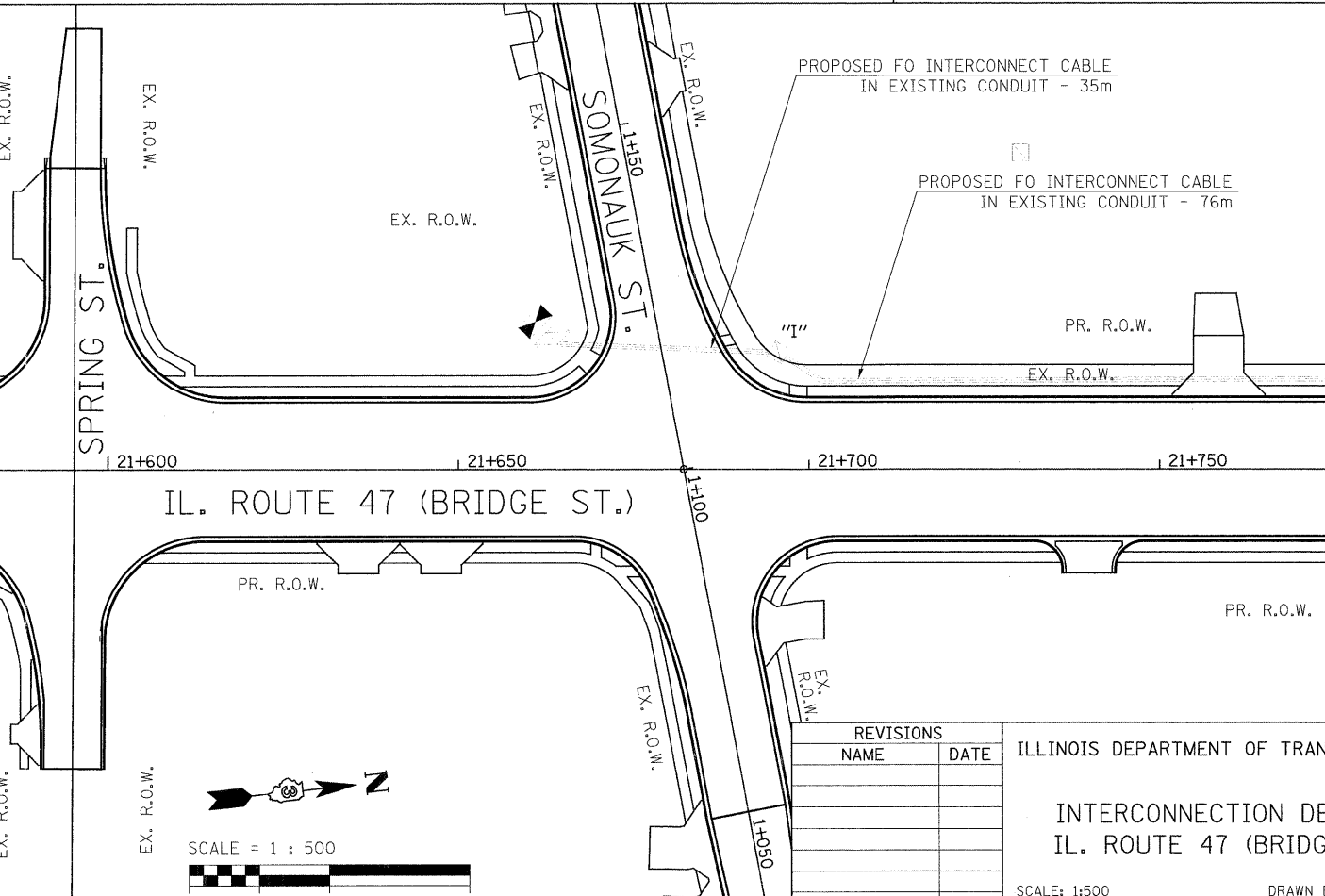

REVISIONS	
NAME	DATE

ILLINOIS DEPARTMENT OF TRANSPORTATION

**INTERCONNECTION DETAILS  
IL. ROUTE 47 (BRIDGE ST.)**

SCALE: 1:500      DRAWN BY: JH  
DATE: SEPTEMBER, 2005      CHECKED BY: KC