

F.A.P. RTE.	SECTION	COUNTY	TOTAL SHEETS	SHEET NO.
326	*	KENDALL	931	634
STA. 21+775.00		TO STA. 22+475.00		
FED. ROAD DIST. NO. 5		ILLINOIS FED. AID PROJECT		

*(5CS, 13C, 108, 109)R

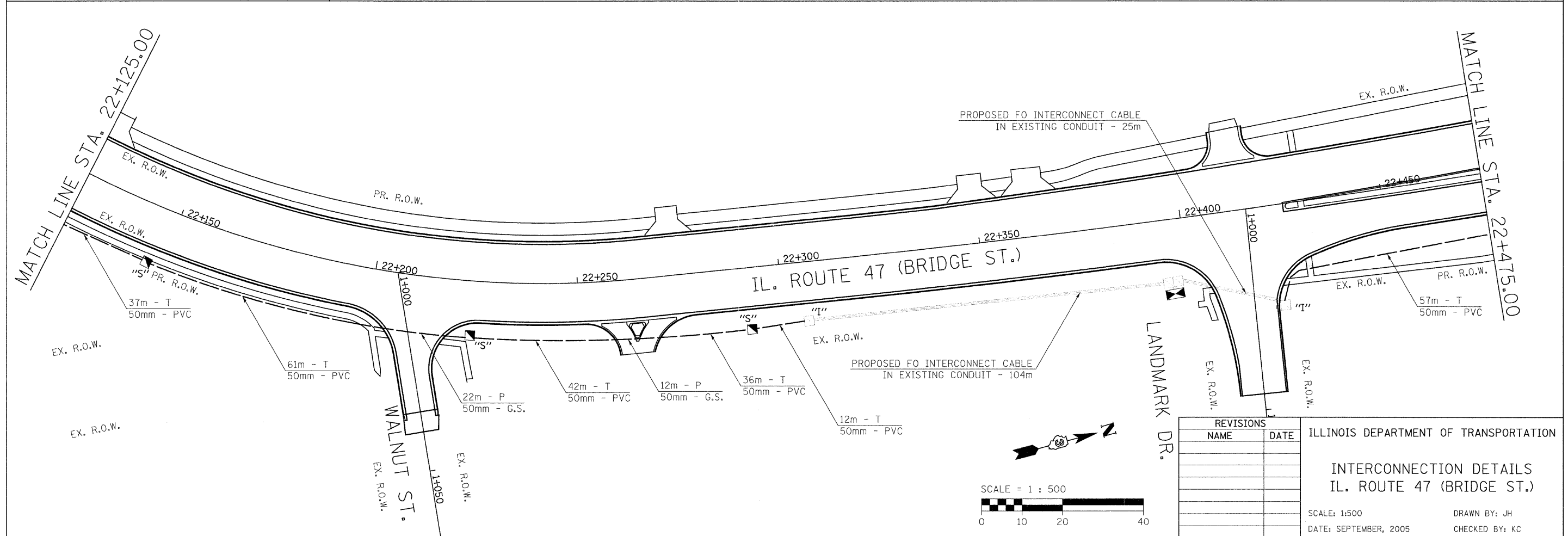
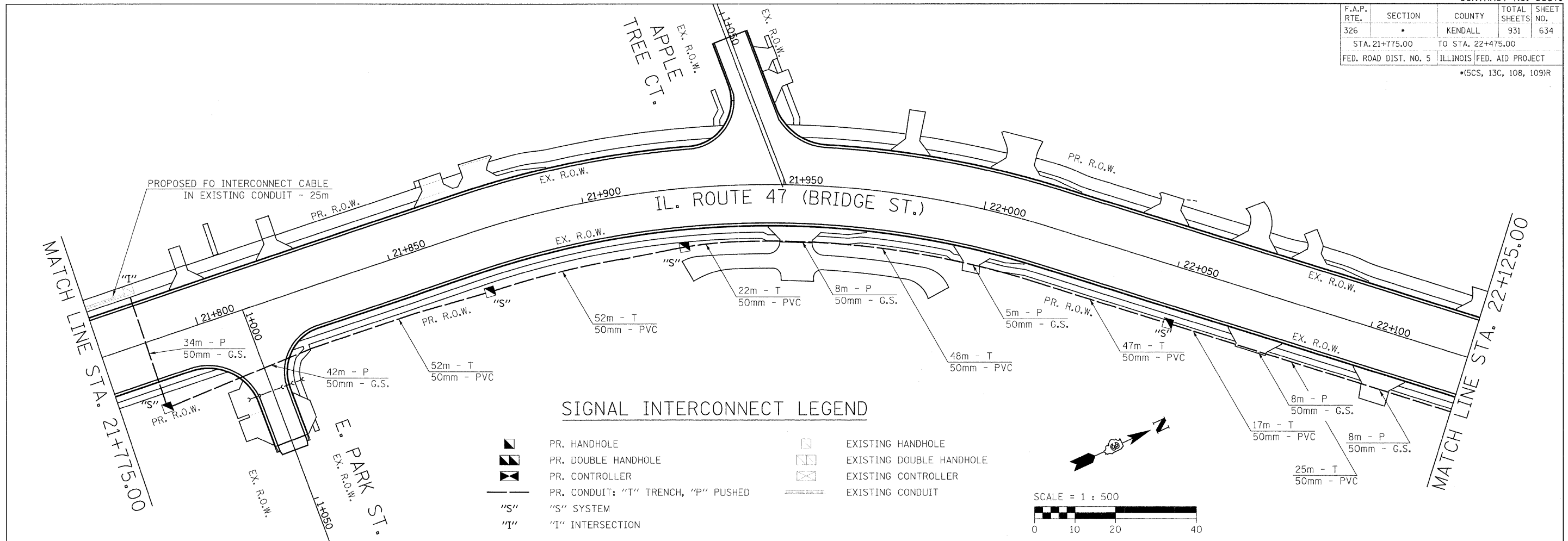

REVISIONS	
NAME	DATE

ILLINOIS DEPARTMENT OF TRANSPORTATION

**INTERCONNECTION DETAILS
IL. ROUTE 47 (BRIDGE ST.)**

SCALE: 1:500
DATE: SEPTEMBER, 2005

DRAWN BY: JH
CHECKED BY: KC