

F.A.P. RTE.	SECTION	COUNTY	TOTAL SHEETS	SHEET NO.
326	(SCS,13C,108,109)R	KENDALL	931	712
STA. 19+090.000		TO STA. 19+120.000		
FED. ROAD DIST. NO.		ILLINOIS FED. AID PROJECT		

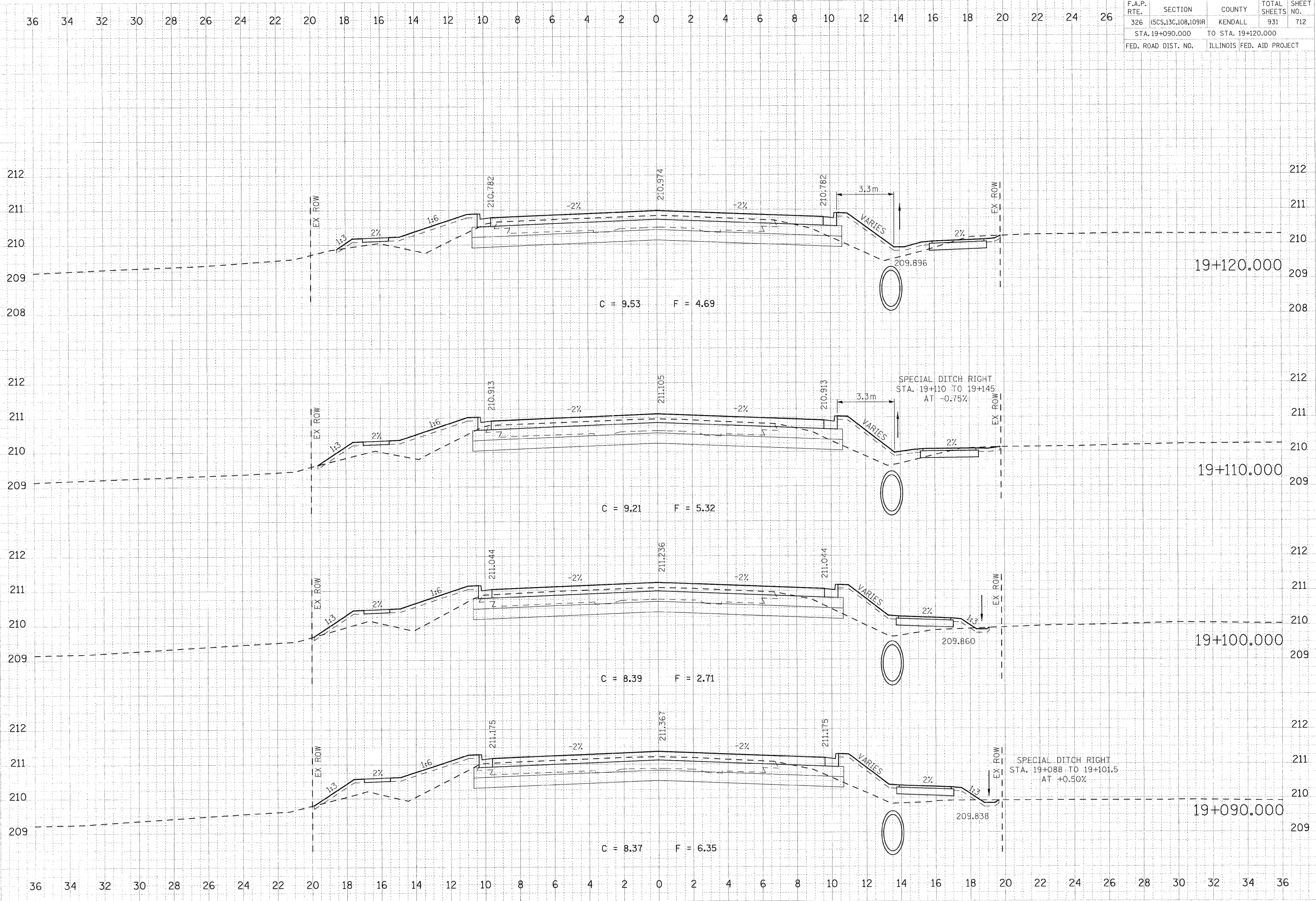

FINAL SURVEY  
 SURVEYED  
 PLOTTED  
 NOTED BOOF  
 TYPED  
 AREAS  
 CHECKED

ORIGINAL SURVEY  
 SURVEYED  
 PLOTTED  
 NOTED BOOF  
 TYPED  
 AREAS  
 CHECKED

PLOT DATE = 07/26/2011  
 FILE NAME = 613782XS.svd\_47s.dgn  
 USER NAME = JUSEDESOR