

F.A.P. RTE.	SECTION	COUNTY	TOTAL SHEETS	SHEET NO.
326	(SCS,13C,108,109)R	KENDALL	931	739
STA. 20+020.000		TO STA. 20+050.000		
FED. ROAD DIST. NO.		ILLINOIS FED. AID PROJECT		

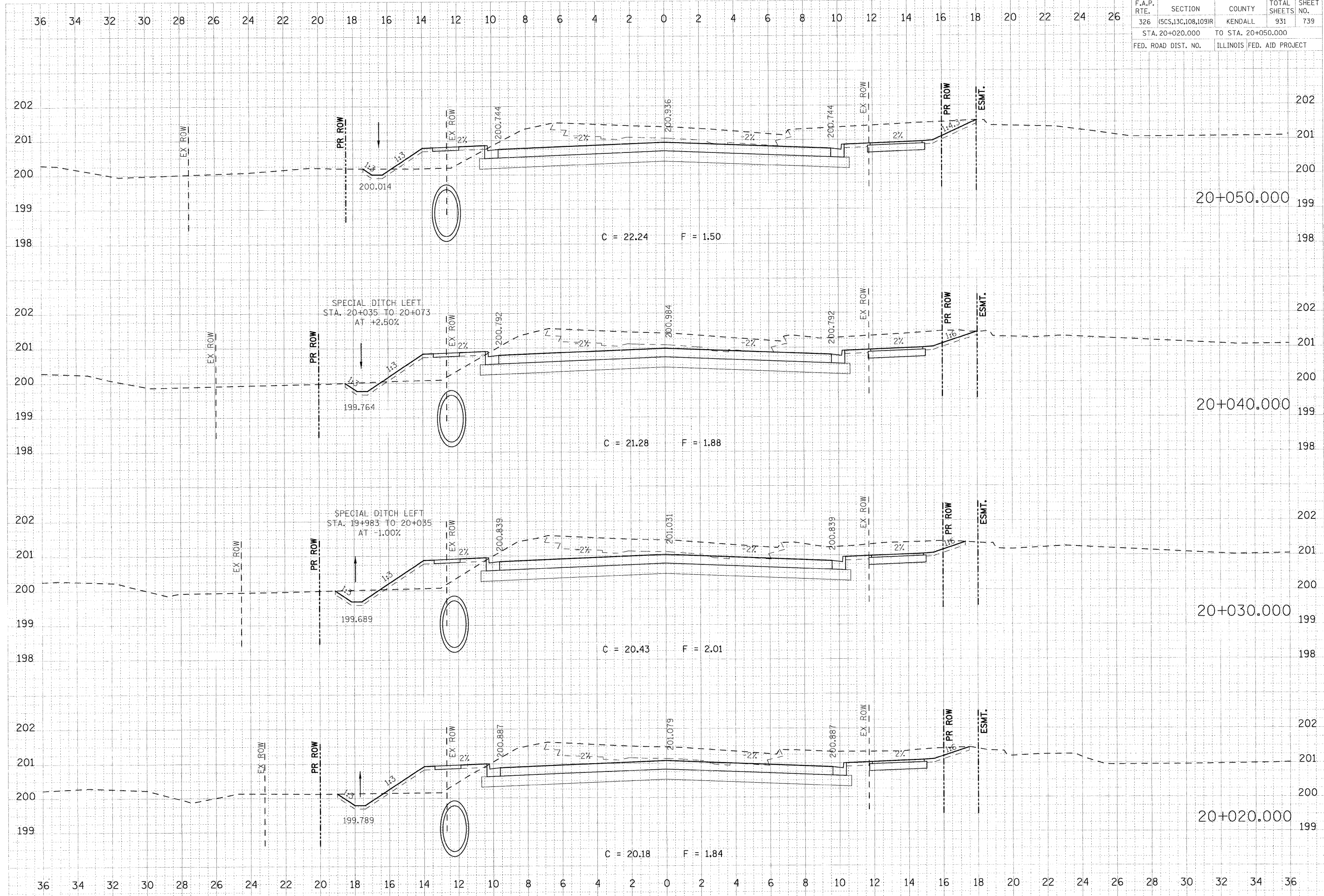

FINAL SURVEY PLANNED DATE: \_\_\_\_\_  
 NOTE BOOK: \_\_\_\_\_  
 NO. \_\_\_\_\_

ORIGINAL SURVEY DATE: \_\_\_\_\_  
 NOTE BOOK: \_\_\_\_\_  
 NO. \_\_\_\_\_

PLOT DATE = 07/26/2011  
 FILE NAME = 603782X6.dwg  
 USER NAME = JUSERESOR