

F.A.P. RTE.	SECTION	COUNTY	TOTAL SHEETS	SHEET NO.
326	(5CS,13C,108,109)R	KENDALL	931	748
STA. 20+290.000		TO STA. 20+320.000		
FED. ROAD DIST. NO.		ILLINOIS FED. AID PROJECT		

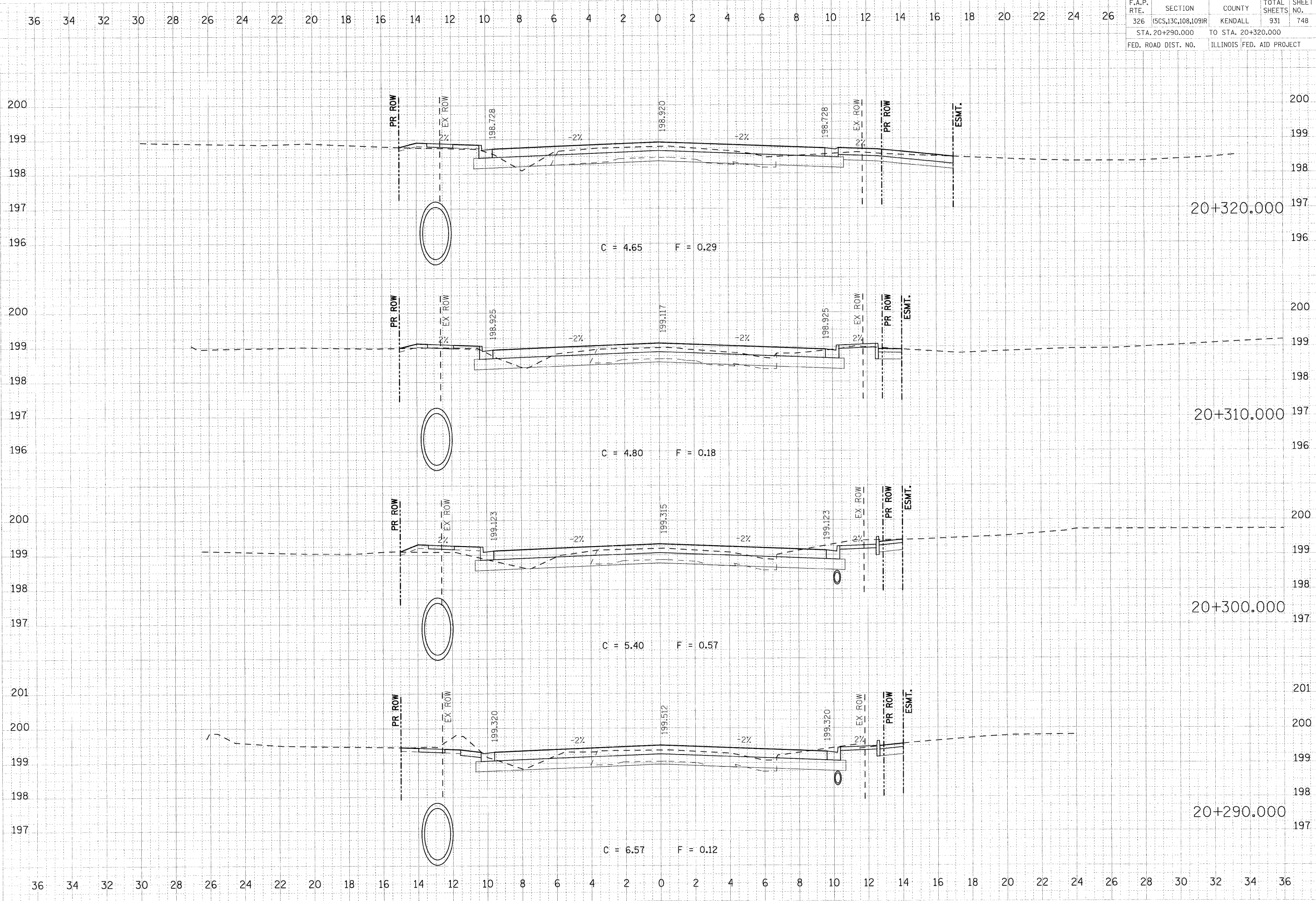

FINAL
 SURVEYED
 DATE

ORIGINAL
 SURVEYED
 DATE

PLOT DATE = 07/26/2011
 FILE NAME = 693-782XS.shxf_47a.dgn
 PLOT SCALE = 0.1000 m / MM.
 USER NAME = -USERDESCR