

F.A.P. RTE.	SECTION	COUNTY	TOTAL SHEETS	SHEET NO.
326	(5CS,13C,10B,1091R)	KENDALL	931	848
STA. 22+830.000		TO STA. 22+850.000		
FED. ROAD DIST. NO.		ILLINOIS FED. AID PROJECT		

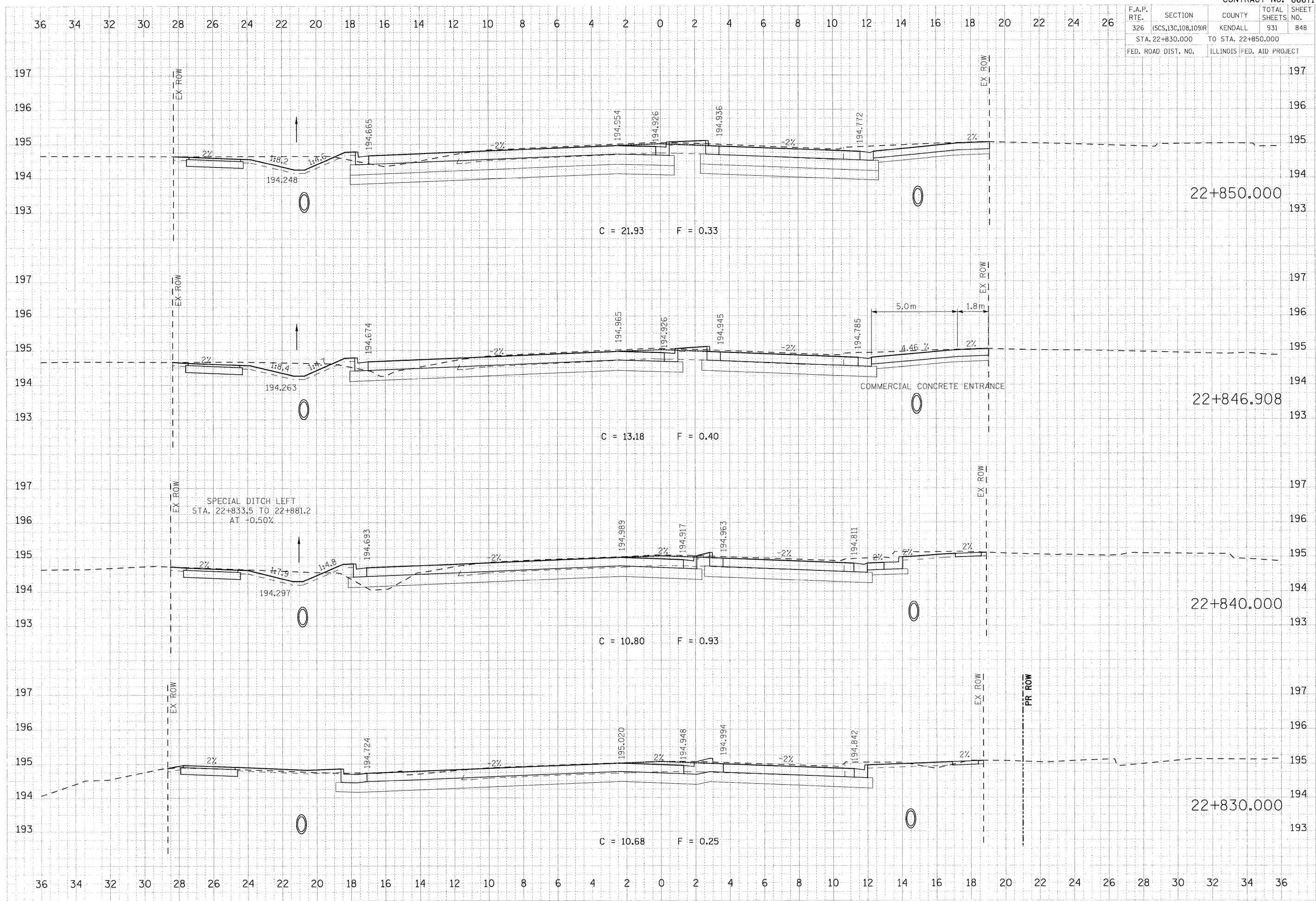

DATE	BY

DATE	BY

PLOT DATE = 07/26/2011
 FILE NAME = 936-9785.dwg
 PLOT SCALE = 0.1000 m/mm
 USER NAME = JUSERDESCR